



# Saline County Board of Commissioners

## Meeting Agenda

---

---

### AGENDA

#### SALINE COUNTY BOARD OF COMMISSIONERS

#### SALINE COUNTY COURTHOUSE

#### Wilber, NE

#### 9:30 AM

#### **DATE: February 14, 2023**

This agenda is kept on a daily basis and may change from day to day as requests come in to the County Clerk's office. Requests to be on the agenda must be in the County Clerk's office 24 hours prior to the start of the meeting as stated above. This agenda is considered current on the day of the meeting and cannot be changed or altered except for an emergency.

**The Board reserves the right to go into executive session if such session is clearly necessary for the protection of the public interest or for the prevention of needless injury to the reputation of an individual.**

#### **ROLL CALL**

#### **APPROVAL OF AGENDA**

#### **APPROVAL OF MINUTES OF THE PREVIOUS MEETING**

#### **CITIZENS FORUM**

#### **CORRESPONDENCE**

#### **REPORT OF OFFICIALS**

#### **BUSINESS FOR ACTION**

9:45 - Discuss/Approve the appointment of Gary Baxa to the Saline County Extension Board

Discuss/Approve final allocation of available ARPA funds

Discuss/Approve the January 2023 County Clerk Fees - \$34,063.25

Discuss/Approve the January 2023 Clerk of the District Court Fees - \$15,132.75

Discuss/Approve the January 2023 Sheriff Fees - \$2,208.69

#### **RESOLUTIONS TO TRANSFER FUNDS**

Discuss/Approve Resolution #2023-10 transferring \$1,600.00 from the Inheritance Fund to the Juvenile Services Aid Program, to be reimbursed when funds become available.

#### **HIGHWAY SUPERINTENDENT - ROAD AND BRIDGE MATTERS**

11:00 am **Public Hearing** regarding One & Six Year Plan.

Discuss and approve/disapprove One & Six year plan. Proposed plan can be viewed in the Saline County Clerk's Office from February 7th through February 14th.

Discuss and approve/disapprove Resolution 2023-08 for signing and Project program agreement BL2343 (Saline/Jefferson) for County Bridge Match Program STWD-CBMP (7).

Discuss and approve/disapprove Resolution 2023-09 for signing and Project program agreement BL2345 (Saline/Gage) for County Bridge Match Program STWD-CBMP (7).

Discuss and approve/disapprove Request to Occupy Right of Way from Windstream Nebraska LLC. Work Order #71503003000021; PR-12133.

Discuss and approve/disapprove Unite Private Networks request to occupy right of way NE4 27-8-4 on West side of Boswell Avenue.

Discuss and approve/disapprove Windstream Nebraska LLC request to occupy right of way WO#15000060630154; PR-12158.

**CLAIMS APPROVAL**

**11:30 COUNTY GENERAL ASSISTANCE AND CLOSED SESSION MATTERS**

Personnel Issue

Request for catastrophic leave

Law Enforcement Visit/Inspection

**ADJOURNMENT**

SALINE COUNTY BOARD OF COMMISSIONERS

The regular meeting of the Saline County Board of Commissioners was called to order at 9:33 a.m. on Tuesday, January 31, 2023, by Chairperson Phil Hardenburger. Present were Hardenburger, Russ Karpisek, Marvin A. Kohout, Janet J. Henning and Stephanie A. Krivohlavek Commissioners, County Clerk Anita K. Bartels and County Attorney David C. Solheim.

Notice of said meeting was posted in the County Clerk's Office and published in all three county newspapers on January 25, 2023, in compliance with State Statutes.

Hardenburger advised those present of the open meetings act posted at the back of the room and that all proceedings are electronically recorded.

Karpisek moved to approve the agenda, seconded by Kohout. Voting aye were Henning, Karpisek, Kohout, Krivohlavek and Hardenburger, nays none, motion carried.

Henning moved to approve the minutes of the January 17, 2023 meeting, seconded by Kohout. Voting aye were Karpisek, Kohout, Krivohlavek, Hardenburger and Henning, nays none, motion carried.

Under Correspondence, Bartels reported receiving from Continuum EAP the Mid-Year Service Summary, from SENDD the agenda for their January 26, 2023 meeting and from Blue Valley Community Action the agenda for their January 17, 2023 meeting, the November 15, 2022 minutes and the September 2022-November 2022 News Clippings.

Under Report of Officials, Henning reported on meetings with the Public Health Solutions and speaking to the Grass Roots Leadership Group at the Crete High School.

Kohout reported on meetings with Planning and Zoning, NACO Officers and Board, NACO Legislative positions, Employee Wellness Committee, Mutual Aid, Hometown Housing, Safety Committee, the Employee Health Fair on February 21 and 22, 2023 and the Employee Recognition Banquet on April 14, 2023.

Krivohlavek reported on meetings with the Veteran Services Committee, Saline County Aging Service, County Government Day on March 8, 2023 and the 5<sup>th</sup> Annual Shamrock Shuffle on March 18, 2023.

Karpisek reported on meetings with the Employee Wellness Committee, County Broadband with SENDD and a road concern with the Roads Department.

Hardenburger reported on meetings with Blue Valley Community Action, Jefferson County Board of Commissioners, Saline County Extension Board, Grass Roots Leadership Group at the Crete High School and Hometown Housing.

Planning & Zoning Administrator Lyle Weber and Brian Kohout presented for approval a minor subdivision at NE ¼ of 14-7-2 (1200 & I Road). Henning moved to approve, seconded by Kohout. Voting aye were Kohout, Krivohlavek, Hardenburger, Henning and Karpisek, nays none, motion carried.

County Assessor Brandi Kelly reported the Assessor's office is losing support for their CAMA system and will be replacing it with a new vendor. She is currently looking at MIPS and Vanguard programs, noting her office will be visiting Fillmore and Seward counties to observe how these programs work.

Henning moved to approve Resolution #2023-07, New Pledged Collateral from City Bank & Trust, par value \$500,000.00, CUSIP#912828T26, seconded by Krivohlavek. Voting aye were Hardenburger, Henning, Karpisek, Kohout and Krivohlavek.

Henning moved to approve Resolution #2023-06, Release of Pledged Collateral from City Bank & Trust, par value \$250,000.00, CUSIP #912828ZL7, seconded by Kohout. Voting aye were Krivohlavek, Hardenburger, Henning, Karpisek and Kohout, nays none, motion carried.

Karpisek moved to approve the 2023 Union Contract, seconded by Krivohlavek. Voting aye were Henning, Karpisek, Kohout, Krivohlavek, and Hardenburger, nays none, motion carried.

Discussion was held to establish a uniform policy for the expenditure of public funds, for items of value awarded to elected or appointed officials, employees or volunteers, including persons serving on local government boards or commissioners. No action will be taken.

Kohout moved to approve the Interlocal Agreements with Jefferson County for Emergency Management and Weeds, seconded by Krivohlavek. Voting aye were Karpisek, Kohout, Krivohlavek, Hardenburger and Henning, nays none, motion carried.

At 10:27 a.m. Hardenburger announced the Board would recess;

At 10:40 a.m. Hardenburger announced the Board would reconvene;

Henning moved to approve the Subaward agreement including any addendum and attachments entered into with the City of Lincoln and Saline County to provide ARPA funding to be used for services that meet the requirements of the Older Americans Act, seconded by Karpisek. Voting aye were Kohout, Krivohlavek, Hardenburger, Henning and Karpisek, nays none, motion carried.

Solheim informed the Board, the Court systems are moving away from paper based offices, to an online Electronic Case Management System which is cloud based. There are currently funds available in Fund 0985 which can be used to cover the cost of the initial setup, add another workstation in the County Attorney’s office and perform other needed technical upgrades.

Highway Superintendent Bruce Filipi, presented for approval a proposal from Speece Lewis Engineering for engineering fees for Box Culvert Structure C007614310P, in the amount of \$15,250.00. Krivohlavek moved to approve, seconded by Karpisek. Voting aye were Krivohlavek, Hardenburger, Henning, Karpisek and Kohout, nays none, motion carried.

Filipi presented for approval a proposal from Speece Lewis Engineering for engineering fees for Box Culvert Structure C007602625, in the amount of \$15,250.00. Henning moved to approve, seconded by Krivohlavek. Voting aye were Hardenburger, Henning, Karpisek, Kohout and Krivohlavek, nay none, motion carried.

Filipi presented for approval a proposal from Speece Lewis Engineering for engineering fees for Culvert Structure C007601803, in the amount of \$16,950.00. Krivohlavek moved to approve, seconded by Kohout. Voting aye were Henning, Karpisek, Kohout, Krivohlavek and Hardenburger, nays none, motion carried.

Filipi presented for approval a Request to Occupy County Right-of-Way submitted by Nextlink to bore under the road at 1400-1424 County Road X. Henning moved to approve, seconded by Krivohlavek. Voting aye were Karpisek, Kohout, Krivohlavek, Hardenburger and Henning, nays none, motion carried.

Filipi requested approval to purchase a semi tractor, by piggybacking on a bid with Otoe County. The semi tractor would be built in 2024, estimated cost is \$162,904.00. The current semi tractor is a 1996. Henning moved to approve, seconded by Karpisek. Voting aye were Kohout, Krivohlavek, Hardenburger, Henning and Karpisek, nays none, motion carried.

Filipi reported Tire Cleanup at Saline Center will be June 23, 24 and 25, 2023, paid for by a grant from the DEQ.

Filipi reported on various road projects.

Henning moved to approve the claims as presented, seconded by Krivohlavek. Voting aye were Krivohlavek, Hardenburger, Henning, Karpisek and Kohout, nays none, motion carried.

**GENERAL FUND**

General Fund Payroll & Taxes	Salary & Taxes	192,980.37
Americinn	Training	256.24
Rebecca Anderson	Attorney Fees	2,850.00
Anytime Plumbing	Building Maint	409.24
Anytime Plumbing	Building Maint	127.80
Auto Repair Plus	Equipment Rpr	288.46
Lyle Bartels	Mileage	31.44
Blue 360 Media	Office Supplies	177.94
CAMC	Contract	350.00
Dollar General	Supplies	100.75
Eakes Office Plus	Supplies	942.73
Electronic Contracting Company	Building Maint	1,010.16
Equifax Workforce Solutions	Contract	213.90
First Concord	Insurance	400.00
First Concord	Insurance	5,840.00
Food Mesto	Supplies	9.98
Friend Community Healthcare System	Contract	365.00
Goodwin Tucker	Contract	1,403.65
Scott Gropp	Attorney Fees	6,666.67
Philip Hardenburger	Mileage	28.82

Bernard Hoesche	Mileage	13.62
The Home Depot Pro	Supplies	365.79
Zac Keating	Contract	244.00
Lee's Refrigeration	Building Maint	273.20
Ingrid Lindal	Mileage	69.17
Mallory Safety	Supplies	458.63
Maverick Industries	Supplies	150.00
Menards Lincoln	Supplies	379.60
Midwest Card & Id Solutions	Supplies	781.00
Midwest Court Reporting	Contract	408.95
Joseph Murray	Attorney Fees	350.00
Nebraska Dept of Labor	Unemp	200.00
Nebraska Dept of Motor Vehicles	Plates	57.40
Nebraska Emergency Svc Comm Assn	Membership	105.00
Nebraska Health & Human Svcs System	Contract	57.00
Nebraska Notary Division	Notary	30.00
Quadient	Supplies	400.90
Regalia Manufacturing	Supplies	89.37
Sack Lumber	Supplies	28.36
Sack Lumber	Supplies	43.64
Saline County Attorney	Reimburse	44.41
Saline County Extension	Reimburse	78.69
Saline County Extension	Reimburse	160.25
Saline County Register of Deeds	Filing	32.00
Seward County Independent	Print & Publish	38.26
Soarin Group	Contract	1,497.00
Debbie Spanyers	Notary	156.18
State of NE	Contract	56.88
Alan Strouf	Mileage	16.70
Summit	Supplies	15,288.52
Us Bank	Contract	402.79
Becky Vales	Mileage	116.07
Verizon	Communication	2,088.06
Verizon	Communication	119.96
Visa	Travel	34.41
Visa	Equipment Sup	35.80
Visa	Postage	739.20
Visa	Fuel	67.93
Visa	Postage	7.85
Visa	Building	
Visa	Supplies	1,119.12
Visa	Travel	9.82
Visa	Fuel	32.26
Visa	Uniform	442.56
Visa	Dues	270.27
Visa	Supplies	362.54
Walker	Building Maint	62.34
Windstream	Communication	932.05
Cindy Wollenburg	Reimburse	50.00
Yankee Hill Veterinary Hospital	Services	116.87
<b>ROAD FUND</b>		
Road Fund Payroll & Taxes	Salary & Taxes	44,597.85
Beatrice Concrete	Gravel	2,704.14
City of Friend	Utilities	395.72
CAMC	Contract	144.00
Hydraulic Equipment Service	Supplies	652.01
Mid Country Machinery	Supplies	372.89

Orschelns Card Services	Supplies	12.99
Cnh Industrial	Supplies	1,074.51
Scherbarth Ace	Supplies	6.18
Speece-Lewis	Engineer Fees	19,007.50
Village of Dewitt	Utilities	75.62
Village of Swanton	Utilities	65.31
<b>BAILIFF FUND</b>		
Bailiff Fund Payroll & Taxes	Salary & Taxes	1,654.83
<b>VISITOR'S PROMOTION FUND</b>		
Crete Chamber of Commerce	Reimburse	1,279.75
Dorchester Community Foundation	Reimburse	1,567.10
<b>WELLNESS FUND</b>		
Madonna Rehab Hosp	Contract	150.00
<b>AGING SERVICES FUND</b>		
Jessica Acosta	Program	750.00
Samantha Cosaert	Program	405.00
Marcia Emal	Program	127.50
Marcia Emal	Program	50.63
Hosanna Home Care In Nebraska	Program	160.00
K & G Body Shop	Equipment Rpr	355.00
Tia L Kreshel	Program	952.50
Delaney Mazza	Program	480.00
Miller Mailing Service	Postage	385.16
Darlene Pribyl	Program	135.00
Darlene Pribyl	Program	18.13
Michele Vana	Program	52.50
<b>DRUG COURT FUND</b>		
Amanda Fanning	Mileage	475.75
Kalkwarf & Smith	Attorney Fees	1,200.00
<b>JUVENILE SERVICES GRANT FUND</b>		
Anita Stougard	Program	1,065.00
<b>911 EMERGENCY MANAGEMENT FUND</b>		
Windstream	Communication	247.80
<b>911 WIRELESS SERVICE FUND</b>		
Windstream	Communication	1,108.60
<b>COMMISSARY FUND</b>		
Bob Barker Company	Supplies	417.14
JB I	Supplies	1,299.54
<b>ALL FUNDS</b>		
Ameritas Life	Retire	27,490.86
BC/BS	Hlth Ins	117,360.20
Principal Dental	Dental Ins	2,108.51
AFLAC	Ins	1,187.43
VSP	Eye Ins	478.19
Empower	Def Comp	2,217.00
First Concord	Café	1,810.62
Colonial Supp Ins	Ins	164.87
Madison Nat'l Life	Dis Ins	150.15
Teamsters	Dues	275.00
New York Life	Ins	95.64
Globe Life	Ins	239.78
Lancaster County Court	Garnish	204.20

At 11: 15 a.m. Henning moved to enter closed session, seconded by Krivohlavek to discuss personnel matters. Voting aye were Hardenburger, Henning, Karpisek, Kohout and Krivohlavek, nays none, motion carried.

At 12:14 p.m. Kohout moved to exit closed session, seconded by Krivohlavek. Voting aye were Henning, Karpisek, Kohout, Krivohlavek and Hardenburger, nays none, motion carried.

Hardenburger announced during closed session no action was taken.

There being no further business to come before the Board, the meeting was adjourned at 12:15 p.m. The next regular meeting will be on Tuesday, February 14, 2023 at 9:30 a.m. in the Saline County Commissioners' Room, Court House, Wilber, NE.

ATTEST:

Anita K. Bartels, County Clerk

Janet J. Henning

Stephanie A. Krivohlavek, Vice-Chairperson

Marvin A. Kohout

Phil Hardenburger, Chairperson

Russ Karpisek

\*\*\*\*\*

I, Anita K. Bartels, County Clerk in and for Saline County, do hereby certify that the minutes of the previous meeting held on January 17, 2022 were approved as presented.

Anita K. Bartels, County Clerk

Janet J. Henning

Stephanie A. Krivohlavek, Vice-Chairperson

Marvin A. Kohout

Phil Hardenburger, Chairperson

Russ Karpisek

# Saline County Clerk REPORT OF FEES

## January 2023

Photocopies & Handling Fees	\$	172.50
Emailing Fees	\$	27.00
Phone & Written Searches	\$	-
Certified Copies	\$	-
Maps	\$	-
Tax Liens (Federal & State)	\$	-
Marriage Licenses	\$	75.00
Election, voter registration lists, etc.	\$	-
Real Estate	\$	4,316.00
Documentary Stamp Tax	\$	29,472.75

**TOTAL**     \$     34,063.25

**Approved**

This 14th day of February, 2023

**County Board**

---

---

---

---

---

---

Saline County Board  
Monthly Fees/Fines Report  
From 01/01/2023 to 01/31/2023

Account Description	Total Amount
Petition	70.00
Automation Fee	96.00
Transcript of Lien	50.00
Probation Admn Enrollment Fee	30.00
NSC Education Fee	12.00
Dispute Resolution Fee	9.00
Indigent Defense Fee	36.00
Uniform Data Analysis Fee	12.00
PSC Supervision Fee	50.00
PSC Local Fee	20.00
PSC Substance Abuse Testing-St	5.00
Dissolution Fee	25.00
Parenting Act Fund	50.00
J.R.F.	90.00
Filing Fee-JRF	70.00
Civil Legal Services Fund	6.00
L.E.I.F.	12.00
Legal Aid/Services Fund	75.00
10% Bond Fee	350.00
Seal Cert/Auth Copies	3.00
Comp Rec/Records Management Fe	60.00
Photocopy Fees	11.50
Interest on Bank Account	19.30
Service Fees	50.00
Counsel-Discipline Cash Fund	75.00
Substance Abuse Testing Fees	10.00
Postage	251.95
Fines	50.00
Sup Ct Filing Fee	129.00
Spousal Support/Alimony	450.00
Property Settlement	500.00
Attorney Fees	100.00
Passport Processing Fee-County	2,345.00
Bindover Ten Percent Bond	6,750.00
Bond	3,150.00
Sup Ct Cost Bond	75.00
Holding Acct	35.00
Grand Total	15,132.75

State of Nebraska }  
Saline County } SS  
Filed in the County Clerk's  
office Saline County, Nebraska

JAN 31 2023

at \_\_\_\_\_ o'clock and \_\_\_\_\_ minute  
County Clerk

State of Nebraska }  
Saline County } SS  
Filed in the County Clerk's  
office Saline County, Nebraska

FEB 01 2023

at \_\_\_\_\_ o'clock and \_\_\_\_\_ minute  
County Clerk

**APPROVED**

This 20 Day of \_\_\_\_\_ 20

**COUNTY BOARD**

\_\_\_\_\_  
**Chairman**

\_\_\_\_\_  
\_\_\_\_\_  
\_\_\_\_\_  
\_\_\_\_\_

SALINE COUNTY DISTRICT COURT  
Cases Filed Report  
For the Month of January , 2023

Cases Filed	Prior Pending	New Filings	Reopened Cases	Disposed Cases	Current Pending	Appealed Cases	Assign Co. Judge
<b>Criminal</b>							
Felony - Filed	0	0	0	0	0	0	
Felony - Bindovers	58	1	3	3	59	0	
Miscellaneous	0	0	0	0	0	0	
Misdemeanor	0	0	0	0	0	0	
Appeals - Trial Court	0	0	0	0	0	0	
	-----	-----	-----	-----	-----	-----	
Total Criminal	58	1	3	3	59	0	
<b>Traffic</b>							
Appeals - Trial Court	0	0	0	0	0	0	
	-----	-----	-----	-----	-----	-----	
Total Traffic	0	0	0	0	0	0	
<b>Civil</b>							
Tort	3	0	0	0	3	0	
Contract	4	0	0	0	4	0	
Real Property	3	0	0	0	3	0	
Miscellaneous	7	2	0	2	7	1	
Condemnation	0	0	0	0	0	0	
Appeals - Admin Agency	0	0	0	0	0	0	
Appeals - Trial Court	0	0	0	0	0	0	
	-----	-----	-----	-----	-----	-----	
Total Civil	17	2	0	2	17	1	
<b>Domestic Relations</b>							
Marriage Dissolution	30	2	0	7	25	0	0
Support/Custody	13	1	0	4	10	0	0
Paternity	18	0	0	5	13	0	0
URESAs	0	0	0	0	0	0	0
Protection Orders	1	2	0	0	3	0	0
Miscellaneous	0	0	0	0	0	0	0
Appeals - Trial Court	0	0	0	0	0	0	0
	-----	-----	-----	-----	-----	-----	-----
Total Domestic Relations	62	5	0	16	51	0	0
<b>Estate</b>							
Appeals - Trial Court	0	0	0	0	0	0	
	-----	-----	-----	-----	-----	-----	
Total Estate	0	0	0	0	0	0	
	-----	-----	-----	-----	-----	-----	
<b>Subtotal</b>	<b>137</b>	<b>8</b>	<b>3</b>	<b>21</b>	<b>127</b>	<b>1</b>	
<b>Juvenile</b>							
Misdemeanor/Infraction	0	0	0	0	0	0	
Felony	0	0	0	0	0	0	
Neglected/Dependent	0	0	0	0	0	0	
Status Offender	0	0	0	0	0	0	
Mentally Ill and Dangerous	0	0	0	0	0	0	
Parental	0	0	0	0	0	0	
	-----	-----	-----	-----	-----	-----	
Total Juvenile	0	0	0	0	0	0	
	-----	-----	-----	-----	-----	-----	
<b>Total Cases Filed</b>	<b>137</b>	<b>8</b>	<b>3</b>	<b>21</b>	<b>127</b>	<b>1</b>	

Disposition	Appeals					Total
	Small Civil	Dom. Rel.	Probate	From Trial Court/Admin Agency		
Jury-Verdict Issued	0	0	0	0	0	0
Jury-Disposed Before Verdict	0	0	0	0	0	0
Tried to Court	0	0	4	0	0	4
Uncontested/Default	1	0	8	0	0	9
Dismissed by Party	1	0	1	0	0	2
Dismissed by Court	0	0	3	0	0	3
Suggestion of Bankruptcy	0	0	0	0	0	0
Transferred	0	0	0	0	0	0
Stipulation Agreement/Payment (CC O	0	0	0	0	0	0
<b>Total</b>	<b>2</b>	<b>0</b>	<b>16</b>	<b>0</b>	<b>0</b>	<b>18</b>

Disposition	Felony	Misdemeanor	Traffic	Juvenile	Appeals from Trial Court	Total
-----						
Jury Impaneled:						
a. Verdict Issued	0	0	0	0	0	0
b. Disposed Prior to Verdict	0	0	0	0	0	0
Tried to Court	0	0	0	0	0	0
Preliminary Hearing Held:						
a. Bound Over	0	0	0	0	0	0
b. Dismissed by Court	0	0	0	0	0	0
Preliminary Hearing Waived	0	0	0	0	0	0
Felony Reduced to Misdemeanor	0	0	0	0	0	0
Dismissed by Prosecutor	1	0	0	0	0	1
Dismissed by Court Prior to Trial	0	0	0	0	0	0
Transferred	0	0	0	0	0	0
Guilty Plea in Court	2	0	0	0	0	2
Guilty Plea by Waiver	0	0	0	0	0	0
-----						
Total Dispositions	3	0	0	0	0	3

FEB 03 2023

9:31 AM  
 02/07/23  
 Accrual Basis

**Saline Civil Account**  
**Transactions by Account**  
 As of January 31, 2023

at \_\_\_\_\_ o'clock and \_\_\_\_\_ minute  
 of \_\_\_\_\_ County, Nebraska

Type	Date	Num	Name	Memo	Split	Amount	Balance
<b>200 · Due to County Treasurer</b>							2,099.70
<b>201 · Writ Fees</b>							888.00
Invoice	01/01/2023	235-17	State	Writ Fees-Nicole...	120 · A/R	18.00	906.00
Invoice	01/01/2023	235-18	State	Writ Fees-Aubre...	120 · A/R	6.00	912.00
Invoice	01/01/2023	235-19	State	Writ Fees-Alexz...	120 · A/R	24.00	936.00
Invoice	01/01/2023	235-22	State	Writ Fees-Kaeli ...	120 · A/R	6.00	942.00
Check	01/02/2023	9950	Saline County Treasurer	Dec 2022 - Sher...	100 · Ca...	-888.00	54.00
Invoice	01/02/2023	235-20	Credit Management	Writ Fees-Lyly N...	120 · A/R	6.00	60.00
Invoice	01/02/2023	235-21	Credit Bureau Services, Inc	Writ Fees-Travis...	120 · A/R	27.00	87.00
Invoice	01/03/2023	235-23	Red Credit Solutions, LLC	Writ Fees-Rene ...	120 · A/R	18.00	105.00
Invoice	01/03/2023	234-86	Rausch Sturm LLP	Writ Fees-Ana L...	120 · A/R	6.00	111.00
Invoice	01/03/2023	235-34	Reagan, Melton & Delaney, LLP	Writ Fees-Carol ...	120 · A/R	18.00	129.00
Invoice	01/03/2023	235-24	AR Solutions Inc	Writ Fees-Carl ...	120 · A/R	27.00	156.00
Invoice	01/03/2023	235-52	Rausch Sturm LLP	Writ Fees-David ...	120 · A/R	18.00	174.00
Invoice	01/03/2023	235-30	Kalkwarf & Smith Law Offices, LLC	Writ Fees-Maso...	120 · A/R	18.00	192.00
Invoice	01/03/2023	235-25	State	Writ Fees-Marco...	120 · A/R	6.00	198.00
Invoice	01/03/2023	235-26	State	Writ Fees-Josep...	120 · A/R	18.00	216.00
Invoice	01/03/2023	235-28	State	Writ Fees-Nicole...	120 · A/R	18.00	234.00
Invoice	01/03/2023	235-31	State	Writ Fees-Miche...	120 · A/R	18.00	252.00
Invoice	01/04/2023	235-33	Collection Agency, LLC	Writ Fees-Anita ...	120 · A/R	18.00	270.00
Invoice	01/04/2023	235-29	State	Writ Fees-Leann...	120 · A/R	18.00	288.00
Invoice	01/05/2023	235-35	National Account Systems of Omaha, ...	Writ Fees-Shaw...	120 · A/R	18.00	306.00
Invoice	01/05/2023	235-32	General Service Bureau - Court Account	Writ Fees-Chas...	120 · A/R	18.00	324.00
Invoice	01/05/2023	235-27	Credit Bureau Services, Inc	Writ Fees-Karen...	120 · A/R	18.00	342.00
Invoice	01/06/2023	235-51	Messerli & Kramer PA	Writ Fees-Alejan...	120 · A/R	18.00	360.00
Invoice	01/09/2023	235-37	Collection Agency, LLC	Writ Fees-Erik R...	120 · A/R	18.00	378.00
Invoice	01/10/2023	235-47	SouthLaw, PC	Writ Fees-Amy ...	120 · A/R	18.00	396.00
Invoice	01/10/2023	235-36	Messerli & Kramer PA	Writ Fees-Gerar...	120 · A/R	18.00	414.00
Invoice	01/10/2023	235-38	Credit Bureau Services, Inc	Writ Fees-Ana D...	120 · A/R	18.00	432.00
Invoice	01/10/2023	235-39	James A Cada	Writ Fees-Aman...	120 · A/R	27.00	459.00
Invoice	01/10/2023	235-40	James A Cada	Writ Fees-Troy ...	120 · A/R	27.00	486.00
Invoice	01/10/2023	235-42	James A Cada	Writ Fees-Matt ...	120 · A/R	27.00	513.00
Invoice	01/11/2023	235-45	Morrow, Poppe, Watermeier & Lonow...	Writ Fees-Jame...	120 · A/R	18.00	531.00
Invoice	01/11/2023	235-44	State	Writ Fees-Keith ...	120 · A/R	27.00	558.00
Invoice	01/12/2023	235-48	Credit Management	Writ Fees-Kami ...	120 · A/R	18.00	576.00
Invoice	01/12/2023	235-49	Collection Agency, LLC	Writ Fees-Jame...	120 · A/R	27.00	603.00
Invoice	01/12/2023	235-46	James A Cada	Writ Fees-Migue...	120 · A/R	18.00	621.00
Invoice	01/16/2023	235-53	Rausch Sturm LLP	g Benton	120 · A/R	18.00	639.00
Invoice	01/16/2023	235-50	Messerli & Kramer PA	Writ Fees-Lynds...	120 · A/R	18.00	657.00
Invoice	01/17/2023	235-56	Credit Management	Writ Fees-Isabel...	120 · A/R	6.00	663.00
Invoice	01/17/2023	235-54	Credit Bureau Services, Inc	Writ Fees-Jodi ...	120 · A/R	18.00	681.00
Invoice	01/19/2023	235-57	Morrow, Poppe, Watermeier & Lonow...	Writ Fees-Joel A...	120 · A/R	18.00	699.00
Invoice	01/19/2023	235-58	Thomas & Thomas Court Reporters	Writ Fees-Sawy...	120 · A/R	54.00	753.00
Invoice	01/24/2023	235-59	James A Cada	Writ Fees-Veron...	120 · A/R	18.00	771.00

9:31 AM  
02/07/23  
Accrual Basis

**Saline Civil Account**  
**Transactions by Account**  
As of January 31, 2023

Type	Date	Num	Name	Memo	Split	Amount	Balance
Invoice	01/24/2023	235-60	James A Cada	Writ Fees-Travis...	120 · A/R	27.00	798.00
Invoice	01/24/2023	235-61	State	Writ Fees-Brand...	120 · A/R	6.00	804.00
Invoice	01/25/2023	235-62	Kalkwarf & Smith Law Offices, LLC	Writ Fees-Mangl...	120 · A/R	18.00	822.00
Invoice	01/26/2023	235-63	Credit Management	Writ Fees-Paige...	120 · A/R	18.00	840.00
Invoice	01/26/2023	235-64	Collection Agency, LLC	Writ Fees-Tina ...	120 · A/R	18.00	858.00
Invoice	01/30/2023	235-65	State	Writ Fees-Ivery ...	120 · A/R	27.00	885.00
Total 201 · Writ Fees						-3.00	885.00
<b>202 · Mileage</b>							646.70
Invoice	01/01/2023	235-17	State	Mileage-Nicole ...	120 · A/R	0.61	647.31
Invoice	01/01/2023	235-18	State	Mileage-Aubrey,...	120 · A/R	18.15	665.46
Invoice	01/01/2023	235-19	State	Mileage-Alexzan...	120 · A/R	16.34	681.80
Invoice	01/01/2023	235-22	State	Mileage-Kaelli Jo...	120 · A/R	0.00	681.80
Check	01/02/2023	9950	Saline County Treasurer	Dec 2022 - Sher...	100 · Ca...	-646.70	35.10
Invoice	01/02/2023	235-20	Credit Management	Mileage-Lyly Ng...	120 · A/R	14.52	49.62
Invoice	01/02/2023	235-21	Credit Bureau Services, Inc	Mileage-T/A Ke...	120 · A/R	21.18	70.80
Invoice	01/03/2023	235-23	Red Credit Solutions, LLC	Mileage-Rene P...	120 · A/R	13.92	84.72
Invoice	01/03/2023	234-86	Rausch Sturm LLP	Mileage-Ana La...	120 · A/R	23.60	108.32
Invoice	01/03/2023	235-34	Reagan, Melton & Delaney, LLP	Mileage-Carol Bl...	120 · A/R	0.61	108.93
Invoice	01/03/2023	235-24	AR Solutions Inc	Mileage-C/B Me...	120 · A/R	15.13	124.06
Invoice	01/03/2023	235-52	Rausch Sturm LLP	Mileage-David H...	120 · A/R	15.13	139.19
Invoice	01/03/2023	235-30	Kalkwarf & Smith Law Offices, LLC	Mileage-Mason ...	120 · A/R	21.18	160.37
Invoice	01/03/2023	235-25	State	Mileage-Marco J...	120 · A/R	16.34	176.71
Invoice	01/03/2023	235-26	State	Mileage-Joseph ...	120 · A/R	7.87	184.58
Invoice	01/03/2023	235-28	State	Mileage-Nicole ...	120 · A/R	94.00	278.58
Invoice	01/03/2023	235-31	State	Mileage-Michelle...	120 · A/R	0.61	279.19
Invoice	01/04/2023	235-33	Collection Agency, LLC	Mileage-Anita M...	120 · A/R	32.67	311.86
Invoice	01/04/2023	235-29	State	Mileage-Leanne ...	120 · A/R	59.00	370.86
Invoice	01/05/2023	235-35	National Account Systems of Omaha, ...	Mileage-Shawna...	120 · A/R	15.13	385.99
Invoice	01/05/2023	235-32	General Service Bureau - Court Account	Mileage-Chase ...	120 · A/R	13.92	399.91
Invoice	01/05/2023	235-27	Credit Bureau Services, Inc	Mileage-Karen B...	120 · A/R	13.92	413.83
Invoice	01/06/2023	235-51	Messerli & Kramer PA	Mileage-Alejandr...	120 · A/R	13.92	427.75
Invoice	01/09/2023	235-37	Collection Agency, LLC	Mileage-Erik Re...	120 · A/R	13.92	441.67
Invoice	01/10/2023	235-47	SouthLaw, PC	Mileage-Amy Ha...	120 · A/R	32.67	474.34
Invoice	01/10/2023	235-36	Messerli & Kramer PA	Mileage-Gerardo...	120 · A/R	24.81	499.15
Invoice	01/10/2023	235-38	Credit Bureau Services, Inc	Mileage-Ana Di...	120 · A/R	23.60	522.75
Invoice	01/10/2023	235-39	James A Cada	Mileage-A/W Wi...	120 · A/R	27.23	549.98
Invoice	01/10/2023	235-40	James A Cada	Mileage-T/C Miller	120 · A/R	0.61	550.59
Invoice	01/10/2023	235-42	James A Cada	Mileage-M/M Ko...	120 · A/R	0.61	551.20
Invoice	01/11/2023	235-45	Morrow, Poppe, Watermeier & Lonow...	Mileage-James ...	120 · A/R	14.52	565.72
Invoice	01/11/2023	235-44	State	Mileage-Keith K...	120 · A/R	23.60	589.32
Invoice	01/12/2023	235-48	Credit Management	Mileage-Kami Br...	120 · A/R	0.61	589.93
Invoice	01/12/2023	235-49	Collection Agency, LLC	Mileage-J/A King	120 · A/R	28.44	618.37
Invoice	01/12/2023	235-46	James A Cada	Mileage-Miguel ...	120 · A/R	16.94	635.31

9:31 AM  
02/07/23  
Accrual Basis

**Saline Civil Account**  
**Transactions by Account**  
As of January 31, 2023

Type	Date	Num	Name	Memo	Split	Amount	Balance	
Invoice	01/16/2023	235-53	Rausch Sturm LLP	Mileage-Craig B...	120 · A/R	31.46	666.77	
Invoice	01/16/2023	235-50	Messerli & Kramer PA	Mileage-Lyndse...	120 · A/R	14.52	681.29	
Invoice	01/17/2023	235-56	Credit Management	Mileage-Isabella...	120 · A/R	13.92	695.21	
Invoice	01/17/2023	235-54	Credit Bureau Services, Inc	Mileage-Jodi Re...	120 · A/R	0.61	695.82	
Invoice	01/19/2023	235-57	Morrow, Poppe, Watermeier & Lonow...	Mileage-Joel Ad...	120 · A/R	17.55	713.37	
Invoice	01/19/2023	235-58	Thomas & Thomas Court Reporters	Mileage-Sawyer ...	120 · A/R	23.61	736.98	
Invoice	01/24/2023	235-59	James A Cada	Mileage-Veronic...	120 · A/R	17.55	754.53	
Invoice	01/24/2023	235-60	James A Cada	Mileage-T/A Ke...	120 · A/R	19.97	774.50	
Invoice	01/24/2023	235-61	State	Mileage-Brando...	120 · A/R	13.92	788.42	
Invoice	01/25/2023	235-62	Kalkwarf & Smith Law Offices, LLC	Mileage-Manglo...	120 · A/R	13.92	802.34	
Invoice	01/26/2023	235-63	Credit Management	Mileage-Paige V...	120 · A/R	7.87	810.21	
Invoice	01/26/2023	235-64	Collection Agency, LLC	Mileage-Tina Gr...	120 · A/R	7.87	818.08	
Invoice	01/30/2023	235-65	State	Mileage-Ivory H...	120 · A/R	0.61	818.69	
Total 202 · Mileage						171.99	818.69	
<b>203 · Vehicle Inspections</b>							480.00	
General ...	01/02/2023	213			-SPLIT-	-480.00	0.00	
Sales Re...	01/31/2023	Jan 2023	Saline County Treasurer	Title Inspections...	160 · On...	410.00	410.00	
Total 203 · Vehicle Inspections						-70.00	410.00	
<b>204 · Gun Permits</b>							85.00	
General ...	01/02/2023	213			203 · Ve...	-85.00	0.00	
Sales Re...	01/31/2023	Jan 2023	Saline County Treasurer	Gun Permits 75...	160 · On...	95.00	95.00	
Total 204 · Gun Permits						10.00	95.00	
<b>208 · Miscellaneous</b>							0.00	
Total 208 · Miscellaneous							0.00	
Total 200 · Due to County Treasurer						108.99	2,208.69	
<b>TOTAL</b>						<b>108.99</b>	<b>2,208.69</b>	
\$ 885.00	Writ Fees							
818.69	Mileage							
410.00	Vehicle Inspections							
95.00	Gun Permits							
<u>\$ 2,208.69</u>								

**APPROVED**  
This 14 Day of February 20 23  
**COUNTY BOARD**

\_\_\_\_\_  
**Chairman**  
\_\_\_\_\_  
\_\_\_\_\_  
\_\_\_\_\_

RESOLUTION #2023-10

BE IT HEREBY RESOLVED, by the Board of Commissioners of Saline County, NE,  
that the sum of \$1,600.00 be transferred from the Inheritance Fund #2700 to the Juvenile  
Services Aid Program Fund #2516, to be reimbursed when funds are available.

Motion made by Commissioner \_\_\_\_\_, seconded by Commissioner  
\_\_\_\_\_, to adopt the foregoing Resolution. All members present  
voting as follows:

Yeas: \_\_\_\_\_

Nays: \_\_\_\_\_

Abstentions: \_\_\_\_\_

Absent: \_\_\_\_\_

\_\_\_\_\_  
Chairman  
\_\_\_\_\_  
\_\_\_\_\_  
\_\_\_\_\_  
\_\_\_\_\_

SUBSCRIBED AND SWORN TO before me this 14<sup>TH</sup> day of February, 2023

SEAL

\_\_\_\_\_  
Saline County Clerk

**COUNTY BRIDGE MATCH PROGRAM**  
**PROGRAM AGREEMENT**

SALINE COUNTY  
STATE OF NEBRASKA, DEPARTMENT OF TRANSPORTATION  
PROJECT NO. STWD-CBMP(7)  
STATE CONTROL NO. 00974F  
CBMP CONTROL NO. 00974F(b)  
COUNTY BRIDGE MATCH PROGRAM

THIS AGREEMENT is between **Saline County**, Nebraska hereinafter referred to as "County," and the State of Nebraska, Department of Transportation, hereinafter referred to as "State," and collectively referred to as the "Parties."

**WITNESSETH:**

**WHEREAS**, the Transportation Innovation Act established a new program called the County Bridge Match Program (CBMP), (Neb. Rev. Stat. § 39-2805), and

**WHEREAS**, the purpose of the CBMP is to promote innovative solutions and provide additional funding to accelerate the repair and replacement of deficient bridges on the county road system, and

**WHEREAS**, State has developed the program requirements for the CBMP and a project proposed by County has been selected to be funded by the CBMP, and

**WHEREAS**, County will be responsible for completing all phases of the project, however, State will reimburse County a designated share up to a maximum total dollar amount of County's actual and reasonable costs of only the bridge construction phase of the project, as further described herein, and

**WHEREAS**, for this project the State's designated share will be 55 percent of the bridge or culvert construction costs, with a maximum State contribution not to exceed **\$300,000.00**, as more specifically described below, and

**WHEREAS**, County's CBMP project(s) are described as follows:

**C007602615 – 4.2S 1.5W OF PLEASANT HILL AT DRY CREEK**  
**C007602625 – N JCT N16/N41 1N 6.2E AT BRUSH CREEK**

**WHEREAS**, funding for the CBMP sunsets on June 30, 2023; accordingly, the project must be completed by **December 31, 2026** in order to maximize the overall number of projects that can be funded as a part of the CBMP, and

**WHEREAS**, County has designated a point of contact, who will be known for this project as the Project Liaison (PL), and who will be in charge of all aspects of the project from planning through post-construction activities, and

**WHEREAS**, this agreement is intended to provide the conditions and requirements for County to obtain CBMP funding for County's project, and

**WHEREAS**, County desires that this project be constructed under the designation of Project No. **STWD-CBMP(7)**, State Control No. **00974F**, CBMP Control No. **00974F(b)** as

evidenced by the Resolution of County dated the 14th day of Feb., 2023, attached as Exhibit "A" and made a part of this agreement.



**NOW THEREFORE**, in consideration of these facts, and the promises of the Parties, County and State agree as follows:

**SECTION 1. DURATION OF THE AGREEMENT**

The agreement becomes effective upon the signing of the agreement by State. State intends to sign the agreement after County has signed. The agreement will expire when County's project is finished and final financial settlement has been completed, or as otherwise provided in this Agreement.

**SECTION 2. General CBMP Description and Requirements**

The CBMP program is generally described in this section. These provisions govern County's project when applicable, unless the specific project description in Section 3 makes any or all of the Section 2 provisions inapplicable.

**2.1 Overview.** The CBMP is intended to provide matching funds (see Section 3 below), based on the bridge construction costs specified in County's proposal, up to but not to exceed a specified maximum total payment or cap for the bridge construction phase only of the repair or replacement of structurally deficient county bridges. The CBMP encourages innovation in bridge design and construction and allows the bundling of bridge construction sites from one or multiple counties. The CBMP allows the replacement of a bridge with culvert pipes so long as County uses a properly completed hydraulic study to determine the appropriate size of the replacement culverts.

**2.2 Project Development and Management.** County is solely responsible for all phases of the project, including but not limited to planning, preliminary engineering including obtaining environmental permits, final design, right-of-way, bid letting, construction, construction engineering, operation and maintenance. This project is not a State project and State's involvement in the project is solely for establishing the conditions that must be met for funding to be provided as set out in this Agreement.

**2.3 Environmental.** County is solely responsible for determining what, if any, environmental permits apply to County's project. County is further responsible for completing all necessary environmental processes and obtaining all needed environmental permits before letting any part of the project to bids.

**2.4 Design Criteria.** County is solely responsible for the design of the bridge(s) or culverts to be constructed as a part of this project. The project shall be designed to meet or exceed the requirements of the 1) Nebraska Minimum Design Standards, 2) the NDOR (now NDOT) Policy for Design, Load-Rating and Inspection of Public Road Bridges dated May 24, 2010 (a copy of which is attached hereto as Exhibit "B" and incorporated by this reference), and 3) applicable State and local laws and policies. Additionally, the design of any bridges shall incorporate NDOT's approved bridge rail design TL-2 or TL-3 in the plans and shall include the approach guardrail with appropriate anchorages and terminations.

**2.5 Costs eligible for Reimbursement.** Eligible costs include the labor, materials and equipment necessary for the actual construction of the bridge or culvert project, and may include any other costs identified in the State's acceptance of the project proposal. County will

not be reimbursed for any of its other costs in planning, designing, developing, constructing or managing this project, including construction engineering, management and inspection.

**2.6 Time Restriction.** County's bridge construction must be completed by December 31, 2026, for the project to be eligible for either of the two payments to be made under this Agreement. No time extensions will be allowed, except in exceptional circumstances. Therefore, time is of the essence in this Agreement.

### **SECTION 3. COUNTY'S APPROVED PROJECT**

County's proposal included a project in **Saline County**. Each project is identified as follows:

County: **Saline County**

NBIS Bridge Structure(s): **C007602615**  
Project Description: **4.2S 1.5W OF PLEASANT HILL AT DRY CREEK**

Estimated Cost: **\$258,000.00**

Funding Split: State **\$141,241.00** (of the estimated costs specified in the proposal, capped at State's maximum contribution for **Multi - County proposal**)

NBIS Bridge Structure(s): **C007602625**  
Project Description: **N JCT N15/N41 1N 6.2E AT BRUSH CREEK**

Estimated Cost: **\$290,000.00**

Funding Split: State **\$158,759.00** (of the estimated costs specified in the proposal, capped at State's maximum contribution for **Multi - County proposal**)

State funding Contribution **\$300,000.00**.

State and County agree that the estimated cost for the project in each County is simply an estimate and may change. In the event that the estimate for any individual County's project is revised upward, based on State's analysis of proposed costs, the State's total payment for the individual County project will be revised upward in States discretion no more than 5% or cap of \$5,000. However, any upward adjustment made will not result in the State's contribution exceeding what was specified in the RFP regarding caps on Single Bridge, Multi Bridge Single County and Multi Bridge Multi County proposals.

### **SECTION 4. COUNTY'S RESPONSIBILITIES**

#### **4.1 General.**

County shall be responsible for all phases of the planning, obtaining environmental permits, design, construction, operations and maintenance of this project, including but not limited to, preliminary and construction engineering, management, planning, design, right-of-way activities, bid letting, construction, and future operation and maintenance all in accordance with the laws and policies applicable to County road projects. County agrees that its failure to

comply with the terms of this Agreement may lead to the State, in its sole discretion, withdrawing funding for the project. Further, County shall also be responsible for the following:

#### **4.2 Professional Performance**

County will be solely responsible for the professional performance and ability of County or its Design or Construction Engineering Professional. Examination by State, or any acceptance or use of the work product, will not be considered to be a full and comprehensive examination and will not be considered an approval of the work product which would relieve County or its Design or Construction Engineering Professionals from any liability or expense that would be connected with County's sole responsibility for the propriety and integrity of the professional work to be accomplished by County or its Design or Construction Engineering Professional pursuant to this agreement. That further, acceptance or approval of any of the work by State will not constitute a waiver of any rights of State to recover from County, damages that are caused by County or its Design or Construction Engineering Professional due to error, omission, or negligence of the Consultant in its work. That further, if, due to error, omission, or negligence of County or its Design or Construction Engineering Professional, the plans, specifications, and estimates are found to be in error or there are omissions therein revealed during the construction of the project and revision or reworking of the plans is necessary, County or its Design or Construction Engineering Professional shall make such revisions without expense to State. County or its Design or Construction Engineering Professional's legal liability for all damages incurred by State caused by error, omission, or negligent acts of County or its Design or Construction Engineering Professional will be borne by County without liability or expense to State.

#### **4.3 Timeline for Required Submittals**

The following information and/or documents must be submitted to State by the times provided below:

##### **4.3.1 Before County advertises the project for bid letting or begins Construction with County's own forces –**

- i. Bridge or Culvert Construction Project, when constructed by a Contractor -- Final Plans Package must be submitted to State for review and approval. The Final Plans Package must include:
  - a. Final Construction Plans and Specifications, sealed and signed by a Nebraska licensed professional engineer.
  - b. Hydraulic Data Sheet, sealed and signed by a Nebraska licensed professional engineer.
  - c. The engineer's estimate of construction costs.
  - d. Load Rating Summary Sheet, including all applicable calculations, sealed and signed by a Nebraska licensed professional engineer. If the new structure is not bridge length, (span less than 20 feet) no Load Rating Summary Sheet is required.
  - e. County's bid documents shall be written so that the bridge construction costs can be readily distinguished from roadway and other non-bridge related project costs.

- ii. Bridge or Culvert Construction Project, when constructed by County's own forces
  - Final Plans Package must be submitted to State for review and approval. The Final Plans Package must include:
    - a. Final Construction Plans and Specifications sealed and signed by a Nebraska licensed professional engineer.
    - b. Hydraulic Data Sheet, sealed and signed by a Nebraska licensed professional engineer.
    - c. The engineer's estimate of construction costs including a list of materials, and a breakdown of the estimated labor and equipment hours for construction.
    - d. Load Rating Summary Sheet, including all applicable calculations, sealed and signed by a Nebraska licensed professional engineer. If the new structure is not bridge length, (span less than 20 feet) no Load Rating Summary Sheet is required.
- iii. **In the event that County's proposal in Section 3 above, involves more than one culvert or bridge project (bundled), all information and/or documents above must be submitted and accepted by the State prior to County letting the projects for bids or the purchase of project materials. County shall let all bundled projects together in the same letting.**

**4.3.2. After County Awards a Construction Contract and/or Receives Material Invoices** – County must submit to State a copy of the executed construction contract or material invoices and a proposed schedule of project construction and completion.

**4.3.3. After Project Construction has been completed** – County must submit to State the final project cost documentation for all culverts and bridges constructed, a complete set of as-built plans, and County's certification, on a form provided by State, that the project has been completed. County shall enter, or cause its consultant to enter, the NBIS Initial Inspection data and photographs into State's Bridge Management Software (BrM) database. If the new structure is not bridge length, the County shall notify NDOT to remove the structure from the county bridge inventory.

**4.3.4. December 31, 2026—Project Construction must be completed.**

#### **4.4 Laws and Bid Letting**

County is required to comply with all laws applicable to the development, design, letting and construction of County's bridge or culvert project on a local road or street. County shall be responsible for assuring that its contractor has sufficient training, experience, labor and equipment to properly complete the work. Further, prior to County awarding a contract to a construction contractor, County shall provide to State all needed documentation about all bids received.

#### **4.5 Financial**

County shall solely be responsible for the following project costs:

- a. Planning, preliminary engineering including obtaining environmental permits, final design, right-of-way, bid letting, construction engineering, operation, maintenance and all other project phases with the exception of bridge construction costs, which will be eligible for CBMP funding.
- b. All expenses not paid by State under this agreement (the parties understand that all grading and roadway construction costs outside the limits of the bridge will not be paid by State with the exception of guardrail).

#### **4.6 Failure to complete construction as designed**

If County does not complete the construction of this project as described or shown on the approved plans, specification and estimates or as amended by any approved change orders, County shall notify State and may be required by State, in its sole discretion, to repay State any funds provided by State for the project. State will not participate in the costs of any change order proposed by County unless County presents to State 1) the details of the proposed change order, and 2) a detailed explanation of the reasons for the change order, and State determines, in its sole discretion, that the change order will be funded as a part of this project.

#### **4.7 Maintenance and Environmental Commitments**

Upon project completion, County shall own the bridge and have jurisdictional responsibility over the bridge. County shall maintain the constructed improvements and continue to meet environmental commitments at its own expense, and agrees to make provisions each year for such costs. County will release and hold harmless State, from any suits brought against State arising out of County's design, construction, operation, and maintenance of or related to the project.

#### **4.8 Change of Scope**

County understands that there are limited funds available for this bridge construction and that State reserves the right, in its sole discretion, to decline funding for any scope changes proposed by County for the bridge.

#### **4.9 Indemnification**

County agrees to hold harmless, indemnify, and defend State from all claims and liability due to the error, omission, or negligence of County or those of County's agents or employees arising out of County's project and the terms of this agreement.

### **SECTION 5. STATE'S RESPONSIBILITIES**

State shall be solely responsible for the following:

#### **5.1 Submittals**

State shall accept the documents submitted by the County under Section 4.3, Timeline for Required Submittals.

#### **5.2 Financial**

State's total financial obligation for the project shall be as specified in Section 3.

State shall pay its share of the project to County, based on the following schedule:

- a. Upon County's award of a construction contract or submittal of invoices for materials or rental equipment - 70 percent of State's share. For projects being constructed with

County's own forces, this initial payment will be 70 percent of the State's funding split specified in Section 3.

- b. Upon County's certification of project completion, submittal of all construction invoices and final review by State – the remaining 30 percent of the State's share up to the maximum total dollar amount.

## **SECTION 6. SUSPENSION OR TERMINATION**

### **6.1 Suspension**

State, in its sole discretion, reserves the right to suspend this agreement when State determines that there are issues related to project performance, responsiveness, or quality that must be corrected by County. State shall provide County with notice of the suspension including a description of the reason(s) for the suspension, a timeframe for County to correct the deficiencies, and when applicable, a description of the actions that must be taken for State to revoke the suspension.

A suspension may also be imposed by State for any of the reasons listed in the Termination subsection below, or for any significant change in the scope of the project that has not been previously approved by State.

Failure to correct the deficiencies identified in a suspension will be grounds for the loss of funding for the project and for termination of this agreement.

### **6.2 Termination**

This agreement may be terminated for the following reasons:

- a. State and County, by mutual written agreement, may terminate the agreement at any time.
- b. State may terminate this agreement for the following reasons:
  1. Failure of County to provide the submittals or meet deadlines as set out in this agreement.
  2. County's failure to cause the project to be constructed according to the approved project plans and specifications.
  3. Loss of or a lack of available funds for the project.
  4. County's breach of a provision of this agreement.
- c. Prior to State terminating this agreement, State shall provide written notice to County of the basis for termination and, when applicable, provide the County sixty (60) days to properly resolve all issues identified by State.
- d. County may terminate the agreement by providing written notice of termination to State, subject to subsection e below.
- e. Whenever the project is terminated for any reason, County shall be solely responsible for all costs associated with County's project and County shall promptly repay all previous payments made by State.

### **6.3 Review and Audit**

State reserves the right, but not the duty, to review County's work related to this project and reserves the right to complete a financial audit of County records for the project. County shall repay State any funds determined by audit to not be eligible or participating for this project.

## **SECTION 7. DRUG-FREE WORKPLACE**

County shall have an acceptable and current drug-free workplace policy on file with State.

**SECTION 8. FAIR EMPLOYMENT PRACTICES**

If County performs any part of the work on this project itself, County shall abide by the provisions of the Nebraska Fair Employment Practices Act as provided by Neb. Rev. Stat. §§ 48-1101, through 48-1126.

**SECTION 9. LAWFUL PRESENCE IN USA AND WORK ELIGIBILITY STATUS PROVISIONS**

County agrees to comply with the requirements of Neb. Rev. Stat. §§ 4-108 to 4-114 with its project, including, but not limited to, the requirements of § 4-114(2) to place in any contract it enters into with a public contractor a provision requiring the public contractor to use a federal immigration verification system to determine the work eligibility status of new employees physically performing services within the State of Nebraska.

**SECTION 10. ENTIRE AGREEMENT**

This agreement contains the entire agreement of County and State. No representations were made or relied upon by County or State other than those that are expressly set forth herein. No agent, employee or other representative of County or State is empowered to alter any of the terms in this agreement unless done in writing and signed by an authorized officer of the County and State.

**IN WITNESS WHEREOF**, the Parties hereby execute this agreement pursuant to lawful authority as of the date signed by each party.

EXECUTED by the County this 14th day of February, 2023.

WITNESS:

SALINE COUNTY



\_\_\_\_\_  
County Clerk

\_\_\_\_\_  
Chair, Board of Commissioners

EXECUTED by the State this \_\_\_\_\_ day of \_\_\_\_\_, 2023.

STATE OF NEBRASKA  
DEPARTMENT OF TRANSPORTATION  
Jodi Gibson

\_\_\_\_\_  
Local Assistance Division Manager

RESOLUTION

SIGNING OF THE PROJECT PROGRAM AGREEMENT – BL2343

Saline County

Resolution No. 2023-08

Whereas: Saline County is proposing a transportation project for which it would like to obtain County Bridge Match funds; and

Whereas: Saline County understands that it must strictly follow all State and local laws, rules, regulations, policies, and guidelines applicable to the funding of the project; and

Whereas: Saline County and Nebraska Department of Transportation (NDOT) wish to enter into a new Project Program Agreement setting out the various duties and funding responsibilities for the project.

Be It Resolved: by the Board of Commissioners of Saline County that:

Chair of the Saline County Board of Commissioners is hereby authorized to sign the attached Project Program Agreement between Saline County and the NDOT.

Saline County is committed to providing local funds for the project as required by the Project Program Agreement.

NDOT Project Number: STWD-CBMP(7)

NDOT Control Number: 00974F

NDOT Project Name: County Bridge Match Program

Adopted this 14th day of February, 2023 at Wilber Nebraska.  
(Month) (Year)

The Board of Commissioners of Saline County

\_\_\_\_\_  
\_\_\_\_\_  
\_\_\_\_\_

Board/Council Member \_\_\_\_\_

Moved the adoption of said resolution

Member \_\_\_\_\_ Seconded the Motion

Roll Call: \_\_\_\_\_ Yes \_\_\_\_\_ No \_\_\_\_\_ Abstained \_\_\_\_\_ Absent

Resolution adopted, signed and billed as adopted

Attest:

\_\_\_\_\_

Signature County Clerk

STATE OF NEBRASKA, DEPARTMENT OF ROADS (NDOR)  
POLICY FOR DESIGN, LOAD-RATING AND INSPECTION OF PUBLIC ROAD BRIDGES  
May 24, 2010

**Definitions:** Bridge – Bridge shall have the definition set out in 23 CFR § 650.305. Maintenance - Maintenance means the act, operation, continuous process of repair, reconstruction or preservation of the whole or any part of any highway, including surface, shoulders, roadsides, traffic control devices, structures, waterways, and drainage facilities, for the purpose of keeping it at or near or improving upon its original standard of usefulness and safety (Neb. Rev. Stat. § 39-101(6)). Public Road – Public road means any road or street under the jurisdiction of and maintained by a public authority and open to public travel (28 USC § 101(27)).

Any Bridge on a Public Road under the jurisdiction of the state, a municipality, a county, or a village shall be designed, constructed, inspected and maintained in accordance with state and Federal law. The public entity with jurisdiction for any Bridge located on a Public Road in Nebraska shall provide to NDOR copies of all bridge plans, hydraulic design reports, load-rating reports and inspection reports applicable to each Public Road Bridge.

**Hydraulic Design:** The hydraulic design will satisfy the requirements of Federal-Aid Policy Guide, 23 CFR 650A (Location and Hydraulic Design of Encroachments on Floodplains) and FHWA-IP-90-017 (HEC-18 Scour), which is covered in the NDOR Hydraulic Analysis Guidelines. The Nebraska Natural Resources Commission provides minimum standards governing the hydraulic design of improvements in floodplains (See 455 NAC Section 004 and 005, and Chapter 31 of the Nebraska statutes). A Nebraska licensed professional engineer with training and experience in the hydraulic design of Public Road Bridges shall complete, seal and sign the hydraulic design report. The hydraulic design reports for Bridge projects on Federal-aid projects shall be submitted to the NDOR Local Projects Division in accordance with the LPA Manual. The hydraulic design reports for all other Bridge projects shall be submitted to the NDOR Bridge Division prior to construction.

**Geometric and Structural Design:** All Public Road Bridges shall be designed and constructed to meet the minimum standards of the Nebraska Board of Public Roads Classifications and Standard for the geometric and structural design of Bridges (See Minimum Standards created pursuant to Neb. Rev. Stat. § 39-2113). These standards apply to the original construction and any reconstruction, rehabilitation or retrofit of the Bridge. A Nebraska licensed professional engineer with training and experience in geometric and structural design of Public Road Bridges shall complete, seal and sign the Bridge design plans. The plans for Bridge projects on Federal-aid projects shall be submitted to the NDOR Local Projects Division in accordance with the LPA Manual. The plans for all other Bridge projects shall be submitted to the NDOR Bridge Division prior to construction.

**Load-Rating and Inspection:** All Public Road Bridges are subject to the National Bridge Inspection Standards (NBIS). The NBIS requires that all Public Road Bridges be load-rated and inspected. The NDOR Bridge Inspection Program (BIP) Manual sets out the policy covering load-rating and inspection of Public Road Bridges. All Bridges shall be load-rated in accordance with the (BIP) Manual and the load-rating documents shall be sealed and signed by a Nebraska licensed professional engineer with training and experience in Bridge load-rating. The load-rating documents of any Bridge constructed as a part of a Federal-aid project shall be submitted to the NDOR Local Projects Division in accordance with the LPA Manual. The load-ratings documents for all other bridges shall be submitted to the NDOR Bridge Division in accordance with the (BIP) Manual. Bridges must be inspected regularly as designated in the (BIP) Manual, or funding sanctions may be imposed.

**Exemption:** This policy does not apply to Bridges located on private property or private roads.

Signed by:

Mark Traynowicz  
State Bridge Engineer

Signed by:

Monty Fredrickson  
Director

**COUNTY BRIDGE MATCH PROGRAM**  
**PROGRAM AGREEMENT**

SALINE COUNTY  
STATE OF NEBRASKA, DEPARTMENT OF TRANSPORTATION  
PROJECT NO. STWD-CBMP(7)  
STATE CONTROL NO. 00974F  
CBMP CONTROL NO. 00974F(d)  
COUNTY BRIDGE MATCH PROGRAM

**THIS AGREEMENT** is between **Saline County**, Nebraska hereinafter referred to as "County," and the State of Nebraska, Department of Transportation, hereinafter referred to as "State," and collectively referred to as the "Parties."

**WITNESSETH:**

**WHEREAS**, the Transportation Innovation Act established a new program called the County Bridge Match Program (CBMP), (Neb. Rev. Stat. § 39-2805), and

**WHEREAS**, the purpose of the CBMP is to promote innovative solutions and provide additional funding to accelerate the repair and replacement of deficient bridges on the county road system, and

**WHEREAS**, State has developed the program requirements for the CBMP and a project proposed by County has been selected to be funded by the CBMP, and

**WHEREAS**, County will be responsible for completing all phases of the project, however, State will reimburse County a designated share up to a maximum total dollar amount of County's actual and reasonable costs of only the bridge construction phase of the project, as further described herein, and

**WHEREAS**, for this project the State's designated share will be 55 percent of the bridge or culvert construction costs, with a maximum State contribution not to exceed **\$300,000.00**, as more specifically described below, and

**WHEREAS**, County's CBMP project(s) are described as follows:

**C007603005P – .1N 1.1E OF WILBER AT STREAM**  
**C007614815 – 1.6S .2W OF WESTERN AT STREAM**

**WHEREAS**, funding for the CBMP sunsets on June 30, 2023; accordingly, the project must be completed by **December 31, 2026** in order to maximize the overall number of projects that can be funded as a part of the CBMP, and

**WHEREAS**, County has designated a point of contact, who will be known for this project as the Project Liaison (PL), and who will be in charge of all aspects of the project from planning through post-construction activities, and

**WHEREAS**, this agreement is intended to provide the conditions and requirements for County to obtain CBMP funding for County's project, and

**WHEREAS**, County desires that this project be constructed under the designation of Project No. **STWD-CBMP(7)**, State Control No. **00974F**, CBMP Control No. **00974F(d)** as

evidenced by the Resolution of County dated the 14th day of Feb., 2023, attached as Exhibit "A" and made a part of this agreement.

NOW THEREFORE, in consideration of these facts, and the promises of the Parties, County and State agree as follows:

**SECTION 1. DURATION OF THE AGREEMENT**

The agreement becomes effective upon the signing of the agreement by State. State intends to sign the agreement after County has signed. The agreement will expire when County's project is finished and final financial settlement has been completed, or as otherwise provided in this Agreement.

**SECTION 2. General CBMP Description and Requirements**

The CBMP program is generally described in this section. These provisions govern County's project when applicable, unless the specific project description in Section 3 makes any or all of the Section 2 provisions inapplicable.

**2.1 Overview.** The CBMP is intended to provide matching funds (see Section 3 below), based on the bridge construction costs specified in County's proposal, up to but not to exceed a specified maximum total payment or cap for the bridge construction phase only of the repair or replacement of structurally deficient county bridges. The CBMP encourages innovation in bridge design and construction and allows the bundling of bridge construction sites from one or multiple counties. The CBMP allows the replacement of a bridge with culvert pipes so long as County uses a properly completed hydraulic study to determine the appropriate size of the replacement culverts.

**2.2 Project Development and Management.** County is solely responsible for all phases of the project, including but not limited to planning, preliminary engineering including obtaining environmental permits, final design, right-of-way, bid letting, construction, construction engineering, operation and maintenance. This project is not a State project and State's involvement in the project is solely for establishing the conditions that must be met for funding to be provided as set out in this Agreement.

**2.3 Environmental.** County is solely responsible for determining what, if any, environmental permits apply to County's project. County is further responsible for completing all necessary environmental processes and obtaining all needed environmental permits before letting any part of the project to bids.

**2.4 Design Criteria.** County is solely responsible for the design of the bridge(s) or culverts to be constructed as a part of this project. The project shall be designed to meet or exceed the requirements of the 1) Nebraska Minimum Design Standards, 2) the NDOR (now NDOT) Policy for Design, Load-Rating and Inspection of Public Road Bridges dated May 24, 2010 (a copy of which is attached hereto as Exhibit "B" and incorporated by this reference), and 3) applicable State and local laws and policies. Additionally, the design of any bridges shall incorporate NDOT's approved bridge rail design TL-2 or TL-3 in the plans and shall include the approach guardrail with appropriate anchorages and terminations.

**2.5 Costs eligible for Reimbursement.** Eligible costs include the labor, materials and equipment necessary for the actual construction of the bridge or culvert project, and may include any other costs identified in the State's acceptance of the project proposal. County will

not be reimbursed for any of its other costs in planning, designing, developing, constructing or managing this project, including construction engineering, management and inspection.

**2.6 Time Restriction.** County's bridge construction must be completed by December 31, 2026, for the project to be eligible for either of the two payments to be made under this Agreement. No time extensions will be allowed, except in exceptional circumstances. Therefore, time is of the essence in this Agreement.

### **SECTION 3. COUNTY'S APPROVED PROJECT**

County's proposal included a project in **Saline County**. Each project is identified as follows:

County: **Saline County**

NBIS Bridge Structure(s): **C007603005P**  
Project Description: **.1N 1.1E OF WILBER AT STREAM**

Estimated Cost: **\$266,000.00**

Funding Split: State **\$143,243.00** (of the estimated costs specified in the proposal, capped at State's maximum contribution for **Multi - County proposal**)

NBIS Bridge Structure(s): **C007614815**  
Project Description: **1.5S .2W OF WESTERN AT STREAM**

Estimated Cost: **\$290,000.00**

Funding Split: State **\$156,757.00** (of the estimated costs specified in the proposal, capped at State's maximum contribution for **Multi - County proposal**)

State funding Contribution **\$300,000.00**.

State and County agree that the estimated cost for the project in each County is simply an estimate and may change. In the event that the estimate for any individual County's project is revised upward, based on State's analysis of proposed costs, the State's total payment for the individual County project will be revised upward in States discretion no more than 5% or cap of \$5,000. However, any upward adjustment made will not result in the State's contribution exceeding what was specified in the RFP regarding caps on Single Bridge, Multi Bridge Single County and Multi Bridge Multi County proposals.

### **SECTION 4. COUNTY'S RESPONSIBILITIES**

#### **4.1 General.**

County shall be responsible for all phases of the planning, obtaining environmental permits, design, construction, operations and maintenance of this project, including but not limited to, preliminary and construction engineering, management, planning, design, right-of-way activities, bid letting, construction, and future operation and maintenance all in accordance with the laws and policies applicable to County road projects. County agrees that its failure to

comply with the terms of this Agreement may lead to the State, in its sole discretion, withdrawing funding for the project. Further, County shall also be responsible for the following:

#### 4.2 Professional Performance

County will be solely responsible for the professional performance and ability of County or its Design or Construction Engineering Professional. Examination by State, or any acceptance or use of the work product, will not be considered to be a full and comprehensive examination and will not be considered an approval of the work product which would relieve County or its Design or Construction Engineering Professionals from any liability or expense that would be connected with County's sole responsibility for the propriety and integrity of the professional work to be accomplished by County or its Design or Construction Engineering Professional pursuant to this agreement. That further, acceptance or approval of any of the work by State will not constitute a waiver of any rights of State to recover from County, damages that are caused by County or its Design or Construction Engineering Professional due to error, omission, or negligence of the Consultant in its work. That further, if, due to error, omission, or negligence of County or its Design or Construction Engineering Professional, the plans, specifications, and estimates are found to be in error or there are omissions therein revealed during the construction of the project and revision or reworking of the plans is necessary, County or its Design or Construction Engineering Professional shall make such revisions without expense to State. County or its Design or Construction Engineering Professional's legal liability for all damages incurred by State caused by error, omission, or negligent acts of County or its Design or Construction Engineering Professional will be borne by County without liability or expense to State.

#### 4.3 Timeline for Required Submittals

The following information and/or documents must be submitted to State by the times provided below:

##### 4.3.1 Before County advertises the project for bid letting or begins Construction with County's own forces –

- i. Bridge or Culvert Construction Project, when constructed by a Contractor -- Final Plans Package must be submitted to State for review and approval. The Final Plans Package must include:
  - a. Final Construction Plans and Specifications, sealed and signed by a Nebraska licensed professional engineer.
  - b. Hydraulic Data Sheet, sealed and signed by a Nebraska licensed professional engineer.
  - c. The engineer's estimate of construction costs.
  - d. Load Rating Summary Sheet, including all applicable calculations, sealed and signed by a Nebraska licensed professional engineer. If the new structure is not bridge length, (span less than 20 feet) no Load Rating Summary Sheet is required.
  - e. County's bid documents shall be written so that the bridge construction costs can be readily distinguished from roadway and other non-bridge related project costs.

- ii. Bridge or Culvert Construction Project, when constructed by County's own forces
  - Final Plans Package must be submitted to State for review and approval. The Final Plans Package must include:
    - a. Final Construction Plans and Specifications sealed and signed by a Nebraska licensed professional engineer.
    - b. Hydraulic Data Sheet, sealed and signed by a Nebraska licensed professional engineer.
    - c. The engineer's estimate of construction costs including a list of materials, and a breakdown of the estimated labor and equipment hours for construction.
    - d. Load Rating Summary Sheet, including all applicable calculations, sealed and signed by a Nebraska licensed professional engineer. If the new structure is not bridge length, (span less than 20 feet) no Load Rating Summary Sheet is required.
- iii. **In the event that County's proposal in Section 3 above, involves more than one culvert or bridge project (bundled), all information and/or documents above must be submitted and accepted by the State prior to County letting the projects for bids or the purchase of project materials. County shall let all bundled projects together in the same letting.**

4.3.2. **After County Awards a Construction Contract and/or Receives Material Invoices** – County must submit to State a copy of the executed construction contract or material invoices and a proposed schedule of project construction and completion.

4.3.3. **After Project Construction has been completed** – County must submit to State the final project cost documentation for all culverts and bridges constructed, a complete set of as-built plans, and County's certification, on a form provided by State, that the project has been completed. County shall enter, or cause its consultant to enter, the NBIS Initial Inspection data and photographs into State's Bridge Management Software (BrM) database. If the new structure is not bridge length, the County shall notify NDOT to remove the structure from the county bridge inventory.

4.3.4. **December 31, 2026—Project Construction must be completed.**

#### 4.4 **Laws and Bid Letting**

County is required to comply with all laws applicable to the development, design, letting and construction of County's bridge or culvert project on a local road or street. County shall be responsible for assuring that its contractor has sufficient training, experience, labor and equipment to properly complete the work. Further, prior to County awarding a contract to a construction contractor, County shall provide to State all needed documentation about all bids received.

#### 4.5 **Financial**

County shall solely be responsible for the following project costs:

- a. Planning, preliminary engineering including obtaining environmental permits, final design, right-of-way, bid letting, construction engineering, operation, maintenance and all other project phases with the exception of bridge construction costs, which will be eligible for CBMP funding.
- b. All expenses not paid by State under this agreement (the parties understand that all grading and roadway construction costs outside the limits of the bridge will not be paid by State with the exception of guardrail).

#### **4.6 Failure to complete construction as designed**

If County does not complete the construction of this project as described or shown on the approved plans, specification and estimates or as amended by any approved change orders, County shall notify State and may be required by State, in its sole discretion, to repay State any funds provided by State for the project. State will not participate in the costs of any change order proposed by County unless County presents to State 1) the details of the proposed change order, and 2) a detailed explanation of the reasons for the change order, and State determines, in its sole discretion, that the change order will be funded as a part of this project.

#### **4.7 Maintenance and Environmental Commitments**

Upon project completion, County shall own the bridge and have jurisdictional responsibility over the bridge. County shall maintain the constructed improvements and continue to meet environmental commitments at its own expense, and agrees to make provisions each year for such costs. County will release and hold harmless State, from any suits brought against State arising out of County's design, construction, operation, and maintenance of or related to the project.

#### **4.8 Change of Scope**

County understands that there are limited funds available for this bridge construction and that State reserves the right, in its sole discretion, to decline funding for any scope changes proposed by County for the bridge.

#### **4.9 Indemnification**

County agrees to hold harmless, indemnify, and defend State from all claims and liability due to the error, omission, or negligence of County or those of County's agents or employees arising out of County's project and the terms of this agreement.

### **SECTION 5. STATE'S RESPONSIBILITIES**

State shall be solely responsible for the following:

#### **5.1 Submittals**

State shall accept the documents submitted by the County under Section 4.3, Timeline for Required Submittals.

#### **5.2 Financial**

State's total financial obligation for the project shall be as specified in Section 3.

State shall pay its share of the project to County, based on the following schedule:

- a. Upon County's award of a construction contract or submittal of invoices for materials or rental equipment - 70 percent of State's share. For projects being constructed with

County's own forces, this initial payment will be 70 percent of the State's funding split specified in Section 3.

- b. Upon County's certification of project completion, submittal of all construction invoices and final review by State -- the remaining 30 percent of the State's share up to the maximum total dollar amount.

## **SECTION 6. SUSPENSION OR TERMINATION**

### **6.1 Suspension**

State, in its sole discretion, reserves the right to suspend this agreement when State determines that there are issues related to project performance, responsiveness, or quality that must be corrected by County. State shall provide County with notice of the suspension including a description of the reason(s) for the suspension, a timeframe for County to correct the deficiencies, and when applicable, a description of the actions that must be taken for State to revoke the suspension.

A suspension may also be imposed by State for any of the reasons listed in the Termination subsection below, or for any significant change in the scope of the project that has not been previously approved by State.

Failure to correct the deficiencies identified in a suspension will be grounds for the loss of funding for the project and for termination of this agreement.

### **6.2 Termination**

This agreement may be terminated for the following reasons:

- a. State and County, by mutual written agreement, may terminate the agreement at any time.
- b. State may terminate this agreement for the following reasons:
  - 1. Failure of County to provide the submittals or meet deadlines as set out in this agreement.
  - 2. County's failure to cause the project to be constructed according to the approved project plans and specifications.
  - 3. Loss of or a lack of available funds for the project.
  - 4. County's breach of a provision of this agreement.
- c. Prior to State terminating this agreement, State shall provide written notice to County of the basis for termination and, when applicable, provide the County sixty (60) days to properly resolve all issues identified by State.
- d. County may terminate the agreement by providing written notice of termination to State, subject to subsection e below.
- e. Whenever the project is terminated for any reason, County shall be solely responsible for all costs associated with County's project and County shall promptly repay all previous payments made by State.

### **6.3 Review and Audit**

State reserves the right, but not the duty, to review County's work related to this project and reserves the right to complete a financial audit of County records for the project. County shall repay State any funds determined by audit to not be eligible or participating for this project.

## **SECTION 7. DRUG-FREE WORKPLACE**

County shall have an acceptable and current drug-free workplace policy on file with State.

**SECTION 8. FAIR EMPLOYMENT PRACTICES**

If County performs any part of the work on this project itself, County shall abide by the provisions of the Nebraska Fair Employment Practices Act as provided by Neb. Rev. Stat. §§ 48-1101, through 48-1126.

**SECTION 9. LAWFUL PRESENCE IN USA AND WORK ELIGIBILITY STATUS PROVISIONS**

County agrees to comply with the requirements of Neb. Rev. Stat. §§ 4-108 to 4-114 with its project, including, but not limited to, the requirements of § 4-114(2) to place in any contract it enters into with a public contractor a provision requiring the public contractor to use a federal immigration verification system to determine the work eligibility status of new employees physically performing services within the State of Nebraska.

**SECTION 10. ENTIRE AGREEMENT**

This agreement contains the entire agreement of County and State. No representations were made or relied upon by County or State other than those that are expressly set forth herein. No agent, employee or other representative of County or State is empowered to alter any of the terms in this agreement unless done in writing and signed by an authorized officer of the County and State.

IN WITNESS WHEREOF, the Parties hereby execute this agreement pursuant to lawful authority as of the date signed by each party.

EXECUTED by the County this 14<sup>th</sup> day of February, 2023.

WITNESS:

SALINE COUNTY



\_\_\_\_\_  
County Clerk

\_\_\_\_\_  
Chair, Board of Commissioners

EXECUTED by the State this \_\_\_\_\_ day of \_\_\_\_\_, 2023.

STATE OF NEBRASKA  
DEPARTMENT OF TRANSPORTATION  
Jodi Gibson

\_\_\_\_\_  
Local Assistance Division Manager

RESOLUTION

SIGNING OF THE PROJECT PROGRAM AGREEMENT – BL2345

Saline County

Resolution No. 2023-09

**Whereas:** Saline County is proposing a transportation project for which it would like to obtain County Bridge Match funds; and

**Whereas:** Saline County understands that it must strictly follow all State and local laws, rules, regulations, policies, and guidelines applicable to the funding of the project; and

**Whereas:** Saline County and Nebraska Department of Transportation (NDOT) wish to enter into a new Project Program Agreement setting out the various duties and funding responsibilities for the project.

**Be It Resolved:** by the Board of Commissioners of Saline County that:

Chair of the Saline County Board of Commissioners is hereby authorized to sign the attached Project Program Agreement between Saline County and the NDOT.

Saline County is committed to providing local funds for the project as required by the Project Program Agreement.

NDOT Project Number: STWD-CBMP(7)

NDOT Control Number: 00974F

NDOT Project Name: County Bridge Match Program

Adopted this 14th day of February, 2023 at Wilber Nebraska.  
(Month) (Year)

The Board of Commissioners of Saline County

\_\_\_\_\_  
\_\_\_\_\_  
\_\_\_\_\_

Board/Council Member \_\_\_\_\_

Moved the adoption of said resolution

Member \_\_\_\_\_ Seconded the Motion

Roll Call: \_\_\_\_\_ Yes \_\_\_\_\_ No \_\_\_\_\_ Abstained \_\_\_\_\_ Absent

Resolution adopted, signed and billed as adopted

Attest:

\_\_\_\_\_  
Signature County Clerk

STATE OF NEBRASKA, DEPARTMENT OF ROADS (NDOR)  
POLICY FOR DESIGN, LOAD-RATING AND INSPECTION OF PUBLIC ROAD BRIDGES  
May 24, 2010

**Definitions:** Bridge -- Bridge shall have the definition set out in 23 CFR § 650.305. Maintenance - Maintenance means the act, operation, continuous process of repair, reconstruction or preservation of the whole or any part of any highway, including surface, shoulders, roadsides, traffic control devices, structures, waterways, and drainage facilities, for the purpose of keeping it at or near or improving upon its original standard of usefulness and safety (Neb. Rev. Stat. § 39-101(6)). Public Road -- Public road means any road or street under the jurisdiction of and maintained by a public authority and open to public travel (28 USC § 101(27)).

Any Bridge on a Public Road under the jurisdiction of the state, a municipality, a county, or a village shall be designed, constructed, inspected and maintained in accordance with state and Federal law. The public entity with jurisdiction for any Bridge located on a Public Road in Nebraska shall provide to NDOR copies of all bridge plans, hydraulic design reports, load-rating reports and inspection reports applicable to each Public Road Bridge.

**Hydraulic Design:** The hydraulic design will satisfy the requirements of Federal-Aid Policy Guide, 23 CFR 650A (Location and Hydraulic Design of Encroachments on Floodplains) and FHWA-IP-90-017 (HEC-18 Scour), which is covered in the NDOR Hydraulic Analysis Guidelines. The Nebraska Natural Resources Commission provides minimum standards governing the hydraulic design of improvements in floodplains (See 455 NAC Section 004 and 005, and Chapter 31 of the Nebraska statutes). A Nebraska licensed professional engineer with training and experience in the hydraulic design of Public Road Bridges shall complete, seal and sign the hydraulic design report. The hydraulic design reports for Bridge projects on Federal-aid projects shall be submitted to the NDOR Local Projects Division in accordance with the LPA Manual. The hydraulic design reports for all other Bridge projects shall be submitted to the NDOR Bridge Division prior to construction.

**Geometric and Structural Design:** All Public Road Bridges shall be designed and constructed to meet the minimum standards of the Nebraska Board of Public Roads Classifications and Standard for the geometric and structural design of Bridges (See Minimum Standards created pursuant to Neb. Rev. Stat. § 39-2113). These standards apply to the original construction and any reconstruction, rehabilitation or retrofit of the Bridge. A Nebraska licensed professional engineer with training and experience in geometric and structural design of Public Road Bridges shall complete, seal and sign the Bridge design plans. The plans for Bridge projects on Federal-aid projects shall be submitted to the NDOR Local Projects Division in accordance with the LPA Manual. The plans for all other Bridge projects shall be submitted to the NDOR Bridge Division prior to construction.

**Load-Rating and Inspection:** All Public Road Bridges are subject to the National Bridge Inspection Standards (NBIS). The NBIS requires that all Public Road Bridges be load-rated and inspected. The NDOR Bridge Inspection Program (BIP) Manual sets out the policy covering load-rating and inspection of Public Road Bridges. All Bridges shall be load-rated in accordance with the (BIP) Manual and the load-rating documents shall be sealed and signed by a Nebraska licensed professional engineer with training and experience in Bridge load-rating. The load-rating documents of any Bridge constructed as a part of a Federal-aid project shall be submitted to the NDOR Local Projects Division in accordance with the LPA Manual. The load-rating documents for all other bridges shall be submitted to the NDOR Bridge Division in accordance with the (BIP) Manual. Bridges must be inspected regularly as designated in the (BIP) Manual, or funding sanctions may be imposed.

**Exemptions:** This policy does not apply to Bridges located on private property or private roads.

Signed by:

Mark Trzynowicz  
State Bridge Engineer

Signed by:

Monty Fredrickson  
Director

SALINE COUNTY  
REQUEST TO OCCUPY COUNTY RIGHT-OF-WAY

Windstream Nebraska, LLC, hereinafter referred to as "owner" requests to construct telecommunications facilities occupying the Right-of-Way of the Saline County Public Highway System. Windstream to relocate existing buried facilities a/c Saline County project C-76(824) Bridge replacement located south of Road I on Road 1400 in the Dorchester exchange.in Saline County, NE - **WO# 71503003000021;PR-12133.**

Owner proposes to place and maintain the aforesaid construction on Saline County Public Right-of-Way at owner's risk and expense and hereby absolves Saline County, its officials and employees from any liability arising from the placing and maintaining of said construction.

The owner will cooperate fully with the officials of Saline County and will keep them fully and immediately informed of all construction or maintenance work required on Saline County Public Right-of-Way. The surface of the road will be restored to the same condition as it was prior to the work and such restoration will be accomplished to the reasonable satisfaction of the Saline County Officials.

Person to be contacted, prior to construction by a Telephone Company or a Utility Company, is the County Highway Superintendent or the Highway Coordinator, Courthouse – 2nd floor, telephone #821-2737. Each location to be inspected by Saline County when permit is submitted and upon project completion, at which latter time any work or supply of gravel reasonable required to restore the surface of the road or work to restore the County Right-of-Way to the same condition as it was prior to the work will be determined and the work performed and gravel supplied by the owner.

Draw a sketch indicating approximate location to or from some easily recognized landmark, or a sketch may be attached.

Date February 10, 2023

Melvin Fecher

Melvin Fecher – Analyst I – Permitting Team  
1170-B1F02-1211A, 4001 N Rodney Parham Rd  
Little Rock, AR 72212

At the option of the County Board of Commissioners, the owner shall furnish a Surety Bond for an amount specified by the County Board of Commissioners. The form of the Surety Bond shall be acceptable to the Saline County Board.

Surety Bond Required: YES \_\_\_\_\_ NO X Amount \_\_\_\_\_

COMMENTS: (County only) I recommend that this permit be granted subject to Windstream Nebraska LLC agreeing to return the damaged area to its original condition.

Date \_\_\_\_\_

\_\_\_\_\_  
Highway Superintendent or Coordinator

We hereby grant Windstream Nebraska LLC permission to occupy the County Right-of-Way at the location and according to the procedure and conditions described in this document.

Date February 14, 2023

\_\_\_\_\_  
(Signature - Chairman of County Board)

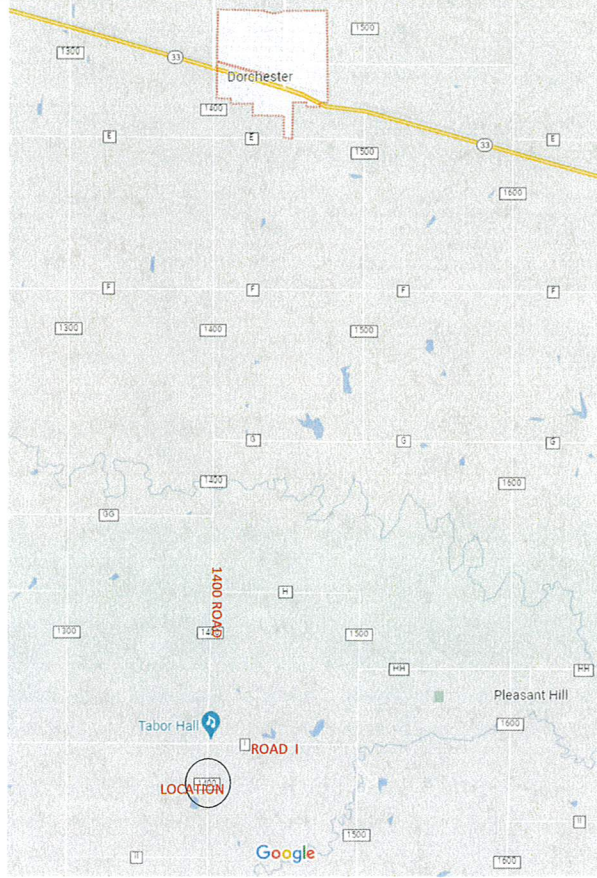

DATE: 2/10/2023	<b>JOB DESCRIPTION</b> WINDSTREAM TO RELOCATED EXIST. BU. CA. LOCATED SOUTH OF I ROAD ON RD 1440 IN THE DORCHESTER EXCH.	<b>CUSTOMER/OTHER CONTACTS</b> WS CONST. MANAGER RON SCHENK 402-405-7877 TY REGNIER 402-480-2982	W.O 71503003000021	<b>EXCHANGE</b> DORCHESTER	CUT SHEET REQ. N
GEO BLK DRCHNE			WINDSTREAM ENGINEER: TODD J. WILLIAMS 531-510-8528	DWG: 1 OF 2	PERMIT REQ. Y
REQUESTED BY SALINE CO PROJECT # C-76(824)					MOP REQ. N
					JOINT WORK REQ. N

WINDSTREAM NEBR.

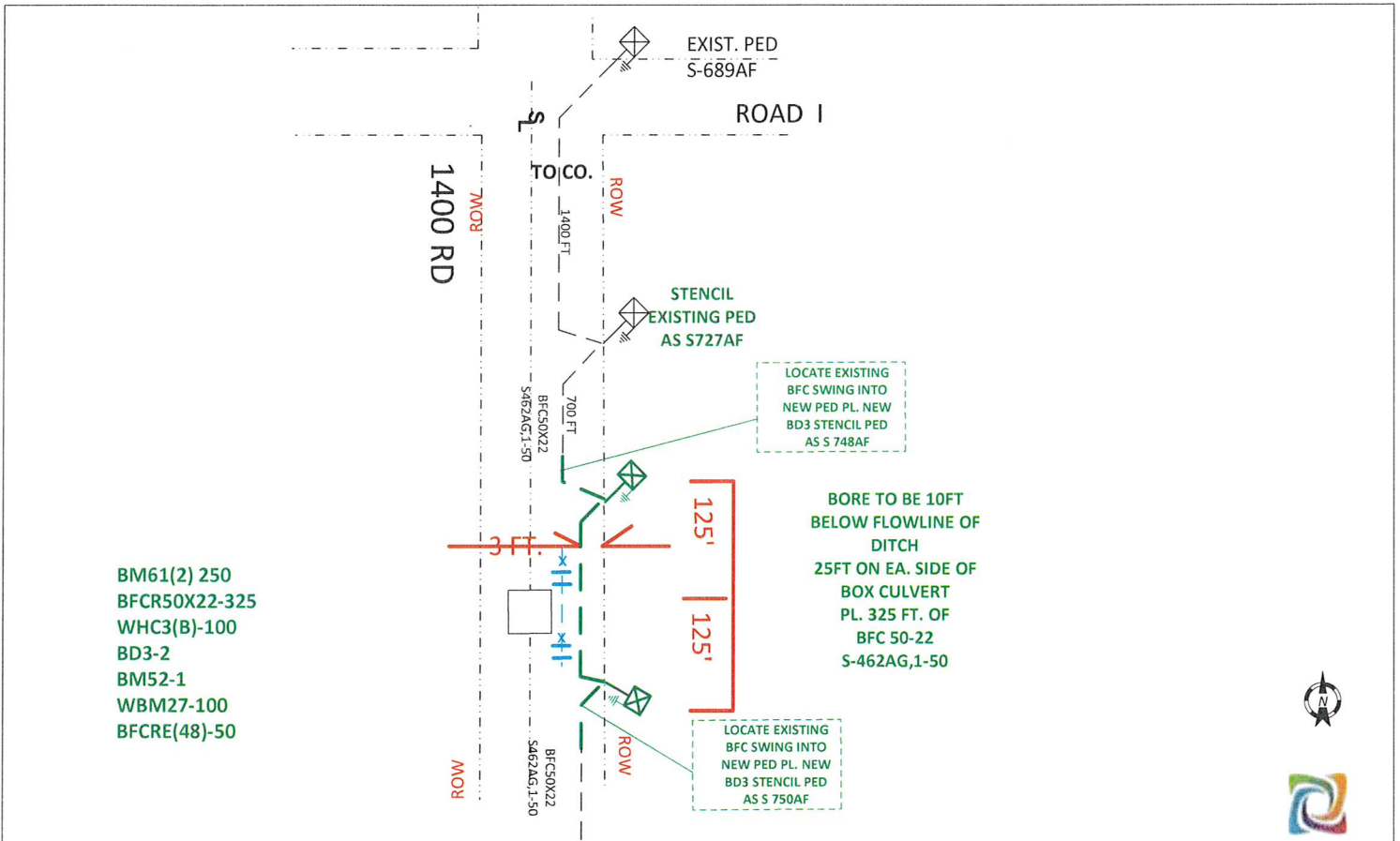

DATE: 2/10/2023	<b>JOB DESCRIPTION</b> WINDSTREAM TO RELOCATED EXIST. BU., CA. LOCATED SOUTH OF I ROAD ON RD 1440 IN THE DORCHESTER EXCH.	<b>CUSTOMER/OTHER CONTACTS</b> WS CONST. MANAGER RON SCHENK 402-405-7877 TY REGNIER 402-480-2982	WINDSTREAM NEBR.	W.O. 71503003000021	<b>EXCHANGE</b> DORCHEESTER	CUT SHEET REQ N PERMIT REQ Y MOP REQ N JOINT WORK REQ N
GEO BLK DRCHNE				WINDSTREAM ENGINEER: TODD J. WILLIAMS 531-510-8528	DWG: 2 OF 2	
REQUESTED BY SALINE CO PROJECT # C-76(824)						

**SALINE COUNTY**  
**REQUEST TO OCCUPY COUNTY RIGHT-OF-WAY**

Unite Private Networks \_\_\_\_\_, hereinafter referred to as owner, requests to construct/bury Electric Cable/Utility Line occupying the Right-of-Way of the Saline County Public Road System at (legal description):  
NE 1/4 of Section 27, T8N, R4E on West side of Boswell Avenue

---

Construction on Gravel Roads **MUST** be Tunneled/ Bored  
Trenching on dirt roads optional by pre-approval only

(Please indicate one) : Trenching \_\_\_\_\_ (pre-approved by Highway Superintendent)  
Tunneled/Bored  X

Owner proposes to place and maintain the aforesaid construction on Saline County Public Right-of-Way at owner's expense and hereby absolves Saline County, its officials and employees from any liability from the placing and maintaining of said construction.

The owner will cooperate fully with the officials of Saline County and will keep them fully and immediately informed of all construction or maintenance work required on Saline County public Right-of-Way. The surface of the road will be restored to the same condition as it was prior to the work and such restoration will be accomplished to the reasonable satisfaction of the Saline County officials.

Person to be contacted, prior to construction, is the County Highway Superintendent, Courthouse, second floor, phone (402) 821-2737. Each location to be inspected by Saline County when permit is submitted and upon project completion. Saline County will determine if any labor or gravel will be required to restore the surface of the road or County Right-of-Way to the same condition as it was prior to the project. If determined necessary, the work shall be performed and gravel supplied by the owner.

Attach a sketch or map indicating approximate location to or from an easily recognized landmark.

Date 2/8/2023

Shaun Frye  
Signature of "Owner"

Phone 402-669-7460

3880 Vermaas PI  
Lincoln, NE 68502  
(complete mailing address)

\*\*\*\*\*

At the option of the County Board of Commissioners, the owner shall furnish a Surety Bond for an amount specified by the Board. The form of the bond shall be acceptable to the Saline County Board.

Surety Bond Required: YES \_\_\_\_\_ NO  X  Amount \_\_\_\_\_

COMMENTS: (County only) I recommend that this permit be granted subject to  
Unite Private Networks agreeing to return the damaged area to its original condition.

THIS PERMIT SUBJECT TO REQUIREMENTS LISTED ON ATTACHED SHEET

Date \_\_\_\_\_

\_\_\_\_\_  
Signature - Highway Superintendent

\*\*\*\*\*

We hereby grant Unite Private Networks permission to occupy the County Right-of-Way at the location indicated and according to the procedure and conditions described in this document.

Date February 14, 2023

\_\_\_\_\_  
Signature - Chairman of County Board

Date 2/8/2023

**SALINE COUNTY**

**REQUIREMENTS**

(Bore or Bury Electric Cable\Utility Line)

1. The cable must be buried a MINIMUM of five (5) feet BELOW ditch elevation.
2. Saline County will be notified no less than 48 hours in advance of any construction.

**CALL:** Bruce Filipi (402)-821-2737 (Hwy. Supt. Office)  
(402)-826-9394 (Cell)

3. The applicant, Unite Private Networks will adequately sign the location of the Electric Cable/Utility line at frequent intervals and at all culvert locations to insure that the applicant, \_\_\_\_\_ will be notified before any future excavation by county forces.
4. The applicant, Unite Private Networks will be required to relocate the Electric Cable/Utility line at their own expense, if necessary, for any future roadway construction.

**# 5 & 6 Apply to trenching operations only (Dirt Roads)**

5. The applicant, Unite Private Networks will be responsible for obtaining adequate compaction of backfill for all trench cuts. Backfill will be placed in successive horizontal layers not exceeding six (6) inches, and properly compacted.
6. All waste material from the trenching operation will be evenly distributed over the ditch side slopes or back slopes. All roadway side slopes, ditches or back slopes disturbed by the trenching operation will be reseeded with a mixture of grass seed as recommended by the Nebraska Game & Parks Commission for seeding county roadways.

Applicant: Shaun Frye  
*Signature*

Address: 3880 Vermaas Pl  
Lincoln, NE 68502

Phone # 402-669-7460

SALINE COUNTY  
REQUEST TO OCCUPY COUNTY RIGHT-OF-WAY

Windstream Nebraska, LLC, hereinafter referred to as "owner" requests to construct telecommunications facilities occupying the Right-of-Way of the Saline County Public Highway System. Windstream to relocate existing buried facilities a/c Saline County bridge replacement C-76(787) located south of M Road on Road 1500 in the Wilber exchange in Saline County, NE - **WO# 15000060630154;PR-12158.**

Owner proposes to place and maintain the aforesaid construction on Saline County Public Right-of-Way at owner's risk and expense and hereby absolves Saline County, its officials and employees from any liability arising from the placing and maintaining of said construction.

The owner will cooperate fully with the officials of Saline County and will keep them fully and immediately informed of all construction or maintenance work required on Saline County Public Right-of-Way. The surface of the road will be restored to the same condition as it was prior to the work and such restoration will be accomplished to the reasonable satisfaction of the Saline County Officials.

Person to be contacted, prior to construction by a Telephone Company or a Utility Company, is the County Highway Superintendent or the Highway Coordinator, Courthouse – 2nd floor, telephone #821-2737. Each location to be inspected by Saline County when permit is submitted and upon project completion, at which latter time any work or supply of gravel reasonable required to restore the surface of the road or work to restore the County Right-of-Way to the same condition as it was prior to the work will be determined and the work performed and gravel supplied by the owner.

Draw a sketch indicating approximate location to or from some easily recognized landmark, or a sketch may be attached.

Date February 10, 2023

Melvin Fecher

Melvin Fecher – Analyst I – Permitting Team  
1170-B1F02-1211A, 4001 N Rodney Parham Rd  
Little Rock, AR 72212

At the option of the County Board of Commissioners, the owner shall furnish a Surety Bond for an amount specified by the County Board of Commissioners. The form of the Surety Bond shall be acceptable to the Saline County Board.

Surety Bond Required: YES \_\_\_\_\_ NO x Amount \_\_\_\_\_

COMMENTS: (County only) I recommend that this permit be granted subject to Windstream Nebraska LLC agreeing to return the damaged area to its original condition.

Date \_\_\_\_\_

\_\_\_\_\_  
Highway Superintendent or Coordinator

We hereby grant Windstream Nebraska LLC permission to occupy the County Right-of-Way at the location and according to the procedure and conditions described in this document.

Date February 14, 2023

\_\_\_\_\_  
(Signature - Chairman of County Board)



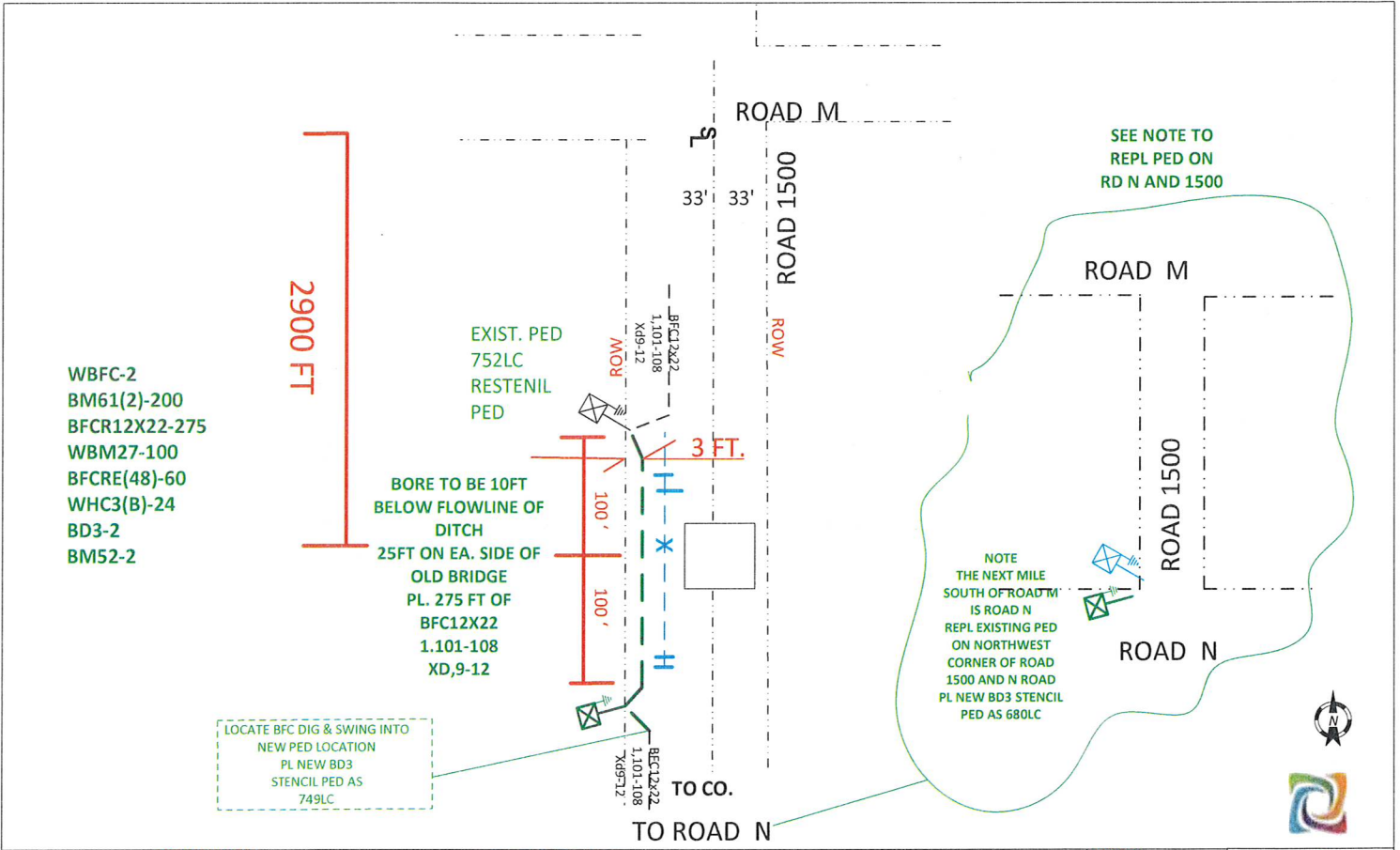

DATE: 2/10/2023	JOB DESCRIPTION WINDSTREAM TO RELOCATED EXIST. BU. CA. LOCATED SOUTH OF M ROAD ON RD 1500 IN THE WILBER EXCH.	CUSTOMER/OTHER CONTACTS WS CONST. MANAGER RON SCHENK 402-405-7877 TY REGNIER 402-480-2982	W.O. 15000060630154	EXCHANGE WILBER	CUT SHEET REQ N PERMIT REQ Y MOP REQ N JOINT WORK REQ N
GEO BLK WLRNE		WINDSTREAM NEBR.	WINDSTREAM ENGINEER: TODD J. WILLIAMS 531-510-8528	DWG: 2 OF 2	
REQUESTED BY SALINE CO PROJECT # C-76(787)					

APS7040  
2/08/23  
12:22:33

SALINE  
BOARD PREAPPROVAL REPORT  
GENERAL  
FROM 02/24/2023 TO 02/24/2023

Account #	Description	Account Amt	Vendor	Invoice Description	Claim #
601-00 BOARD					
00-3-0101	OFFICE SUPPLIES	75.00	MIPS INC	INV 23020947 INV 23020946 I	23020158
		*****			
	601-00 BOARD	75.00			
		*****			
602-00 CLERK					
00-2-2000	PRINTING & PUBLISHING	241.20	SEWARD COUNTY INDEPENDENT	INV 161146 INV 161293	23020174
00-3-0101	OFFICE SUPPLIES	81.17	EAKES OFFICE PLUS	INV 8638910-0 INV 8642660-	23020134
		*****			
	602-00 CLERK	322.37			
		*****			
603-00 TREASURER					
00-2-1801	DUES, SUB, REG, & TRAINING	40.00	NACO	D. SPANYERS	23020159
00-2-1801	DUES, SUB, REG, & TRAINING	50.00	NEBRASKA ASSN OF COUNTY T	D.SPANYERS DUE	23020161
		*****			
	603-00 TREASURER	90.00			
		*****			
605-00 ASSESSOR					
00-2-3900	CONTRACTOR FOR REAPPRAISAL	6,848.25	STANARD APPRAISAL SERVICE	INV 3052 INV 3055	23020178
00-3-0101	OFFICE SUPPLIES	335.66	EAKES OFFICE PLUS	INV 8638910-0 INV 8642660-	23020134
		*****			
	605-00 ASSESSOR	7,183.91			
		*****			
610-00 VOICE/DATA SERVICES					
00-4-0200	IT SUPPORT-SOARIN	3,663.40	SOARIN GROUP LLC	INV 10131 INV INV-10081 IN	23020177
00-4-0201	DATA PROCESSING-MIPS	2,198.97	MIPS INC	INV 23020947 INV 23020946 I	23020158
00-4-0203	INTERNET SERVICES	3,065.12	UNITE PRIVATE NETWORKS	SI-23-005077	23020182
00-4-0204	LANDLINE SERVICES	3,362.92	UNITE PRIVATE NETWORKS	SI-23-005077	23020182
00-4-0205	MOBILE PHONE SERVICES	171.12	VERIZON WIRELESS	INV 9925769734	23020185
		*****			
	610-00 VOICE/DATA SERVICES	12,461.53			
		*****			
621-00 CLERK OF DIST. COURT					
00-2-1200	OFFICE EQUIPMENT REPAIR	54.36	EAKES OFFICE PLUS	INV 8638910-0 INV 8642660-	23020134
		*****			
	621-00 CLERK OF DIST. COURT	54.36			
		*****			
622-00 COUNTY COURT SYSTEM-JUDGE					
00-3-0101	OFFICE SUPPLIES	260.16	EAKES OFFICE PLUS	INV 8638910-0 INV 8642660-	23020134

SALINE  
BOARD PREAPPROVAL REPORT  
GENERAL  
FROM 02/24/2023 TO 02/24/2023

Account #	Description	Account Amt	Vendor	Invoice Description	Claim #
00-4-0200	EQUIPMENT RENTAL - OFFICE	140.00	CAPITAL BUSINESS SYSTEMS	INV 33339569	23020128
00-4-0200	EQUIPMENT RENTAL - OFFICE	150.00	MICROFILM IMAGING SYSTEMS	INV 91252	23020156
00-4-0200	EQUIPMENT RENTAL - OFFICE	50.03	SHREDDING SOLUTIONS	INV 15290 INV 15291	23020176
622-00 COUNTY COURT SYSTEM-JUDGE		600.19	*****		
631-00 CLERK OF DIST. COURT CHILD SUPPORT					
00-2-1100	DATA PROCESSING COSTS	118.00	MIPS INC	INV 23020947 INV 23020946 I	23020158
631-00 CLERK OF DIST. COURT CHILD SUPPORT		118.00	*****		
641-00 BUILDING & GROUNDS (COURT HOUSE)					
00-2-0501	LIGHT	4,317.22	CITY OF WILBER	ACCT 2680700 ACCT 7200000 A	23020129
00-2-0502	WATER	156.49	CITY OF WILBER	ACCT 2680700 ACCT 7200000 A	23020129
00-2-0503	HEATING/FUELS	3,929.29	BLACK HILLS ENERGY	# 2148 1560 72 5825 0639 22	23020127
00-2-0505	GARBAGE	290.50	CITY OF WILBER	ACCT 2680700 ACCT 7200000 A	23020129
00-2-9900	MISCELLANEOUS	36.41	WALKER UNIFORM RENTAL	INV 1252559	23020188
00-3-0103	JANITORIAL SUPPLIES	69.12	THE HOME DEPOT PRO	INV 725850010	23020146
00-3-0103	JANITORIAL SUPPLIES	21.99	SACK LUMBER COMPANY	INV 2301152767	23020166
00-3-0119	BUILDING SUPPLIES	300.63	EAKES OFFICE PLUS	INV 8638910-0 INV 8642660-	23020134
00-5-0230	BUILDING IMPROVEMENTS	2,285.48	CUMMINS SALES AND SERVICE	INV J3-81090 INV J3-80332	23020133
00-5-0230	BUILDING IMPROVEMENTS	425.00	ELECTRONIC CONTRACTING CO	INV 38428 INV 38146	23020135
00-5-0230	BUILDING IMPROVEMENTS	3,618.05	GRUNWALD MECHANICAL CONTR	INV 47657 INV 47339	23020142
00-5-0319	JANITORIAL EQUIPMENT	15.35	41 AUTO PARTS	INV 67204	23020191
641-00 BUILDING & GROUNDS (COURT HOUSE)		15,465.53	*****		
645-00 EXTENSION OFFICE					
00-2-1704	MILEAGE ALLOWANCE	14.93	MELANIE KUNC	MILEAGE	23020151
00-2-1704	MILEAGE ALLOWANCE	79.39	BECKY VALES	MILEAGE	23020183
645-00 EXTENSION OFFICE		94.32	*****		
651-00 SHERIFF					
00-1-1100	UNIFORM ALLOWANCE	77.04	GALLS LLC	INV 023390959 INV 02334679	23020140
00-1-1100	UNIFORM ALLOWANCE	224.06	VISA	AMAZON 7243444 AMAZON 52426	23020187
00-2-1200	OFFICE EQUIPMENT REPAIR	296.00	SOARIN GROUP LLC	INV 10131 INV INV-10081 IN	23020177
00-2-1801	DUES, SUB, REG, & TRAINING	200.00	SALINE COUNTY MUTUAL AID	2023 MBRMRSHP 23 MEMBERSHIP	23020170
00-2-1801	DUES, SUB, REG, & TRAINING	100.00	VISA	VISA 6084	23020186
00-3-0101	OFFICE SUPPLIES	22.89	EAKES OFFICE PLUS	INV 8638910-0 INV 8642660-	23020134
00-3-0209	FUEL	5,290.85	SAPP BROS INC - LINCOLN	ACCT# 715561	23020172
00-3-0212	7 EQUIPMENT REPAIRS-COMMERCIAL	926.22	41 AUTO PARTS	ACCT # 33	23020192

SALINE  
BOARD PREAPPROVAL REPORT  
GENERAL  
FROM 02/24/2023 TO 02/24/2023

Account #	Description	Account Amt	Vendor	Invoice Description	Claim #
*****					
	651-00 SHERIFF	7,137.06			
*****					
652-00 ATTORNEY					
00-3-0101	OFFICE SUPPLIES	193.20	EAKES OFFICE PLUS	INV 8638910-0 INV 8642660-	23020134
00-3-0101	OFFICE SUPPLIES	325.00	SEWARD COUNTY INDEPENDENT	INV 161146 INV 161293	23020174
00-5-0500	OFFICE EQUIPMENT	337.63	GREATAMERICA FINANCIAL SV	INV 33382248	23020141
*****					
	652-00 ATTORNEY	855.83			
*****					
662-00 ATTORNEY-CHILD SUPPORT					
00-2-1801	DUES, SUB, REG, & TRAINING	155.57	THOMSON REUTERS	INV 847749803	23020180
*****					
	662-00 ATTORNEY-CHILD SUPPORT	155.57			
*****					
671-00 JAIL					
00-1-1100	UNIFORM ALLOWANCE	222.92	GALLS LLC	INV 023390959 INV 02334679	23020140
00-1-1100	UNIFORM ALLOWANCE	77.96	HEATH SPORTS AND TEES	INV E24496 INV E24454	23020144
00-1-1100	UNIFORM ALLOWANCE	183.36	VISA	AMAZON 7243444 AMAZON 52426	23020187
00-2-0101	ELECTRICITY	2,513.24	CITY OF WILBER	ACCT 2680700 ACCT 7200000 A	23020129
00-2-0102	WATER	856.96	CITY OF WILBER	ACCT 2680700 ACCT 7200000 A	23020129
00-2-0103	GAS	8,687.63	BLACK HILLS ENERGY	# 2148 1560 72 5825 0639 22	23020127
00-2-0505	GARBAGE	156.83	CITY OF WILBER	ACCT 2680700 ACCT 7200000 A	23020129
00-2-0609	MAINTENANCE CONTRACTS/REPAIRS	537.04	ANYTIME PLUMBING & HEATIN	INV 24224VI INV 24186VI INV	23020124
00-2-0609	MAINTENANCE CONTRACTS/REPAIRS	1,864.48	NMC EXCHANGE LLC	INV 558390	23020163
00-2-1200	OFFICE EQUIPMENT REPAIR	487.00	SOARIN GROUP LLC	INV 10131 INV INV-10081 IN	23020177
00-2-1801	DUES, SUB, REG, & TRAINING	4.55	LANGUAGE LINE SERVICES IN	INV 10734105	23020153
00-2-1801	DUES, SUB, REG, & TRAINING	10.91	VISA	AMAZON 7243444 AMAZON 52426	23020187
00-2-1900	BOARD OF PRISONERS-MEALS	10,244.21	SUMMIT FOOD SERVICE LLC	INV 2000165118 INV 20001657	23020179
00-2-3000	MEDICAL SERVICES	781.26	ASSOCIATED ANESTHESIOLOGI	ID 639487118 ID 639487118	23020125
00-2-3000	MEDICAL SERVICES	48.97	CRETE AREA MEDICAL CENTER	CNTL 746247000 CNTL 7237389	23020131
00-2-3000	MEDICAL SERVICES	780.00	FRIEND COMMUNITY HEALTHCA	DOS 02/02/23 DOS 01/26/23	23020139
00-2-3000	MEDICAL SERVICES	614.00	ZAC KEATING DDS	ACCT 006729	23020149
00-2-3000	MEDICAL SERVICES	7.08	LINCOLN RADIOLOGY GROUP P	DOB 10/20/67	23020154
00-2-9900	MISCELLANEOUS	509.68	FARMERS COOPERATIVE	ACCT 649770 ACCT 1715	23020136
00-2-9900	MISCELLANEOUS	328.73	41 AUTO PARTS	ACCT # 33	23020192
00-3-0100	SUPPLIES & MATERIALS-LINENS ET	824.55	CULLIGAN OF CRETE	INV 60082 INV 60139	23020132
00-3-0101	OFFICE SUPPLIES	183.51	EAKES OFFICE PLUS	INV 8638910-0 INV 8642660-	23020134
00-3-0103	JANITORIAL SUPPLIES	513.00	EAKES OFFICE PLUS	INV 8638910-0 INV 8642660-	23020134
00-3-0103	JANITORIAL SUPPLIES	20.44	VISA	AMAZON 7243444 AMAZON 52426	23020187
00-3-0103	JANITORIAL SUPPLIES	78.83	WALKER UNIFORM RENTAL	INV 1252558	23020189
00-3-0105	MEDICAL SUPPLIES	257.47	BARNAS DRUG INC	ACCT #228	23020126
00-3-0105	MEDICAL SUPPLIES	171.01	VISA	AMAZON 7243444 AMAZON 52426	23020187
00-3-0119	BUILDING SUPPLIES	324.46	CRETE ACE HARDWARE #82121	ACCT 212111	23020130

SALINE  
BOARD PREAPPROVAL REPORT  
GENERAL  
FROM 02/24/2023 TO 02/24/2023

Account #	Description	Account Amt	Vendor	Invoice Description	Claim #
00-3-0119	BUILDING SUPPLIES	327.57	JCI INDUSTRIES INC	INV 8246619	23020147
00-3-0119	BUILDING SUPPLIES	379.60	MENARDS LINCOLN STORE SOU	INV 2366	23020155
00-3-0209	FUEL	1,322.71	SAPP BROS INC - LINCOLN	ACCT# 715561	23020172
00-5-0500	OFFICE EQUIPMENT	166.83	ELECTRONIC CONTRACTING CO	INV 38428 INV 38146	23020135
<b>671-00 JAIL</b>		<b>33,486.79</b>			
690-00 911	EMERGENCY SERVICES				
00-1-1100	UNIFORM ALLOWANCE	80.00	HEATH SPORTS AND TEES	INV E24496 INV E24454	23020144
00-2-1801	DUES, SUB, REG, & TRAINING	10.91	VISA	AMAZON 7243444 AMAZON 52426	23020187
00-5-0500	OFFICE EQUIPMENT	218.00	VISA	AMAZON 7243444 AMAZON 52426	23020187
<b>690-00 911 EMERGENCY SERVICES</b>		<b>308.91</b>			
693-00	EMERGENCY MANAGEMENT (CIVIL DEF)				
00-1-0301	ADMINISTRATIVE SALARY	3,700.00	JEFFERSON COUNTY EMERGENC	JANUARY 23	23020148
00-1-0305	CLERICAL SALARY	650.00	JEFFERSON COUNTY EMERGENC	JANUARY 23	23020148
00-2-0500	TOWER ELECTRICITY	70.47	CITY OF WILBER	ACCT 2680700 ACCT 7200000 A	23020129
00-2-0500	TOWER ELECTRICITY	250.00	NORRIS PUBLIC POWER	ACCT 157245100 ACCT 1572450	23020164
00-2-1801	DUES, SUB, REG, & TRAINING	200.00	SALINE COUNTY MUTUAL AID	2023 MBMRSH 23 MEMBERSHIP	23020170
<b>693-00 EMERGENCY MANAGEMENT (CIVIL DEF)</b>		<b>4,870.47</b>			
701-00	HIGHWAY SUPERINTENDENT				
00-2-1801	DUES, SUB, REG, & TRAINING	160.00	NEBRASKA ASSN CTY ENG HWY B.	FILIPPI REG B. FILIPPI DU	23020160
<b>701-00 HIGHWAY SUPERINTENDENT</b>		<b>160.00</b>			
970-00	MISCELLANEOUS & MISC. COURTS				
00-1-0803	DENTAL INSURANCE	100.00	HOLLIE ZURCHER	REIMBURSE DENT	23020190
00-1-1400	MISCELLANEOUS INS	60.99	FIRST CONCORD BENEFITS GR	JAN 23 CAFE	23020137
00-1-1400	MISCELLANEOUS INS	938.00	FIRST CONCORD BENEFITS GR	JANUARY 23 FEBUARY 23	23020138
00-2-2000	PRINTING AND PUBLISHING (P & P	689.88	SEWARD COUNTY INDEPENDENT	INV 161146 INV 161293	23020174
00-2-2411	DISTRICT COURT ATTORNEY FEES	1,666.20	MATTHEW K KOSMICKI	CR 21 299 CR 21-56	23020150
00-2-2412	COUNTY COURT ATTORNEY	809.09	MATTHEW K KOSMICKI	CR 21 299 CR 21-56	23020150
00-2-2601	DISTRICT COURT COSTS	25.31	SALINE COUNTY ATTORNEY PE	REIMBURSE	23020167
00-2-2601	DISTRICT COURT COSTS	180.00	SALINE COUNTY DISTRICT CO	CLAIM 1741 CLAIM 1742	23020169
00-2-2602	COUNTY COURT COSTS	25.50	NEBRASKA.GOV	INV 7334762	23020162
00-2-2602	COUNTY COURT COSTS	492.50	SALINE COUNTY COURT	CLAIM 463 CLAIM 464	23020168
00-2-2602	COUNTY COURT COSTS	443.05	SALINE COUNTY SHERIFF	JAN ST CASES	23020171
00-2-2602	COUNTY COURT COSTS	20.00	SECRETARY OF STATE RULES	FEBRUARY 2023	23020173
00-2-2700	MENTAL HEALTH BOARD COSTS	215.00	MATTHEW HANSON	MH23-2 MILEAGE	23020143

SALINE  
BOARD PREAPPROVAL REPORT  
GENERAL  
FROM 02/24/2023 TO 02/24/2023

Account #	Description	Account Amt	Vendor	Invoice Description	Claim #
00-2-2700	MENTAL HEALTH BOARD COSTS	308.95	MIDWEST COURT REPORTING I	MH 23-2 MILEAGE	23020157
00-2-2700	MENTAL HEALTH BOARD COSTS	308.95	DR CARROLL L VERHAGE	MH 23-2 MILEAGE	23020184
00-2-2915	JUVENILE CONTRACTUAL COST (JUV	1,518.00	LANCASTER CO YOUTH SERVIC	INV 2022000235	23020152
00-2-7000	MICROFILMING/PHOTOSTAT	102.16	EAKES OFFICE PLUS	INV 8638910-0 INV 8642660-	23020134
00-2-7000	MICROFILMING/PHOTOSTAT	108.12	MIPS INC	INV 23020947 INV 23020946 I	23020158
00-2-9900	MISCELLANEOUS	550.26	EAKES OFFICE PLUS	INV 8638910-0 INV 8642660-	23020134
00-2-9900	MISCELLANEOUS	7,037.50	HOLLY'S HOME IMPROVEMENTS	INV 1319	23020145
00-2-9900	MISCELLANEOUS	25,948.67	PICTOMETRY INTERNATIONAL	INV US432723	23020165
00-2-9900	MISCELLANEOUS	212.48	SHREDDING SOLUTIONS	INV 15290 INV 15291	23020176
00-2-9900	MISCELLANEOUS	297.00	SOARIN GROUP LLC	INV 10131 INV INV-10081 IN	23020177
00-2-9900	MISCELLANEOUS	624.00	UNION BANK & TRUST COMPAN	ANNUAL FEE WIRE FEE	23020181
00-3-0150	MISC. VEHICLE SUPPLIES (CAR EX	366.17	FARMERS COOPERATIVE	ACCT 649770 ACCT 1715	23020136
00-3-0150	MISC. VEHICLE SUPPLIES (CAR EX	108.58	SHOP QWIK	JANUARY 2023	23020175
970-00 MISCELLANEOUS & MISC. COURTS		43,156.36			
0100 GENERAL FUND		126,596.20			
705-00 BRIDGE/ROAD MAINTENANCE					
00-2-0501	LIGHT	368.61	CITY OF CRETE DEPT OF PUB	ACCT 11976	23020197
00-2-0501	LIGHT	155.80	CITY OF WILBER	ACCT 4570000	23020198
00-2-0501	LIGHT	579.96	NORRIS PUBLIC POWER	ACCT 124625900	23020209
00-2-0501	LIGHT	117.69	VILLAGE OF DORCHESTER	ACCT 10	23020217
00-2-0502	WATER	23.57	CITY OF CRETE DEPT OF PUB	ACCT 11976	23020197
00-2-0502	WATER	14.15	CITY OF WILBER	ACCT 4570000	23020198
00-2-0502	WATER	41.75	VILLAGE OF DORCHESTER	ACCT 10	23020217
00-2-0502	WATER	31.52	VILLAGE OF SWANTON	ACCT 207	23020218
00-2-0502	WATER	45.60	VILLAGE OF TOBIAS	ACCT SALINE CO	23020219
00-2-0502	WATER	33.00	VILLAGE OF WESTERN	INV 29020	23020220
00-2-0503	HEATING FUELS	2,887.16	BLACK HILLS ENERGY	8551 6368 77 0720 9478 50 7	23020196
00-2-0503	HEATING FUELS	1,066.68	FARMERS COOPERATIVE	ACCT 649700	23020202
00-2-0504	SEWER	46.49	CITY OF CRETE DEPT OF PUB	ACCT 11976	23020197
00-2-0504	SEWER	12.99	CITY OF WILBER	ACCT 4570000	23020198
00-2-0504	SEWER	21.15	VILLAGE OF DORCHESTER	ACCT 10	23020217
00-2-0504	SEWER	18.00	VILLAGE OF SWANTON	ACCT 207	23020218
00-2-0504	SEWER	12.00	VILLAGE OF TOBIAS	ACCT SALINE CO	23020219
00-2-0504	SEWER	35.00	VILLAGE OF WESTERN	INV 29020	23020220
00-2-0505	GARBAGE	20.32	CITY OF WILBER	ACCT 4570000	23020198
00-2-0505	GARBAGE	15.44	VILLAGE OF DORCHESTER	ACCT 10	23020217
00-2-0505	GARBAGE	16.01	VILLAGE OF SWANTON	ACCT 207	23020218
00-2-0505	GARBAGE	17.50	VILLAGE OF WESTERN	INV 29020	23020220
00-2-1400	ROAD EQUIPMENT REPAIR PARTS	236.78	WASTE CONNECTIONS OF NEBR	INV 1783499 INV 1782817 INV	23020223
00-2-1400	ROAD EQUIPMENT REPAIR PARTS	164.67	AKRS EQUIPMENT SOLUTIONS	ACCT 32675	23020193
00-2-1400	ROAD EQUIPMENT REPAIR PARTS	1,029.21	CRETE AUTO SUPPLY INC	ACCT 4575	23020200
00-2-1400	ROAD EQUIPMENT REPAIR PARTS	27.16	CUMMINS SALES AND SERVICE	INV F2-6024	23020201

SALINE  
BOARD PREAPPROVAL REPORT  
ROAD & BRIDGE  
FROM 02/24/2023 TO 02/24/2023

Account # 1099 Description Account Amt Vendor Invoice Description Claim #  
\*\*\*\*\*

Account #	Description	Amt	Vendor	Invoice Description	Claim #
00-2-1400	ROAD EQUIPMENT REPAIR PARTS	469.11	FARMERS UNION COOP CO	ACCT SALINE	23020203
00-2-1400	ROAD EQUIPMENT REPAIR PARTS	42.40	FILTERCARE OF NEBRASKA LL	INV 128443	23020204
00-2-1400	ROAD EQUIPMENT REPAIR PARTS	1,782.28	HYDRAULIC EQUIPMENT SERVI	INV 00085550	23020205
00-2-1400	ROAD EQUIPMENT REPAIR PARTS	133.22	NMC EXCHANGE LLC	ACCT 576500	23020208
00-2-1400	ROAD EQUIPMENT REPAIR PARTS	739.61	RDO TRUCK CENTER CO	ACCT L80351	23020211
00-2-1400	ROAD EQUIPMENT REPAIR PARTS	38.74	TRUCK CENTER COMPANIES	ACCT 18861	23020216
00-2-1500	ROAD EQUIPMENT REPAIR-LABOR	1,500.00	HYDRAULIC EQUIPMENT SERVI	INV 00085550	23020205
00-2-1700	TRAVEL EXPENSES	17.00	VISA	ACCT 1590	23020221
00-3-0106	SHOP SUPPLIES	246.50	BEAVER HARDWARE	ACCT SAL001	23020195
00-3-0106	SHOP SUPPLIES	116.40	CRETE ACE HARDWARE #82127	ACCT 212737	23020199
00-3-0106	SHOP SUPPLIES	21.28	CRETE AUTO SUPPLY INC	ACCT 4575	23020200
00-3-0106	SHOP SUPPLIES	21.99	FARMERS UNION COOP CO	ACCT SALINE	23020203
00-3-0106	SHOP SUPPLIES	91.57	LINDE GAS & EQUIPMENT	INV 33956642	23020206
00-3-0106	SHOP SUPPLIES	41.99	O'REILLY AUTO PARTS	ACCT 1547166	23020210
00-3-0108	ELECTRICAL SUPPLIES	6.99	BEAVER HARDWARE	ACCT SAL001	23020195
00-3-0108	ELECTRICAL SUPPLIES	158.81	VOGT ELECTRIC	CRETE SHOP	23020222
00-3-0109	SHOP TOOLS	305.04	VISA	ACCT 1590	23020221
00-3-0110	SMALL TOOLS, ETC.	16.99	BEAVER HARDWARE	ACCT SAL001	23020195
00-3-0110	SMALL TOOLS, ETC.	7.99	CRETE AUTO SUPPLY INC	ACCT 4575	23020200
00-3-0202	GRAVEL AND BORROW	7,418.80	BEATRICE CONCRETE CO INC	INV S1 180888	23020194
00-3-0209	MACHINERY & EQUIPMENT FUEL	21,139.44	FARMERS COOPERATIVE	ACCT 649700	23020202
00-3-0209	MACHINERY & EQUIPMENT FUEL	3,960.60	SAPP BROS INC - LINCOLN	ACCT 717088	23020213
00-3-0210	MACHINERY & EQUIPMENT GREASE-O	1,218.14	AKRS EQUIPMENT SOLUTIONS	ACCT 32675	23020193
00-3-0210	MACHINERY & EQUIPMENT GREASE-O	173.13	CRETE AUTO SUPPLY INC	ACCT 4575	23020200
00-3-0210	MACHINERY & EQUIPMENT GREASE-O	86.88	FARMERS UNION COOP CO	ACCT SALINE	23020203
00-3-0211	MACHINERY & EQUIPMENT TIRES-RE	48.00	FARMERS COOPERATIVE	ACCT 649700	23020202
00-3-0211	MACHINERY & EQUIPMENT TIRES-RE	3,190.00	FARMERS UNION COOP CO	ACCT SALINE	23020203
00-3-0303	GUARD RAIL AND POSTS	455.76	MIDWEST MACHINERY & SUPPL	INV 13814G	23020207
00-3-0400	MISCELLANEOUS	14.79	BEAVER HARDWARE	ACCT SAL001	23020195
00-3-0400	MISCELLANEOUS	20.94	CRETE AUTO SUPPLY INC	ACCT 4575	23020200
00-3-0400	MISCELLANEOUS	19.47	FARMERS UNION COOP CO	ACCT SALINE	23020203
00-5-1100	OTHER EQUIPMENT	2,245.00	SPRING CREEK REPAIR & FAR	INV 11219	23020215
00-5-1301	LEGAL FEES	10.00	SALINE COUNTY REGISTER OF	CUST 143	23020212
00-5-1302	ENGINEERING FEES	444.50	SPEECE-LEWIS ENGINEERS	INV 12260	23020214
00-5-1306	DRUG TESTING FEES & SUPPLIES	159.11	VISA	ACCT 1590	23020221
00-5-1400	MISCELLANEOUS	3,553.41	VISA	ACCT 1590	23020221

705-00 BRIDGE/ROAD MAINTENANCE 56,954.09

0300 ROAD & BRIDGE FUND 56,954.09

630-00 DISTRICT COURT-BAILIFF					
00-2-1704	MILEAGE	248.25	KATHY HOMOLKA	REIMBURSE MILEAGE	23020224
00-5-0500	OFFICE EQUIPMENT	26.99	KATHY HOMOLKA	REIMBURSE MILEAGE	23020224

630-00 DISTRICT COURT-BAILIFF 275.24

SALINE  
BOARD PREAPPROVAL REPORT  
DISTRICT COURT-BAILIFF  
FROM 02/24/2023 TO 02/24/2023

Account #	Description	Account Amt	Vendor	Invoice Description	Claim #
*****					
0900 DISTRICT COURT-BAILIFF FUND		275.24			
*****					
879-00 VISITOR IMPROVEMENT					
00-2-6040	VISITOR PROMOTION	1,200.00	NEBRASKA CZECHS OF WILBER	REIMBURSE	23020225
00-2-6040	VISITOR PROMOTION	1,200.00	VILLAGE OF DEWITT	REIMBURSE	23020226
*****					
879-00 VISITOR IMPROVEMENT		2,400.00			
*****					
0995 VISITORS IMPROVEMENT FUND		2,400.00			
*****					
612-00 EMPLOYEE WELLNESS					
00-3-0124	AWARDS/INCENTIVES	5,648.50	FIRST STATE BANK	GIFT CARDS	23020227
*****					
612-00 EMPLOYEE WELLNESS		5,648.50			
*****					
1502 EMPLOYEE WELLNESS FUND		5,648.50			
*****					
837-00 AGING SERVICES					
00-1-1400	PROGRAM EXPENSE	285.00	SAMANTHA COSAERT	1/24-2/7/23	23020230
00-1-1400	PROGRAM EXPENSE	14.87	FOOD MESTO	ACCT 1053	23020234
00-1-1400	PROGRAM EXPENSE	1,185.00	TIA L KRESHEL	1/24-2/7/23	23020235
00-1-1400	PROGRAM EXPENSE	52.50	PUBLIC HEALTH SOLUTIONS	MICHELE VANA	23020237
00-1-1400	PROGRAM EXPENSE	1,000.00	WILBER KLONDIKE LLC	2023 RENT	23020242
00-2-1200	HISPANIC OUTREACH	120.00	CITY OF CRETE	INV 1929	23020229
00-2-1200	HISPANIC OUTREACH	175.00	PURFOODS, LLC DBA MOM'S M	INV MM012023	23020238
00-2-1200	HISPANIC OUTREACH	714.00	WILBER CARE CENTER	JANUARY 2023	23020240
00-2-1300	BUILDING MAINTENANCE	80.00	ANYTIME PLUMBING & HEATIN	INV 24062VI	23020228
00-2-1704	MILEAGE ALLOWANCE	120.26	LORI MOLDENHAUER	MILEAGE	23020236
00-2-1704	MILEAGE ALLOWANCE	32.88	DONNA ZLAB-KOVAR	MILEAGE	23020243
00-2-1801	DUES, SUBS, REG., & TRAINING	100.00	WILBER CHAMBER OF COMMERC	2023 DUES	23020241
00-2-2000	PRINTING & PUBLISHING	7.41	SEWARD COUNTY INDEPENDENT	INV 161158	23020239
00-2-4442	DEWITT PASS THRU	353.50	DEWITT SENIOR CENTER	NSIP	23020231
00-3-0101	OFFICE SUPPLIES	934.13	EAKES OFFICE PLUS	INV 8598435-0	23020232
00-3-0209	FUEL	55.31	FARMERS COOPERATIVE	ACCT 5654	23020233
*****					
837-00 AGING SERVICES		5,229.86			
*****					

APS7040  
2/08/23  
12:22:33

SALINE  
BOARD PREAPPROVAL REPORT  
AGING SERVICES  
FROM 02/24/2023 TO 02/24/2023

Account #	Description	Account Amt	Vendor	Invoice Description	Claim #
*****					
	2250 AGING SERVICES FUND	5,229.86			
*****					
672-00 DRUG COURT					
00-2-1704	MILEAGE ALLOWANCE	75.00	MICHAEL W WEHLING	MILEAGE	23020244
*****					
	672-00 DRUG COURT	75.00			
*****					
*****					
	2390 DRUG COURT FUND	75.00			
*****					
666-00 JUVENILE SERVICES AID PROGRAM GRANT					
00-1-0200	SALARIES	1,065.00	ANITA STOUGARD	1/25-2/7/23	23020246
00-1-0201	MENTAL HEALTH COUNSELING	4,800.00	FAMILY SERVICE ASSOC OF L	INV -01312023	23020245
00-2-9900	MISCELLANEOUS	42.78	VERIZON WIRELESS	INV 9925769734	23020247
*****					
	666-00 JUVENILE SERVICES AID PROGRAM GRANT	5,907.78			
*****					
*****					
	2516 JUVENILE SERVICES AID PROGRAM GRANT FUND	5,907.78			
*****					
665-00 LAW ENFORCEMENT COMMISSARY					
00-2-0100	POSTAL SERVICES	189.00	VISA	USPS 582 AMAZON 0047430 DIR	23020252
00-2-1900	FOOD	5,813.88	SUMMIT FOOD SERVICE LLC	INV 2000165498 INV 20001654	23020251
00-2-9900	MISCELLANEOUS	1,611.73	BARNAS DRUG INC	ACCT #13	23020248
00-2-9900	MISCELLANEOUS	285.00	BOB BARKER COMPANY INC	INV 1865709	23020249
00-2-9900	MISCELLANEOUS	762.72	EAKES OFFICE PLUS	INV 8638910-0 INV 8651847-	23020250
00-2-9900	MISCELLANEOUS	1,954.24	SUMMIT FOOD SERVICE LLC	INV 2000165498 INV 20001654	23020251
00-2-9900	MISCELLANEOUS	109.57	VISA	USPS 582 AMAZON 0047430 DIR	23020252
*****					
	665-00 LAW ENFORCEMENT COMMISSARY	10,726.14			
*****					
*****					
	2965 LAW ENFORCEMENT COMMISSARY FUND	10,726.14			
*****					
*****					
	GRAND	213,812.81			
*****					