

**Richland County Community Unit School District No.1  
Board of Education**

**Special Meeting  
Thursday, May 7, 2026  
Richland County High School  
1200 E. Laurel St.  
Olney, IL 62450  
5:00 PM**

- I. Call to Order and Pledge of Allegiance
- II. Roll Call
- III. Recognition and Comments from Employees and Public
- IV. New Business
  - A. Approve Change Order with GeoSurfaces for the Tennis Courts.
- V. Adjournment

2



GeoSurfaces  
 10170 State Hwy OO  
 Bloomsdale, Missouri 63627  
 Phone: (636) 937-1268

**Project:** 025-036-MP - Richland County High School  
 415 N. Lincoln Street  
 Olney, Illinois 62450

## Prime Contract Potential Change Order #002: Richland Co HS - Tennis Court Orientation

<b>TO:</b>	Richland County Community Unit School District #1 1100 E Laurel St Olney, Illinois 62450	<b>FROM:</b>	GeoSurfaces Midwest 10170 State Route OO Suite C Bloomsdale, Missouri 63627
<b>PCO NUMBER/REVISION:</b>	002 / 0	<b>CONTRACT:</b>	1 - Richland County Athletic Complex
<b>REQUEST RECEIVED FROM:</b>	Jason Fox (Richland County Community Unit School District #1)	<b>CREATED BY:</b>	Houston Meyer (GeoSurfaces Midwest)
<b>STATUS:</b>	Pending - In Review	<b>CREATED DATE:</b>	4/8/2026
<b>REFERENCE:</b>		<b>PRIME CONTRACT CHANGE ORDER:</b>	None
<b>FIELD CHANGE:</b>	Yes		
<b>LOCATION:</b>		<b>ACCOUNTING METHOD:</b>	Amount Based
<b>SCHEDULE IMPACT:</b>	0 days	<b>PAID IN FULL:</b>	No
<b>EXECUTED:</b>	No	<b>SIGNED CHANGE ORDER RECEIVED DATE:</b>	
		<b>TOTAL AMOUNT:</b>	<del>\$696,950.00</del> TBD

**POTENTIAL CHANGE ORDER TITLE:** Richland Co HS - Tennis Court Orientation

**CHANGE REASON:** Allowance

**POTENTIAL CHANGE ORDER DESCRIPTION:** *(The Contract Is Changed As Follows)*  
 Geosurfaces options for shade offerings or tennis court rotation option.

- **Keep existing orientation & add 160' long shade structures on west side of each court.**
  - Cost variance
    - **20' - Materials and Installation - \$175,000** (potential 10-12 week material lead time. Includes cost for unplanned additional crew and equipment time onsite)
    - **30' - Materials and Installation - \$185,000** (potential 10-12 week material lead time. Includes cost for unplanned additional crew and equipment time onsite)
  
- **Adjust orientation per Rev 2 attached.**
  - Cost variance
    - **Add \$279,000.00**
    - Remediation of currently installed materials per current design required. Install new required materials per new design required.
    - This will not delay tennis court construction pending a decision is made by Friday 5/8/2026.
    - Scope listed below

Equipment Mobilization
Excavate New Detention Basin
18" Storm HDPE
12" Storm HDPE
Relocate / Reduce 12" Storm Pipe



**GENERAL NOTES:**

- CONTRACTOR TO VERIFY ALL EXISTING CONDITIONS PRIOR TO AND GRADING, EXCAVATION, OR DEMOLITION. CONTRACTOR TO INFORM THE OWNER OF ANY DISCREPANCIES BEFORE PROCEEDING WITH WORK.
- CONTRACTOR SHALL BE RESPONSIBLE FOR ALL SURVEYING AND STAKING.
- CONTRACTOR SHALL BE RESPONSIBLE FOR PROTECTION OF ADJACENT PROPERTIES AND ROADWAYS DURING CONSTRUCTION. ANY REPAIRS SHALL BE MADE AT THE CONTRACTOR'S EXPENSE.
- CONSTRUCTION MATERIALS SHALL CONFORM TO THE LOCAL AGENCY HAVING JURISDICTION.
- UNDERGROUND UTILITY LOCATES, EITHER SHOWN OR NOT SHOWN ON THESE PLANS, SHALL BE THE RESPONSIBILITY OF THE CONTRACTOR PRIOR TO ANY EXCAVATION OR GRADING.
- CONTRACTOR SHALL TAKE SPECIAL CARE TO LOCATE ALL ELECTRICAL AND FIBER OPTIC CABLES PRIOR TO ANY EXCAVATION OR GRADING.
- SURFACES DISTURBED OR DAMAGED DURING THE COURSE OF CONSTRUCTION SHALL BE REPAIRED TO THE OWNER'S SATISFACTION.

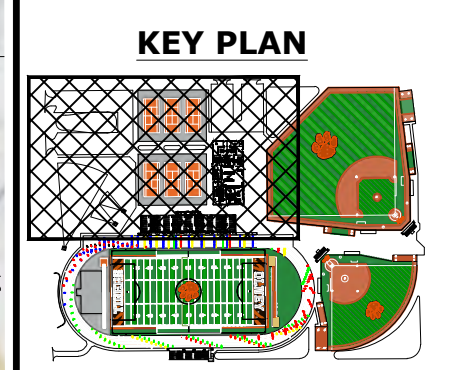
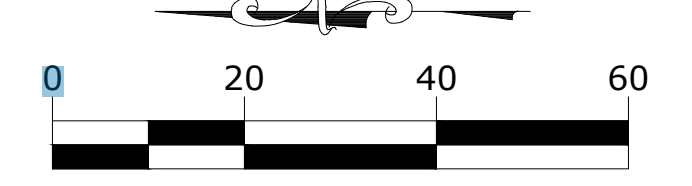

30' shade projections

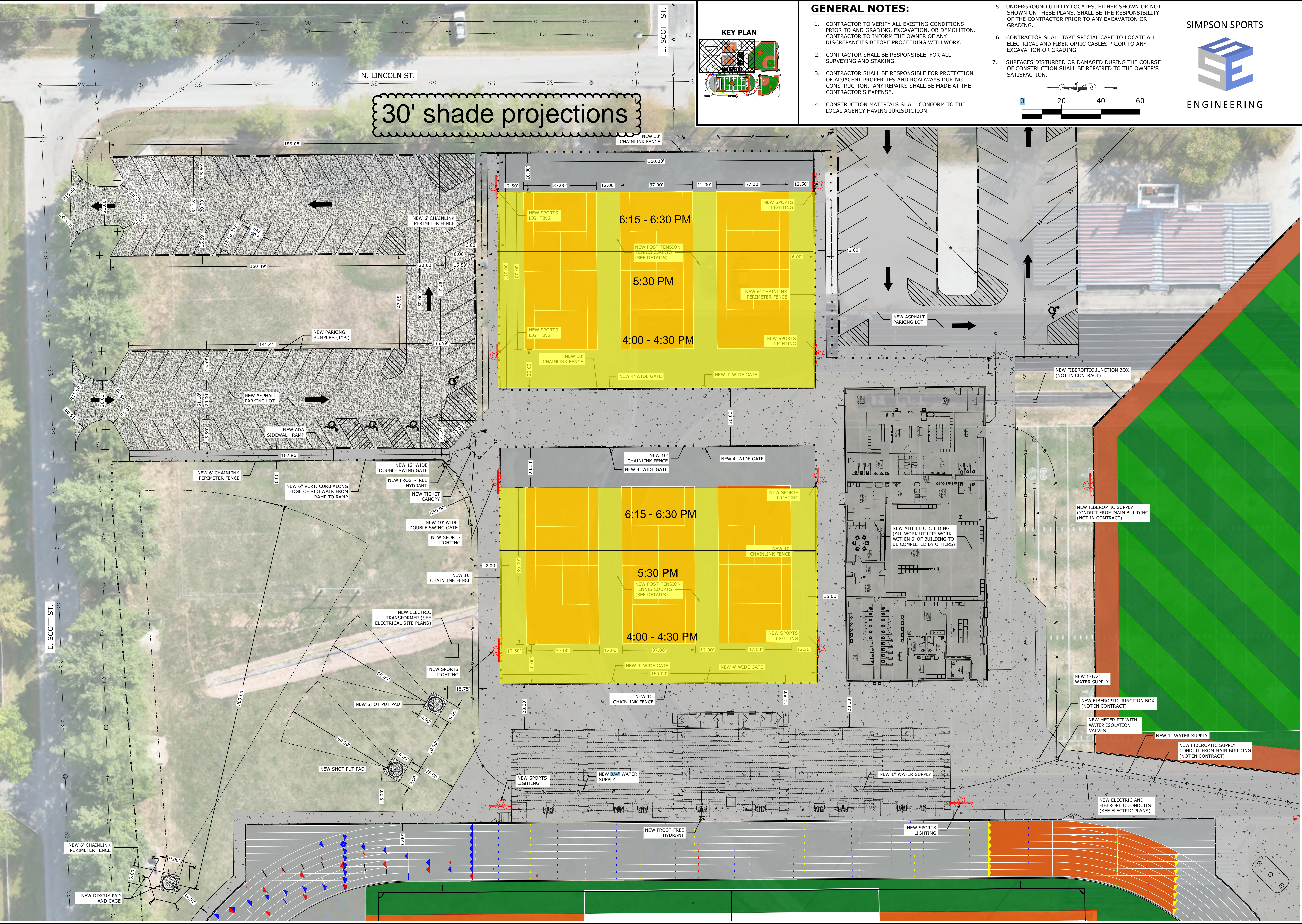

REVISIONS:

NO.	DATE	DESCRIPTION

**SITE IMPROVEMENT PLANS FOR  
RICHLAND COUNTY HIGH SCHOOL  
OLNEY, ILLINOIS**

DRAWN BY:  
DAS

JOB #: 025-036-MP

DATE: 3/17/2026

TENNIS COURTS  
AND PARKING  
LOT SITE PLAN

**30 ft screen height, 5.5 ft player eye height, and 20 ft runoff:**

**Key protection angles**

<b>Player location</b>	<b>Distance from screen</b>	<b>Screen protects when sun is below</b>
Near baseline	20 ft	~51°
Net / mid-court	59 ft	~22.6°
Opposite baseline	98 ft	~14°

**April 15 — Olney, IL**

<b>Time</b>	<b>Sun angle</b>	<b>30-ft screen impact</b>
7:34 AM	14°	Protects full court to opposite baseline
8:19 AM	22.6°	Protects to mid-court/net area
8:57 AM	30°	Partial protection only
4:49 PM	30°	Partial protection only
5:27 PM	22.6°	Protects to mid-court/net area
6:11 PM	14°	Protects full court to opposite baseline

**September 15 — Olney, IL**

<b>Time</b>	<b>Sun angle</b>	<b>30-ft screen impact</b>
7:49 AM	14°	Protects full court to opposite baseline
8:34 AM	22.6°	Protects to mid-court/net area
9:14 AM	30°	Partial protection only
4:21 PM	30°	Partial protection only
5:01 PM	22.6°	Protects to mid-court/net area
5:46 PM	14°	Protects full court to opposite baseline

**Bottom line**

A **30-ft vertical batter's-eye-style screen** is a feasible mitigation for the **worst low-angle sun**, especially:

- April 15: before **8:19 AM** and after **5:27 PM**
- September 15: before **8:34 AM** and after **5:01 PM**
- **The hours between 8:30 AM and 5:15 PM will have partial sun hitting some or all of the court.**

It does **not fully eliminate glare** during the broader morning/evening window when the sun is higher than  $\sim 22.6^\circ$  but still generally in the player's line of sight.



## Richland Co Tennis Court Layout (Original Design)

### Storm Sewer / Civil Related

- The layout was coordinated to minimize impacts to detention sizing, storm piping, inlet structures, and drainage routing.
- The design team evaluated the site holistically, balancing civil engineering constraints, parking efficiency, circulation, utility routing, and facility relationships, not simply court orientation alone.
- The east-west orientation was selected primarily to optimize overall site grading and stormwater conveyance across the athletic complex while maintaining compliance with stringent stormwater management requirements.
- The site has limited developable area due to detention, drainage, and water quality requirements, making overall hydraulic performance a governing design criterion rather than a standalone sport-orientation preference.

### Site Ergonomics

- The layout was coordinated with the nearby concessions/athletic support building to improve pedestrian flow, accessibility, parking lots, and event circulation between the courts and the rest of the complex. The configuration created efficient spectator and athlete access from the adjacent building and parking areas.
- The orientation allowed for two functional parking lots serving the tennis complex and surrounding facilities. Parking counts were an important consideration given the number of overlapping athletic events anticipated across football, baseball, softball, and tennis.
- The orientation was developed in conjunction with the overall athletic complex drainage strategy, including football, baseball, softball, parking, sidewalks, and spectator circulation.
- The current orientation improves constructability sequencing by maintaining efficient access routes for grading, paving, fencing, lighting, and surfacing contractors.
- The east-west orientation helped maximize spacing efficiency between facilities while maintaining ADA circulation and emergency access requirements.

- Due to the strict stormwater requirements, site drainage efficiency became a primary driver in determining facility orientation and layout. With some added infrastructure, we **can** facilitate the proposed orientation without sacrificing any storm sewer performance.

#### Final Result

10 less parking spaces

2 parking lots consolidated into 1.

1 less entry structure

North/South tennis courts