

Board of Education Regular Meeting  
Monday, June 10, 2024 7:00 PM  
Central Office Board Room  
401 South Pine Street  
Valley, NE 68064-0378

<b>1. Call to Order</b>	
<b>2. Public Communications and Correspondence</b>	<b>2</b>
<b>3. Approval of Agenda</b>	
<b>4. Administrative Reports</b>	<b>4</b>
4.1. Superintendent's Report	19
4.2. Financial Report	26
<b>5. Consent Agenda</b>	
5.1. Approve Minutes	33
5.2. Approve Claims for Payment	
5.3. Approve Financial Report	
5.4. Approve Classified Staff	
<b>6. New Business</b>	
6.1. Humanex Engagement Survey Results Presentation	
6.2. New Teacher Appraisal & Growth System Presentation	36
6.3. Elementary Playground Discussion	45
6.4. Approve Certificated Staff Positions	
<b>7. Adjournment</b>	

## Board of Education

Jamie Jorgensen

Bill Koile

Dr. Kelly Hinrichs

Elizabeth Mayer

Luke Janke

Jim Tomanek

Dr. Melissa Poloncic, Superintendent

Kristi Trost, Board Secretary

*This pamphlet has been developed to help the general public attending a meeting of the Board of Education to understand the internal operation of the Board. It is hoped that this pamphlet will foster improved relations between the Board and the citizens it serves.*

## Meetings of the Board

### When

- The Board of Education convenes once each month on the second Monday except in the months that have five Mondays. In months with five Mondays, the Board convenes on the third Monday of the month. Holidays and unexpected conflicts may create exceptions to this practice.
- The Board of Education will convene in special session whenever it is deemed necessary for the efficient operation of the school district.
- Board of Education meetings are called to order at 7:00 p.m. unless another time is stipulated.

### Where

- Regular and special meetings of the Board of Education will be held in the Board Room on the Valley Campus at 401 S. Pine St., in Valley, unless another location is specifically identified.
- Whenever public participation dictates the need for a larger meeting room, the Board will convene in the High School library.

### Notice of Meetings

- Official notice of the time and place of the regular board meetings are posted on the doors of the schools, banks in Valley and Waterloo and the Valley City Hall.
- Notice of special meetings will be posted at least 24 hours in advance. Hearings will be published in The Omaha Daily Record.

## Business of the Board

### Agendas

- Agendas for the regular meeting on the second Monday of the month will be prepared in advance and kept current and available in the superintendent's office. Business items of an emergency nature may be placed on the agenda by a majority vote of the Board of Education.
- Parents, employees and patrons may request items placed before the Board of Education for consideration by contacting the Superintendent at least three business days in advance of a regular meeting.

### Public Participation

- The Board of Education invites you to offer comments during the Public Communication and Correspondence portion of the meeting. Public requesting to offer comments during the Public Communication portion of the meeting shall make a request to speak or complete the sign-in information sheet at the meeting. The individual is asked to state the purpose and general nature of his or her appearance before the Board. The Board President shall indicate to the individual how much time the Board will allot the individual. Speakers normally will be given five minutes with a maximum of 20 minutes set aside for such communications.
- Members of the public requesting to speak to an item considered New or Old Business on the Agenda will request time during the Public Communications portion of the meeting. Unless the comments are related to an agenda item no action will be taken by the Board. Questions or requests of the Board by the public will be taken under consideration. The Board will direct the Superintendent, or the Superintendent's designee, to respond in writing to any public

question or request brought before the Board. Equal time shall be allotted to individuals speaking for and against a proposal when opposing points of view are represented at the board meeting.

- The Board invites you to share any information you may have or address any question to any Board member or the Superintendent regarding new business in the week prior to the next meeting.
- If, at any Board meeting, any person shall conduct himself or herself in a disorderly manner and after notice of the president or the person presiding shall persist therein, the president or person presiding may ask the person to leave and if the person refuses, the president or presiding officer may order any law enforcement officer or any other person or persons to take him or her into custody until the meeting is adjourned.
- Meetings may be recorded. Recording must be done so as not to disrupt the meeting.
- Meetings of the Board of Education shall be conducted in compliance with appropriate policy, state statutes and open meeting laws.

#### **Mission Statement**

**DC West Community Schools engages, prepares, and empowers all of our students for the future.**



The Douglas County West Community Schools does not discriminate on the basis of race, color, national origin, sex, disability, religion, age or other protected status in its programs and activities and provides equal access to the Boy Scouts and other designated youth groups. The following persons have been designated to handle inquiries regarding the non-discrimination policies:

**Students:** Superintendent of Schools, 401 S. Pine St., Valley, Nebraska 68064 (402-359-2583).

**Employees and Others:** Superintendent of Schools, 401 S. Pine St., Valley, Nebraska 68064 (402-359-2583).

Complaints or concerns involving discrimination or needs for accommodation or access should be addressed to the appropriate Coordinator. For further information about anti-discrimination laws and regulations, or to file a complaint of discrimination with the Office for Civil Rights in the U.S. Dept. of Education (OCR), please contact OCR at 8930 Ward Pkwy, Suite 2037, Kansas City, Missouri 64114, (816) 268-0550 (voice) or (877) 521-2172 (telecommunications device for the deaf) or [ocr.kansascity@ed.gov](mailto:ocr.kansascity@ed.gov).

## **Board Meeting Procedures**

*“Engage, Prepare, and Empower”*

**Douglas County West  
Community Schools  
P.O. Box 378  
401 S. Pine St.  
Valley, Nebraska 68064**

**DC West Elementary School:  
May 2024 Board Report  
Dr. Jeffrey Kerns**

**K-5 T&F Day**

I want to thank Mrs. Picht for working through multiple challenges on multiple days to provide a special experience for our kids. Our shared spaces where we normally hold Track and Field day were drastically impacted by the excess water. I really appreciate Mrs. Picht's dedication and commitment to making today memorable. Thank you to Mrs Bradley, Mrs. Beck, Dr. Acklie, Mrs. Erdman, and Mrs. Reeves for helping plan and run stations!



There will be several summer activities for students and families to participate in. Activities will be held in Waterloo and Valley in June and July on most Wednesdays.

**EXPLORE WITH US  
FREE SUMMER EVENTS  
SPONSORED BY DC WEST  
IN WATERLOO**

1:00PM TO 2:30PM

- JUNE 5 @ WATERLOO LIBRARY**  
EXPLORE WILDLIFE ENCOUNTERS
- JUNE 12 @ WATERLOO LIBRARY**  
EXPLORE BUBBLE MAKING
- JUNE 19 @ WATERLOO LIBRARY**  
EXPLORE UP, DOWN AND AROUND
- JUNE 26 @ WATERLOO LIBRARY**  
EXPLORE THIS IS HOW WE DO IT
- JULY 10 @ WATERLOO LIBRARY**  
EXPLORE CECE LOVES SCIENCE
- JULY 17 @ VWATERLOO LIBRARY**  
EXPLORE ICE CREAM MAKING

QUESTIONS?  
DR. DEE - FALCON FAMILY FACILITATOR  
402.669.0642

**EXPLORE WITH US  
FREE SUMMER EVENTS  
SPONSORED BY DC WEST  
IN VALLEY**

10:30AM TO 12:00PM

- JUNE 5 @ DC WEST ELEMENTARY**  
EXPLORE WILDLIFE ENCOUNTERS
- JUNE 12 @ DC WEST ELEMENTARY**  
EXPLORE BUBBLE MAKING
- JUNE 19 @ DC WEST ELEMENTARY**  
EXPLORE SCIENCE
- JUNE 26 @ VALLEY LIBRARY**  
EXPLORE FIREFIGHTERS
- JULY 10 @ VALLEY MUSEUM**  
EXPLORE VALLEY MUSEUM
- JULY 17 @ VALLEY LIBRARY**  
EXPLORE ICE CREAM MAKING

QUESTIONS?  
DR. DEE - FALCON FAMILY FACILITATOR  
402.669.0642

We celebrated our 5th graders' last day of elementary school with their families on May 23. Students had doughnuts and juice and enjoyed an end of the year video that Mr. Presler put together. Thank you to Mr. Presler for putting the video together for our students and their families to enjoy.



We had three Fridays of “RAD DADS” in May that were well attended by our community members. Students really enjoyed having our “RAD DADS” with us at recess!



Elementary students lined up the hallways as graduating seniors and 5th graders walked through the building for a final time!



EST 2005  
Thank you to the PTSA for hosting the End Of Year Bash on May 4th. Kids and families enjoyed snow cones, face painting, bounce houses and hot dogs!



Our partners from the Buffet Early Childhood Institute sent the metro's home visitors and family facilitators to DC West to learn about the many ways we support students and families in Valley and Waterloo.



We celebrated Arbor Day with the Mayor of Valley and the Tree Board.



This spring many of our teachers invited a family member to attend and participate in Morning Meetings.



We had step up day on May 14th, Kindergarten-5th graders were able to meet their new grade level teachers and learn more about the 2024-2025 school year!



### **June 2024 Special Education Report**

Hello! I hope you are all enjoying a great start to summer! The Special Education Department has been busy this month with finishing out the school year, planning for summer programming for students and professional development for teachers, and analyzing data for year-end reports and improvement planning purposes.

### **School Safety Updates and Planning**

The Administrative Team met last week to update our Emergency Operations Plan, and we also reviewed updates to our Reunification protocol and Crisis Response Team. A team of teachers and secretaries attended a training in March with the ILoveYouGuys Foundation on the Standard Reunification. We also participated in a reunification exercise. Since the training, we have built reunification kits for each building and have discussed and planned our own reunification practices so that we can implement them smoothly should the need arise.

The Crisis Response Team has transitioned to the Psychological First Aid Team. This team is comprised mainly of counselors, psychologists, and teachers. The purpose of the team is to stabilize psychological and emotional functioning after a crisis. This team participated in two days of training with NDE and is planning to attend another training in August at ESU 3. We also developed district procedures in alignment with recommendations from the Nebraska School Safety office so that we are prepared to respond if needed. The Admin team plans on providing brief training to all staff on the EOP, the SRM, the Standard Response Protocol, and Psychological First Aid in August.

### **School Handbook Update**

Cyndi Thomas, HS FCS Teacher, and I are working on developing a district certified and classified staff and students handbook component for building handbooks to ensure consistency and alignment with current laws and policies. We are using a template designed by our legal firm and hope to have a draft available within the next month.

### **Staffing Updates**

Mekenna Haahr, former elementary special education teacher, has accepted part-time employment as a high school special education teacher as a replacement for Nick Sims. Mekenna will work in the high school on Wednesdays, Thursdays, and Fridays each week, and will manage a partial student caseload. We are excited to welcome Mekenna back to the Falcon family!

Carleen Rietz has accepted part-time employment as a high school special education teacher replacing Ty Hansen. Carleen will work in the afternoons daily and manage a partial caseload. Carleen has extensive special education experience, most recently working with the Ombudsman program serving expelled and suspended students. Carleen also was a special education paraprofessional with the Westside Community Schools for several years. She is currently completing her special education endorsement through UNO. We are happy to welcome Carleen to the team!

We will transition both positions back to full-time for the 2024-2025 school year.

### **DC West NECounts Determination and Performance Report**

NDE makes an annual determination on the performance of each district on their compliance to federal special education statute (i.e. IDEA) and the outcomes of students ages 3-21 receiving special education services. This information is reported publicly on the NEP website effective June 1. DC West was again determined to “Meet Requirements” for our overall determination of effectiveness.

Strengths identified in our Performance Report included the following:

- 100% of students with disabilities were assessed.
- We met the state targets for the percent of students with disabilities achieving proficiency on the state reading and math assessments for 4th and 11th grades (based on 2022-2023 data).
- We did not suspend or expel students with disabilities at a disproportionate rate.
- 83% of our students participate in regular general education classes for at least 80% of the day.
- 100% of our preschool students with disabilities receive their services in a regular preschool setting.

Areas of focus for us to continue working on include:

- Chronic absenteeism among students with disabilities
- Improving proficiency and reducing the achievement gap for students with disabilities on the state reading and math assessments.
- Reducing the percentage of students served in more restrictive environments for a majority of their day, like resource rooms, self-contained classrooms, and special schools.

### **2024-2025 Targeted Improvement & Dissertation Focus**

The focus of our 2024-2025 Targeted Improvement Plan will be on Inclusive practices. Inclusive practices are important because students with disabilities have better learning and life outcomes when they learn alongside their general education peers to the greatest extent possible. Our hope is to have general and special education teaching partners participate in an Inclusive Practices Academy through ESU 3 this year, and I will be completing my doctoral dissertation in this area as well.

### **Dyslexia Data**

We are reporting data related to dyslexia evaluations to NDE for the first time this year. According to our data, our school psychologists evaluated 30 students with reading concerns to determine eligibility for special education this year. Fifteen of the 30 students qualified for specialized instruction in reading. In addition, 42 students in grades K-3 were placed on an Individualized Reading Intervention Plan (IRIP). According to MAP data, all 42 students made progress in reading.

Thank you for your continued support for our special education programming! Have a great summer!

Respectfully submitted,

Nicki Pechous, Ed.S.

Director of Special Education

Jim Knott

High School Board Report

High School Principal

June 10, 2024

The school year wound to a close for students with final exams on May 21-23. Teachers finished up on that Friday with one more contract day to work over the course of the summer. Since that time, we have gone into “summer mode” which includes updating handbook policies, preparing and supervising summer school, administrative meetings, and generally planning for the 2024/25 school year. I have also spent some time reflecting on the previous school year, noting areas for improvement, and setting professional goals for next school year.

Our summer school session at the high school began on Monday, June 6 and will run through Friday, June 24. The program includes 15 sessions from 8-11 in the morning. Students who need credit recovery are invited and must attend a minimum of 12 sessions. Katie Richards, Heather Cox, and Trey Baker are coordinating and teaching this year’s summer school. Our program is available only to DC West students and the cost is \$100. We have 14 high school students attending. New High School Counselor Katie Richards stated, “With this being my first year helping with summer school, it has been great to experience the process while getting to know a few of the students. Ms. Cox and Mr. Baker have a great system going and have been very helpful with getting the students and myself acclimated. The students in summer school have started the first week strong!”

As is the “new normal” in education, we have struggled to hire two high school special education teaching positions for next year. However, we have been able to meet our needs for next year and I wanted to give you a brief update on what it will look like. First, we have hired a high-quality half-time (actually .62 FTE) special education teacher for next year. Her name is Carleen Rietz and is a former high school para at Papillion-LaVista. We have also hired former DC West Elementary Special Education Teacher, Mekenna Haahr for three days a week. On the two days she is not here, long-term sub, Beth Reule will fill her schedule. To round out the changes, Middle School Special Education Teacher Lisa Masters will teach half days at the high school along half days in the middle school. Although it is more fragmented than usual, I believe we will continue to provide outstanding service to our special education students and families.



**Douglas County West  
Middle School Board Report June 2024  
Mr. Jeremy Travis**

**Enrollment as of 6/5/24**

6<sup>th</sup>-81

7<sup>th</sup>-66

8<sup>th</sup>-91

**Total DC West Middle School (238)**

Well, another year is winding down for us at the Middle School and summer school has just started for us this week. We have a lot to be proud of and celebrate in regards to this past school year. Coming into a new building and developing a high functioning educational environment was a joy to be a part of and help lead. The preparation for the upcoming school year continues to move forward with some proactive planning and some areas we continue to learn and grow in. I am continuing to bring closure to my Middle School Principalship and all of the year end items that come with that as well as continuing to help prepare the Middle School for the upcoming school year and the transition with Dr. Kerns and staff. The summer time tends to be much busier with tasks than the school year just at a little different pace. We have a great Team of Staff Members here at the Middle School so they will continue to do great things and I am going to looking forward to still collaborating with them all throughout the upcoming school year. Lots of really great memories and times that I am forever grateful for. We definitely tried to represent The Falcon Way in all that we did!

I have also been working heavily in the Director of Athletics and Activities position at both the MS/HS these past 5-6 weeks as there has been a lot of coordination and collaboration taking place. Here are some of the steps that have already been taken:

- Year End Team Athletic Celebration Night (Slide Show)
- Hiring of MS/HS Coaches and Sponsors for 2024-2025
- Scheduling Games, Activities, and Events for 2024-2025
- Collaboration Meeting with the Assistant AD's for the 2024-2025 school year
- Expectations Meeting with all current Coaches and Sponsors
- Meeting with Band and Choir to finalize their competition and concerts schedule for 2024-2025
- Meeting with Individual Programs Coaching Staffs as a whole to look over schedules for practices and games, to plan out in-season theme nights, to discuss their programs status (wants, needs, vision), as well as how I can support them throughout the year
- Updating the rSchool Calendar daily and attempting to get everything on there to help improve communication and as well as for planning purposes for 2024-2025
- Ordering of Uniforms that are due in the rotation cycle
- Completed the NCA Memberships for Coaches and Sponsors coordination
- Completed AED/CPR/First Aid Training for all Coaches and Sponsors with Cyndi Thomas and the Red Cross
- Coordination of the three NFHS courses that have to be completed by all Coaches and Sponsors once every 3 years
- Creation of SALT (Student Athletic Leadership Team) and coordination of speakers
- Attended the Year End Nebraska Capitol Conference Principal and AD Meeting

That is a quick snapshot as the list goes on but as a whole, just a lot of really good collaboration and conversations with coaches, sponsors, teachers, and administrators in partnership to help build upon our current athletic and activity programs. We want to be able to continue to create opportunities for our students to learn and grow and thrive in. There is a lot that still needs to be accomplished throughout the summer but we will get there one day at a time. Thank you all for your continued support!

We are still needing to hire the following areas for 2024-2025:

- Assistant MS/HS Band and Choir Teacher
- HS Head Baseball Coach
- (2) HS Assistant Baseball Coaches
- HS Assistant Boys Basketball Coach
- HS Assistant Girls Basketball Coach
- HS Assistant Track Coach

- MS Assistant Wrestling Coach

We will get there as there is growing interest out there to be a part of where we are at and where we are going here as a school and community at DC West.



**8<sup>th</sup> Grade Science Fair** was a big success at the end of the year for Mrs. Siekman's students!



**Middle School Spring Choir Performance** under the direction of Mrs. Dawn Beyl.



**Middle School Spring Band Performance** under the direction of Mrs. Liz Guinn.



**5<sup>th</sup> and 6<sup>th</sup> Grade Track & Field Day** got some great weather to compete in and enjoy.

We will continue to develop what **The Falcon Way** looks like at our Middle School as well as enrich it in the Athletics and Activities that we offer!

We are determined to continue to provide a safe and positive learning environment for all students and staff. Please feel free to contact me if you have any questions, if you want to see how things are going throughout the day, or if you have any concerns. I'm proud of what we do and who we are! Go Falcons!



**JEREMY TRAVIS**  
Director of Athletics & Activities (7-12)

**DC WEST** Community Schools  
Engage, Prepare, and Empower

📍 401 S. Pine Street  
Valley, NE 68064

📞 402.359.2583

✉ jtravis@dcwest.org

📧 @ DCWestFalcons

EST

2005

COMMUNITY SCHOOLS



**DC West Community Schools**  
**Board Report June 2024**  
**Dr. Dawn Marten - Director of Learning**

**Professional Learning:**

Once again this summer, we offered teachers various professional learning opportunities. Our dedicated teachers are taking advantage of the opportunity to grow as professionals to impact student achievement.

- Responsive Classroom promotes strong academic and social-emotional skills through the following characteristics: developmental responsiveness, engaging academics, positive community, and effective management. Responsive Classroom aligns with our District Strategic Plan Strategy 2.2: Provide social-emotional and behavioral support for all students in PreK-12 integrated through the MTSS model to realize the potential and resources accessible to benefit a unified student-centered learning initiative.
  - A second team of elementary teachers will participate in a week-long Responsive Classroom Training in Kansas City in June. ESSER funds make it possible to support this professional learning opportunity.
  - Our first middle school team will also participate in Responsive Classroom training in Iowa in June. ESSER funds and MOEC Attendance Improvement Grant will fund this professional learning opportunity.
- The other professional learning opportunities that teachers will participate in are:
  - Middle School Math Department: Curriculum development and alignment
  - Middle School PRIDE Planning: Grade-level PRIDE lesson development. Our new SEBL curriculum, Second Step, will be used as a resource.
  - Middle School MTSS: Grade-level MTSS lesson development to meet the varying student needs during the MTSS time block.
  - High School CTE: Lesson development

**NSCAS Data:**

The state assessment, NSCAS, for Grades 3-8 was completed in Reading and Math and Science for Grades 5 & 8. The state is in the process of finalizing the data and creating reports over the summer. I will share our achievement data at the August Board Meeting and use eduClimber to demonstrate our areas of strength and opportunity. At that time, we will also analyze trend data along with MAP data comparison.

Superintendent  
Director of Learning  
Director of Special Education  
Elementary Principal  
Middle School Principal  
High School Principal  
High School Assistant Principal/AD

Dr. Melissa Poloncic  
Dr. Dawn Marten  
Nickj Pechous  
Dr. Jeffrey Kerns  
Jeremy Travis  
Jim Knott  
Nathan Ter Beest

402.359.2583  
402.359.2583  
402.359.2583  
402.359.2151  
402.779.2646  
402.359.2121  
402.359.2121



# DC WEST Community Schools

Engage, Prepare, and Empower

## Superintendent's Report June 10, 2024

### ESSER Funds Update

We are ending our window of ESSER Funds that have been available for the past few years post pandemic. These funds have assisted us greatly in the purchasing of new curriculum, professional development opportunities, technology purchases, and supporting mental health efforts. ESSER I funds were expended and reimbursed in 2021. ESSER II funds were expended and reimbursed by 2023. We are completing our spending of ESSER III funds and will apply for reimbursement in the Fall of 2024. This summer we will finish ESSER III funds with professional development and technology hardware reimbursement. The following is a summary of ESSER II & III funds and their uses:

6.10.24			
ESSERS II (to be expended by September 2023)	Budget	Spent	
Summer Professional Development Stipends	\$ 161,295.00	\$ 161,295.00	
Technology (Ipads)	\$ 48,630.00	\$ 48,630.00	
Curriculum and Intervention Materials	\$ 63,820.00	\$ 63,820.00	
Misc. Services	\$ 56,757.00	\$ 56,757.00	
<b>Balances</b>	<b>\$330,502.00</b>	<b>\$330,502.00</b>	
ESSERS III (to be expended by August 2024)	Budget	Spent to date	Balance
Stipends & Benefits	\$29,600	\$ 44,265.45	(\$14,665.45)
Technology	\$144,000		\$144,000.00
Curriculum and Intervention Materials & Prof. Dev.	\$549,179	\$ 546,228.85	\$2,950.15
Mental Health Services	\$20,750	\$ 31,648.14	(\$10,898.14)
<b>Balances</b>	<b>\$743,529</b>	<b>\$ 622,142.44</b>	<b>\$121,386.56</b>
**All budgets may be amended at any time if need is determined			

### DC West Sports Complex Design Progress

The design team continues to meet and refine the design and budget of the sports complex. Currently, the architect and civil engineer are completing design documents for the early grading bid package expected to release for bid mid to late June in order to have a possible GMP from MCL on the grading package by the July 8th Board meeting. Earthwork could begin late summer. Toward the end of July, the design and budget will be finalized and be closer to a GMP for the overall project sometime in August. I would like to meet with the buildings and grounds committee to review proposed value analysis options recently proposed by the design team.

## **HUMANeX Community Leadership & Education Summit in Omaha**

Most of our administrative team will be attending the [Community Leadership & Education Summit](#) on June 26-27. This will be a tremendous team opportunity and professional development on leadership right here in our backyard. If you would be interested in attending with us as a board member, we do have a couple of spots available at our table.

## **Legislative Recap**

I have included with my report this month, a recap of legislation provided by our legal counsel. The communication is not a comprehensive analysis but more an informative guide on the impact of this last legislative session and the school laws that impact us as a school district. I believe you will find the memo informative.

## **Middle School & Fine Arts Bond Project Finishes Under Budget**

Our final pay apps have been processed on our middle school & fine arts addition that opened in 2023. I am pleased to share with the Board that we completed the project \$50,000 under the projected budget. The addition has provided endless opportunities for our students. We thank our Board and community support for the project passed by bond in 2021.

## **Superintendent Goals 2024**

- Lead the vision and support needed to implement strategic plan priorities & Superintendent goals in 2024 and provide more timely, ongoing, and detailed information about progress to the Board of Education.
- Engage in the design, development, and construction of the new outdoor facilities complex.
- Complete the adoption and implementation of a new certified staff and administrator evaluation system as well as implement new electronic management for personnel evaluation.
- Continue to unify building leadership and communicate to all levels consistently.
- Research, study, and implement strategies to manage the growth of the communities and district in the next five to ten years so we are proactive rather than reactive. This may include a facility and enrollment study.
- Keep abreast of regular building and grounds issues as the campus expands.

## **Upcoming Dates:**

**June 3-20~** Summer School

**June 25~** Melissa hosting Greater Nebraska Superintendent's Retreat at DC West

**June 26-27~** DC West Administrative Team at the Humanex Community Leadership & Education Summit at Baxter Arena

**July 8~** Regular Board of Education Meeting

James B. Gessford  
Daniel F. Kaplan  
Gregory H. Perry  
Joseph F. Bachmann\*  
R. J. Shortridge\*  
Joshua J. Schauer\*  
Derek A. Aldridge\*\*  
Justin J. Knight\*\*\*  
Charles Kaplan  
Haleigh B. Carlson  
Sara J. Tonjes



PERRY, GUTHERY, HAASE & GESSFORD, P.C., L.L.O.

Of Counsel  
Thomas M. Haase

\*Also admitted in Iowa  
\*\* Also admitted in Kansas  
\*\*\*Also admitted in Colorado

Ernest B. Perry (1876-1962)  
Arthur E. Perry (1910-1982)  
R.R. Perry (1917-1999)  
Edwin C. Perry (1931-2012)

## LEGISLATIVE RECAP MEMO

The Nebraska Legislature has been active the past two years, especially in the area school law. This Memorandum covers the general legal (and practical) requirements from this past legislative session. Note that this is a not a comprehensive analysis of every facet of every school law-related bill. Instead, this Memorandum is intended to serve as a guide to help schools prepare to comply with these new requirements over the upcoming summer months.

### A. Option Enrollment

LB 1329 changes Nebraska's option enrollment laws. Under the new law (effective during the 2024-2025 school year), a student may option once during elementary school, once during middle school or junior high school, and once during high school for a total of three times, subject to certain exceptions. The law does not address retroactive option students (including those students who have already optioned and want to option again) or who will track a student's total number of options. Nonetheless, this law ends Nebraska's traditional rule of one option per student.

In addition, LB 1329 changes the procedures for students optioning into and from districts. Under the new law, if a student is an option student, the student needs a release only from the option district (instead of the student's resident district). This change removes the student's resident district from option decisions if the student is an option student.

### B. Training

LB 1329 softened the training requirements for the statute's mandated trainings. Instead of a defined amount of time (such as one hour), the identified trainings need only be as long as the School Board reasonably determines. This development will require each School Board to approve the trainings identified by the administration. As a result, we recommend the following be added to the July or August Board agenda each year to make sure the Board approves as reasonable the required staff trainings:

*Agenda Item:* Review, consider, and approve the required staff trainings, as presented, as reasonable in length of time.

*Motion Language:* I move to approve the required staff trainings, as presented, during the 2024-2025 school year as reasonable and appropriate for the District.

**C.     Preschool**

LB 71 will allow kindergarten-eligible students to remain in preschool. This new law initially conflicts with current NDE Rule 11, though NDE has stated that it intends to revise Rule 11 in response to LB 71. To be sure: the new law allows schools to continue kindergarten-aged students in preschool. But the new law does not require a school to serve a student beyond age five. For Districts already at preschool capacity, it may be easier to adopt a policy that states that the preschool program is at capacity and will not allow kindergarten-aged students to remain in preschool. For Districts open to allowing kindergarten-aged students to continue in preschool, a different policy may be appropriate to identify the priorities for preschool enrollment.

**D.     Truancy**

LB 1329 revises the truancy statutes to add a firm deadline for schools to provide services to address barriers for a student's attendance. Under the new law, once a student has missed twenty days of school, the school is required to write to the parents about the student's excessive absences and meet with the parents or guardians to address the excessive absences. In addition, from now on, any educational evaluations must be agreed to by the student's parent or guardian before the school initiates an educational evaluation.

**E.     LB 304**

LB 304 requires each school district to post on its website each (1) organization to which the board belongs and those dues; and (2) fees paid to any lobbyists (other than those dues paid to organizations). To be clear, this requirement only applies to the organizations and associations that the school board (not individual employees) belong, even if the board pays an employee's membership dues directly.

LB 304 does not include dates or timeframes, so the law does not make clear how far back the board needs to list its organizations and lobbyist dues, or whether the website needs to be updated after each board meeting, and so forth.

In light of this uncertainty, the following is sample language that you could use to list the board's memberships on your website:

*The Board of Education is a member of the following organizations and associations and pays the corresponding amounts as dues to each organization or association: [List organizations]*

*The Board of Education has paid the following amount to an individual lobbyist or lobbying firm over the past 12 months: [Insert amount]*

**OR**

*The Board of Education does not pay any fees to any individual lobbyist or lobbying firm.*

*This information will be updated periodically. Any interested person is encouraged to review the Board Meeting agendas and minutes for any updates.*

#### **F. FAFSA**

Last year, LB 705 implemented the FAFSA requirement for graduation. NDE has circulated the opt-out form for those students who do not want to complete the FAFSA. One of the three bases for a student opt-out is if the principal determines that “good cause” exists to excuse the student from completing the FAFSA. The law does not define what constitutes “good cause.” In light of the ongoing FAFSA issues, it is possible that some schools may need to determine that “good cause” exists for delays in the FAFSA process itself. Although this concern may be premature, schools would be wise to use the summer months to determine how this FAFSA process will be tracked for all students—particularly in larger districts with hundreds of high school students.

#### **G. Retention**

LB 71 gives parents more authority to require their student to retake a grade level. For students in grades kindergarten through fourth grade, a parent may require their student retake a grade level if the student meets one of the following qualifications: (1) academic needs, (2) illness, or (3) excessive absenteeism. Students in grades 5 through 12 may only be retained by the parent due to excessive absenteeism. Since these qualifications for retention must occur during the school year, and the parents must follow the process outlined in the new law before retaining their student, students are likely only able to be retained by parents beginning in the 2025-2026 school year.

#### **H. Open Meetings Act**

LB 43 requires that public comment be allowed at every board meeting, beginning July 19, 2024. This new public comment requirement includes special meetings, retreats, workshops, hearings, interviews, and the like. All other reasonable rules for public comment (including time limits) remain in place, and those rules could be different for regular meetings and all other meetings. This will be a decision that each board will need to make to comply with the new law.

In addition, LB 287 eased the newspaper publication requirements. From now on, if a newspaper refuses, neglects, or is unable to timely publish notice of a board meeting, then the board may give notice by (1) posting the notice on the newspaper's website (if available) and (2) posting the notice in conspicuous places within the district. This is a helpful tool in case your newspaper does not or cannot publish a notice on time.

### **I. Records Requests**

Under current law, any person in the world could submit a public records request and be entitled to the first four hours of staff time spent responding to the request. If the school anticipated the records request requiring more than four hours of staff time, the school could require the requester to submit a deposit for the staff time in excess of four hours. LB 43 significantly changes this process. Beginning July 19, 2024, any Nebraska residents and news media (regardless of location) are entitled to the first eight hours of staff time for free. In addition, non-residents will no longer be entitled to any free time, so third party vendors (like SmartProcure and OpenTheBooks) will be required to pay for all records requests.

With that being said, the new law does not define how a school should determine a resident or non-resident requester. As part of the new records request process, schools should begin planning to request residency information in response to a records request where the domicile of the requester is not known.

### **J. Purchasing**

LB 1300 imposed new requirements to ensure that no public technology contracts (including contracts with public schools) are awarded to any "scrutinized company" (companies operated or owned by foreign adversaries). The following language could be used for technology contracts to meet the new law's requirements:

*Pursuant to federal and state law, the Company hereby certifies that: (1) the Company is not a "scrutinized company" (as defined by state and federal law); (2) the Company will not subcontract with any "scrutinized company" for any aspect of the performance of this Agreement; and (3) that any products or services to be provided under this Agreement do not originate with any "scrutinized company." The Company agrees to immediately notify the School District if anything in this certification is no longer accurate.*

### **K. Contracting with Self**

LB 287 adds a new conflict of interest provision for public employees. Under these new parameters, any public employee whose annual salary and benefits totals at least \$150,000 may not use their official duties to financially benefit themselves or their family. Evidently, a situation arose in a Nebraska city where a city council gave the city manager the authority to enter into contracts for up to a certain amount of money. That city manager then apparently contracted with an immediate family member that, in the end, financially benefitted the city manager. In response, the Legislature amended the conflict of interest statutes to prohibit this type of arrangement. As a standard rule for school administrators, any contract that would financially benefit the administrator or administrator's immediate family (like hiring a spouse's company to mow the school lawn in the summer) should be approved by the Board of Education (instead of the administrator unilaterally signing the contract).

## Financial Recap May 2024

	5/1/2024	Receipts	Expenditures	5/31/2024
<b>General Fund</b>	\$6,178,304.80	\$1,882,639.89	\$1,337,335.62	\$6,723,609.07
<b>Depreciation Fund</b>	\$1,800,678.69	\$1,535.62	\$0.00	\$1,802,214.31
<b>Food Service Fund</b>	\$121,125.23	\$71,267.13	\$81,235.95	\$111,156.41
<b>Qualified Capital Fund</b>	\$308,153.56	\$68,943.46	\$2,995.00	\$374,102.02
<b>Bond Fund</b>	\$1,198,034.09	\$161,349.21	\$292,875.00	\$1,066,508.30
<b>Special Building Fund</b>	\$1,315,173.84	\$296,214.02	\$0.00	\$1,611,387.86
- Special Bldg (MS/Fine Art)	\$0.00	\$0.00	\$0.00	\$0.00
	<b>\$10,921,470.21</b>	<b>\$2,481,949.33</b>	<b>\$1,714,441.57</b>	<b>\$11,688,977.97</b>

### General Fund Detail

	<u>Expenditures</u>			<u>Revenues</u>		
	May	YTD	Budgeted	May	YTD	
All Instructional Program	\$ 622,712.41	\$ 5,339,829.96	\$ 7,920,584.00	Personal and Prop Taxes	\$ 948,521.54	\$ 6,281,860.28
SPED Instructional Program	\$ 203,063.13	\$ 1,600,519.67	\$ 2,275,632.00	Carline Tax	\$ 6,056.17	\$ 129,551.33
Support Services SPED Related	\$ 29,854.87	\$ 296,477.53	\$ 403,158.00	Motor Vehicle Taxes	\$ 114,495.04	\$ 910,394.98
Support Services Non-SPED Related	\$ 42,132.17	\$ 380,216.88	\$ 484,821.00	Facility Rental	\$ -	\$ 700.00
Support Instructional	\$ 76,109.42	\$ 739,156.73	\$ 856,582.00	Tuition Received from Individuals	\$ 11,535.05	\$ 83,059.99
Board of Education	\$ 6,793.19	\$ 66,513.73	\$ 92,700.00	Interest	\$ 6,374.11	\$ 41,933.74
Executive Administration Services	\$ 28,070.94	\$ 285,384.50	\$ 399,286.00	Local License Fees	\$ -	\$ 5,271.00
District Legal Services	\$ 2,884.43	\$ 36,723.00	\$ 35,000.00	Other Local Receipts	\$ 640.44	\$ 110,401.72
Office of the Principal	\$ 71,812.08	\$ 613,958.29	\$ 828,608.00	Grants from Corporations/Private	\$ -	\$ 16,461.42
General Admin - Business Services	\$ 19,059.60	\$ 210,256.73	\$ 311,452.00	County Fines and License Fees	\$ 1,835.08	\$ 17,103.44
Maint & Operation of Building & Sit	\$ 127,454.27	\$ 1,336,825.18	\$ 1,795,631.00	ESU Receipts	\$ -	\$ 4,793.00
Vehicle Acquisition & Maint	\$ -	\$ 4,200.00	\$ 15,200.00	State Aid	\$ 274,478.00	\$ 2,470,302.00
Regular Pupil Transportation	\$ 36,189.86	\$ 361,533.88	\$ 505,400.00	Special Education Programs	\$ 187,864.00	\$ 1,121,408.00
SPED Pupil Transportation	\$ 8,728.94	\$ 88,088.23	\$ 173,760.00	Special Education Transportation	\$ -	\$ -
Categorical Grant from Coporation	\$ 17,615.00	\$ 89,170.87	\$ 134,908.00	Homestead Exemption	\$ 24,413.25	\$ 73,239.75
State Categorical Programs	\$ 10,957.23	\$ 98,352.62	\$ 146,804.00	Pro-Rate Motor Vehicle	\$ -	\$ 14,429.11
Federal Programs	\$ 32,857.76	\$ 299,590.31	\$ 418,024.00	High Ability Learners	\$ -	\$ 9,498.00
ESSER II & III	\$ 1,040.32	\$ 54,333.14	\$ 439,612.00	Early Childhood Grant	\$ -	\$ 62,459.21
	<b>\$ 1,337,335.62</b>	<b>\$ 11,901,131.25</b>	<b>\$ 17,237,162.00</b>	State Apportionment	\$ -	\$ 168,850.84
				Other State Receipts	\$ -	\$ 7,500.00
				Prop & Personal Property Tax Credit	\$ 296,128.21	\$ 593,282.70
				Title ESSA Programs	\$ 9,824.00	\$ 151,869.00
				IDEA Programs	\$ -	\$ 261,978.00
				Medicaid	\$ -	\$ 28,520.54
				ESSER II & ESSER III	\$ -	\$ 330,502.00
				Other Federal Categorical Receipts	\$ -	\$ 6,030.00
				Sale of Property	\$ 475.00	\$ 46,115.75
				Insurance Adjustment	\$ -	\$ -
					<b>\$ 1,882,639.89</b>	<b>\$ 12,947,515.80</b>

### May 2024 Payroll

Net Payroll	\$ 597,319.82
Payroll Taxes (District)	\$ 151,093.61
Payroll Withholding (Employees)	\$ 64,183.93
Retirement (District)	\$ 80,025.80
Retirement Withholding (Employees)	\$ 79,233.56

Activity Fund Balance Report - Summary - Exclude Encumbrances  
05/2024 - 05/2024

Regular; Beginning Month 05/2024; Processing Month 05/2024; Accounts to Include Accounts with Activity; Fund Number 05, 12

Fund: 05 ACTIVITY FUND

<u>Chart of Account Number</u>	<u>Chart of Account Description</u>	<u>Beginning Balance</u>	<u>Expenses</u>	<u>Revenues</u>	<u>Balance Change</u>	<u>Balance</u>
05 704	INTEREST	2,189.62	0.00	125.04	0.00	2,314.66
05 704 1001	ACTIVITY PASSES	11,415.64	0.00	0.00	0.00	11,415.64
05 704 1002	CORPORATE SPONSORSHIPS	3,268.99	0.00	0.00	0.00	3,268.99
05 704 1003	INSTRUMENTAL MUSIC	522.92	101.00	2,396.00	0.00	2,817.92
05 704 1004	HS DC WEST TRAVEL	0.00	0.00	239.70	0.00	239.70
05 704 1005	STAFF LOUNGE	1,843.72	0.00	65.16	0.00	1,908.88
05 704 1007	VALLEY WAY	11,619.23	1,649.00	0.00	0.00	9,970.23
05 704 1011	PTSA DONATION	4,117.70	0.00	0.00	0.00	4,117.70
05 704 1022	SENIOR CLASS	923.12	945.00	0.00	0.00	(21.88)
05 704 1023	PROM	2,592.34	0.00	0.00	0.00	2,592.34
05 704 1102	ARTS & HUMANITIES	621.33	0.00	0.00	0.00	621.33
05 704 1104	ATHLETICS HS	12,004.72	5,052.00	315.00	0.00	7,267.72
05 704 1106	BASEBALL TEAM	1,562.98	588.43	0.00	0.00	974.55
05 704 1107	BAND	1,052.45	0.00	1,440.00	0.00	2,492.45
05 704 1108	CHEER	7,266.16	200.00	7,668.74	0.00	14,734.90
05 704 1111	BBB TEAM	778.17	376.91	3,420.00	0.00	3,821.26
05 704 1112	CONCESSIONS	41,893.06	4,586.11	0.00	0.00	37,306.95
05 704 1113	CONSTRUCTION TECH	7,106.79	0.00	0.00	0.00	7,106.79
05 704 1114	DANCE TEAM	1,585.95	0.00	210.00	0.00	1,795.95
05 704 1116	DRAMA	5,816.23	0.00	38.00	0.00	5,854.23
05 704 1117	FBLA	2,018.72	0.00	0.00	0.00	2,018.72
05 704 1118	HIGH SCHOOL	73.74	0.00	0.00	0.00	73.74
05 704 1119	DC TECH 1:1	35,247.23	4,386.00	390.00	0.00	31,251.23
05 704 1120	GBB TEAM	3,894.94	1,920.00	1,375.00	0.00	3,349.94
05 704 1123	HOSA	3,608.62	0.00	0.00	0.00	3,608.62
05 704 1124	STUCO HS	3,033.80	961.97	562.00	0.00	2,633.83
05 704 1128	NATIONAL HONOR SOCIETY	1,603.38	576.49	104.00	0.00	1,130.89
05 704 1131	FOOTBALL TEAM	3,073.04	0.00	0.00	0.00	3,073.04
05 704 1132	SCIENCE CLUB	427.19	0.00	0.00	0.00	427.19
05 704 1133	SPEECH TEAM	2,644.88	0.00	0.00	0.00	2,644.88
05 704 1134	VOCAL MUSIC	3,959.34	0.00	12.50	0.00	3,971.84
05 704 1136	WORLD LANGUAGE CLUB	304.27	0.00	0.00	0.00	304.27
05 704 1137	ROBOTICS TEAM	3,369.08	0.00	0.00	0.00	3,369.08
05 704 1141	GOLF TEAM	84.88	0.00	0.00	0.00	84.88
05 704 1142	YEARBOOK HS	3,815.57	0.00	50.00	0.00	3,865.57
05 704 1151	CROSS COUNTRY TEAM	1,975.43	0.00	0.00	0.00	1,975.43

Regular; Beginning Month 05/2024; Processing Month 05/2024; Accounts to Include Accounts with Activity; Fund Number 05, 12

**Fund: 05      ACTIVITY FUND**

<u>Chart of Account Number</u>	<u>Chart of Account Description</u>	<u>Beginning Balance</u>	<u>Expenses</u>	<u>Revenues</u>	<u>Balance Change</u>	<u>Balance</u>
05 704 1161	SOFTBALL TEAM	3,427.50	0.00	0.00	0.00	3,427.50
05 704 1166	BOYS TRACK TEAM	327.33	0.00	0.00	0.00	327.33
05 704 1167	GIRLS TRACK TEAM	800.69	0.00	0.00	0.00	800.69
05 704 1176	VOLLEYBALL TEAM	4,650.59	1,743.85	2,120.50	0.00	5,027.24
05 704 1186	WRESTLING TEAM	895.67	0.00	0.00	0.00	895.67
05 704 1198	SUMMER SPORTS CAMPS	598.12	0.00	0.00	0.00	598.12
05 704 1199	CHANGE BAGS	(1,620.00)	0.00	0.00	0.00	(1,620.00)
05 704 1222	SCIENCE GRANT	3,055.68	0.00	0.00	0.00	3,055.68
05 704 1224	STUCO MS	13,354.27	534.50	0.00	0.00	12,819.77
05 704 1225	COFFEE CART - EL SPED	1,551.40	0.00	25.00	0.00	1,576.40
05 704 1319	DISNEY MUSICAL	15,203.93	0.00	0.00	0.00	15,203.93
05 704 1320	PRESCHOOL	12,081.18	565.59	0.00	0.00	11,515.59
05 704 2112	MS CONCESSIONS	2,603.92	0.00	0.00	0.00	2,603.92
05 704 2121	MS BBB TEAM	211.05	0.00	0.00	0.00	211.05
05 704 2136	MS FOOTBALL TEAM	368.47	0.00	0.00	0.00	368.47
05 704 2201	ART CLUB MS	207.14	0.00	0.00	0.00	207.14
05 704 2204	ATHLETICS MS	0.00	138.00	0.00	0.00	(138.00)
05 704 2205	UNIFIED SPORTS	438.23	0.00	34.00	0.00	472.23
05 704 2216	MS DRAMA	96.47	0.00	0.00	0.00	96.47
05 704 2218	MIDDLE SCHOOL	1,398.04	862.00	1,325.00	0.00	1,861.04
05 704 2242	MS YEARBOOK	3,639.84	670.36	0.00	0.00	2,969.48
05 704 3220	ELEM FIELD TRIP	3,797.69	2,422.00	633.05	0.00	2,008.74
05 704 3221	PBIS/FALCOIN	3,137.11	0.00	760.42	0.00	3,897.53
05 704 3222	BATTLE OF THE BOOKS	39.50	0.00	66.00	0.00	105.50
05 704 3318	ELEMENTARY	4,782.21	0.00	666.77	0.00	5,448.98
Fund Total: 05		262,361.26	28,279.21	24,041.88	0.00	258,123.93

Regular; Beginning Month 05/2024; Processing Month 05/2024; Accounts to Include Accounts with Activity; Fund Number 05, 12

**Fund: 12      STUDENT FEES**

<u>Chart of Account Number</u>	<u>Chart of Account Description</u>	<u>Beginning Balance</u>	<u>Expenses</u>	<u>Revenues</u>	<u>Balance Change</u>	<u>Balance</u>
12 704	STUDENT PARTICIPATION FEE	23,343.98	0.00	0.00	0.00	23,343.98
Fund Total: 12		23,343.98	0.00	0.00	0.00	23,343.98

06/06/2024 05:59 AM

JUNE 2024 BOARD BILLS

User ID: CQ

Vendor Name	Vendor Description	Amount
Checking Account ID 1	Fund Number 01 GENERAL FUND	
360 COMMUNITY SERVICES		3,158.70
AMAZON CAPITAL SERVICES		1,467.73
APPLE COMPUTER INC		1,329.00
ARROW STAGE LINES		3,148.00
AWARDS UNLIMITED INC		354.71
BORDER STATES INDUSTRIES INC		1,556.41
BSN SPORTS LLC		594.54
CAPPEL NAPA AUTO SUPPLY - VALLEY		73.42
CINTAS CORP		437.55
CITI CARD - COSTCO		153.01
CITY OF VALLEY		1,260.75
DAILY RECORD, THE		334.66
DC WEST FOOD SERVICE		1,442.28
DIETZE MUSIC HOUSE		407.10
EAGLE SERVICES INC.		545.56
EDUCATIONAL SERVICE UNIT #3		5,616.47
EGAN SUPPLY CO		5,041.01
ESU COORDINATING COUNCIL		655.56
FIBER PLATFORM, LLC		560.78
FIRST STUDENT		55,875.00
HEARTLAND PEST CONTROL		260.00
HOMETOWN LEASING		2,522.27
JOSTENS INC		25.40
JUST FOR KIDS THERAPY INC		11,903.25
MATHESON TRI-GAS INC		1,049.44
MENARDS - ELKHORN		242.50
MILLARD SPRINKLER INC		858.00
MY CENTRAL SUPPLY		409.05
NEBR DEPARTMENT OF EDUCATION		250.00
NEBRASKA TURF PRODUCTS		1,389.70
ODEY'S INC		636.00
OMAHA WORLD-HERALD		2,700.00
ONE SOURCE		974.00
PERRY GUTHERY HAASE & GESSFORD		1,792.00
PITNEY BOWES GLOBAL FINANCIAL SERVICES LLC		96.00
POSTMASTER		120.00
PRAIRIE MECHANICAL CORP		7,787.29
PUBLICATION PRINTING		362.00
SECURITY EQUIPMENT INC.		10,771.50
SHERWIN-WILLIAMS CO		1,224.97
STEVE WEISS MUSIC		131.95
STUDIES WEEKLY, INC		2,498.93
TEACHING STRATEGIES LLC		1,690.00
VALLEY ACE HARDWARE		604.02
WASTE CONNECTIONS OF NEBR, INC		1,140.39
WATER ENGINEERING INC		6,199.72
ZOOM VIDEO COMMUNICATION, INC.		4.69
Fund Number 01		<u>141,655.31</u>

Checking Account ID 6	Fund Number 06 NUTRITION FUND	
CANTEEN REFRESHMENT SERVICES		223.74
CASH-WA DISTRIBUTING		13,165.93
CHESTERMAN CO	30	337.35
CINTAS CORP		706.44

06/06/2024 05:59 AM

JUNE 2024 BOARD BILLS

User ID: CQ

Vendor Name	Vendor Description	Amount
HILAND DAIRY		4,751.44
ROTELLA'S ITALIAN BAKERY INC		631.45
SYSCO LINCOLN		6,726.51
US FOOD INC		14,306.21
Fund Number 06		<hr/> 40,849.07

06/06/2024 12:01 PM

MID MONTH BILLS - MAY / JUNE 2024

User ID: CQ

Vendor Name	Vendor Description	Amount
Checking Account ID 1	Fund Number 01 GENERAL FUND	
ACH BANK FEE		61.25
CYBER INNOVATION CENTER		50.00
LOVE'S TRAVEL STOPS & COUNTRY STORE		1,669.36
MADISON NATIONAL LIFE INS CO IN		2,877.34
MAGIC WRIGHTER E-SERVICE		283.75
OMAHA PUBLIC POWER DISTRICT		20,137.54
PORKY BUTTS BBQ		1,664.50
SHEPPARD'S BUSINESS INTERIORS INC		8,781.87
SOKOL CAMP ASSOCIATION		75.00
VISION SERVICE PLAN		314.69
Fund Number 01		<hr/> 35,915.30
Checking Account ID 1		<hr/> 35,915.30

**MINUTES OF THE REGULAR MEETING OF THE BOARD OF  
EDUCATION OF DOUGLAS COUNTY SCHOOL DISTRICT 28-0015,  
a/k/a, DOUGLAS COUNTY WEST COMMUNITY SCHOOL DISTRICT  
Monday, May 13, 2024**

The regular meeting of the Board of Education, District #15, in the County of Douglas, in the State of Nebraska, was convened in open and public session on Monday, May 13, 2024 at the Central Office Board Room, 401 South Pine Street, Valley, NE 68064-0378.

Following public notification procedures approved by the Board of Education, February 14, 2011, in adherence to 84-1411, notice of the meeting was given in advance thereof by posting such Notice on the exterior front door of the high school, elementary school, middle school, Valley City Hall, First Nebraska Bank, and Foundation One Bank. Notice of the meeting was simultaneously given to all members of the Board of Education. Availability of the agenda was communicated in advance notice and in the notice to the Board of Education of the meeting. All proceedings hereafter shown were taken while the convened meeting was open to the attendance of the public.

Attendance Taken at 7:00 PM.

Kelly Hinrichs: Present  
Luke Janke: Present  
Jamie Jorgensen: Present  
Bill Koile: Present  
Elizabeth Mayer: Present  
Jim Tomanek: Present

Present: 6.

**1. Call to Order**

The agenda, listing items for consideration by the Board, is on file in the Superintendent's office. Other matters may come before the Board and the Board has the right to modify the agenda before the meeting.

President – "As I call the meeting to order I wish to inform everyone present that a current copy of the Open Meetings Act is posted on the back wall of the Board Room for your review at any time."

**2. Public Communications and Correspondence**

Comments from the audience were accepted at this time. Correspondence addressed to the Board was be presented. Kelsey Nability, District Mentor Coordinator, invited the Board to the new teacher luncheon which is held in August.

**3. Approval of Agenda**

Motion made to amend agenda. Agenda item would be listed as item 7.8 under new business, discussion of policy 1060.

Passed with a motion by Jamie Jorgensen and a second by Kelly Hinrichs.

Kelly Hinrichs: Yea, Luke Janke: Yea, Jamie Jorgensen: Yea, Bill Koile: Yea, Elizabeth Mayer: Yea, Jim Tomanek: Yea  
Yea: 6, Nay: 0

Motion to approve agenda as presented Passed with a motion by Luke Janke and a second by Kelly Hinrichs.

Kelly Hinrichs: Yea, Luke Janke: Yea, Jamie Jorgensen: Yea, Bill Koile: Yea, Elizabeth Mayer: Yea, Jim Tomanek: Yea  
Yea: 6, Nay: 0

**4. Administrative Reports**

4.1. Superintendent's Report

4.2. Financial Report

Mayer was excited to see playground discussion in Dr. Polonic's Superintendent report. Mayer also asked if recorded meeting will eventually be posted online for viewing.

Koile commended the staff and administration on a successful graduation ceremony.

**5. Consent Agenda**

Motion to approve Consent Agenda Passed with a motion by Jim Tomanek and a second by Bill Koile.

Kelly Hinrichs: Yea, Luke Janke: Yea, Jamie Jorgensen: Yea, Bill Koile: Yea, Elizabeth Mayer: Yea, Jim Tomanek: Yea  
Yea: 6, Nay: 0

5.1. Approve Minutes

Regular Meeting Date:

Special Meeting Date:

5.2. Approve Claims for Payment

5.3. Approve Financial Report

5.4. Approve Classified Staff

## 6. Old Business

6.1. Building and Grounds Update

The buildings and grounds committee updated the Board on the Sports Complex Project design & budget progress.

Dr. Poloncic previewed a list of in-house maintenance projects for the summer.

## 7. New Business

7.1. Nebraska Rural Community Schools Association (NRCSA) Guest

Last year, DC West Community Schools joined NRCSA. This organization has allowed professional connections to other rural school districts across the state. Jack Moles, NRCSA Executive Director, stopped by the meeting to introduce himself and share a bit with the Board about NRCSA.

7.2. Approve High School Maintenance & Remodel Project

In order to serve our high school students' special education needs next year and beyond, the district will need to modify three current spaces in our high school to create a setting that provides classroom space, independent work space, and a sensory room. Nicki Pechous, Director of Special Education, has worked with Mr. Knott, special educators, and parents on the designed needs of the space. We have received a bid from KV Construction, a company that has done extensive work at DC West, to alter the classroom spaces this summer.

There has also been a noise issue between our STEM classroom and welding lab in the STEM area this year with simultaneous classes. This will continue to be an issue with capacity and scheduling. To deter this from happening, we have included the addition of a wall between the classroom and lab setting in this bid.

We are asking the board approve this bid in order to accomplish the work this summer and be ready for our students this Fall. Budgeted general funds will be used for this project.

Motion to approve the bid from KV Construction in the amount of \$29,339 to remodel rooms in the high school for special education classroom space Passed with a motion by Luke Janke and a second by Jamie Jorgensen.

Kelly Hinrichs: Yea, Luke Janke: Yea, Jamie Jorgensen: Yea, Bill Koile: Yea, Elizabeth Mayer: Yea, Jim Tomanek: Yea  
Yea: 6, Nay: 0

7.3. Discuss & Approve a Special Project submitted by DC West Schools Foundation

The buildings and grounds committee met to review the project proposal from the DC West Schools Foundation. The buildings and grounds committee recommends that the Board discuss approval of the project with the following conditions:

- Retaining the right to withdraw previously granted donor names should there be a material change of circumstances such that the name no longer represents the District in a positive manner or is appropriate for a K-12 educational facility.
- Retaining the right to remove or rename after five years.

Motion to approve the DC West Schools Foundation Special Improvement Project titled DC West Weight Training Room Phase 2 with the conditions presented included. Passed with a motion by Elizabeth Mayer and a second by Jim Tomanek.

Kelly Hinrichs: Yea, Luke Janke: Yea, Jamie Jorgensen: Yea, Bill Koile: Yea, Elizabeth Mayer: Yea, Jim Tomanek: Yea  
Yea: 6, Nay: 0

7.4. Approve Certified Staff Resignation

Bryan Bohn, Assistant MS/HS Music Teacher, has resigned his position at the end of the 2023-2024 school year.

Motion to approve the resignation of Bryan Bohn, Assistant MS/HS Music Teacher, Passed with a motion by Bill Koile and a second by Luke Janke.

Kelly Hinrichs: Yea, Luke Janke: Yea, Jamie Jorgensen: Yea, Bill Koile: Yea, Elizabeth Mayer: Yea, Jim Tomanek: Yea  
Yea: 6, Nay: 0

7.5. Approve Certificated Staff Hires

The administration recommends the following for hire:

Sailor Bails, Elementary Special Education (new position)

James Eddy, Middle School STEM

Jed Johnston, Interim Elementary Principal

Motion to approve Sailor Bails, Elementary Special Education; James Eddy, Middle School STEM; and Jed Johnston, Interim Elementary Principal to begin the 2024-2025 school year Passed with a motion by Jamie Jorgensen and a second by Bill Koile.

Kelly Hinrichs: Yea, Luke Janke: Yea, Jamie Jorgensen: Yea, Bill Koile: Yea, Elizabeth Mayer: Yea, Jim Tomanek: Yea  
Yea: 6, Nay: 0

**7.6. Approve Classified and Administrative Salaries for the 2024-2025 School Year**

The negotiations committee met on Tuesday, April 30th, to discuss classified and administrative salaries for the 2024-2025 school year.

Motion to approve the classified and administrative salaries as presented for the 2024-2025 school year Passed with a motion by Bill Koile and a second by Luke Janke.

Kelly Hinrichs: Yea, Luke Janke: Yea, Jamie Jorgensen: Yea, Bill Koile: Yea, Elizabeth Mayer: Yea, Jim Tomanek: Yea  
Yea: 6, Nay: 0

**7.7. Fiscal Year 2025 Budget Preview**

Dr. Poloncic previewed the 2025 Fiscal Year with the Board as she had received preliminary estimates for the upcoming budget cycle.

**7.8. Discuss Policy 1060**

Jamie Jorgensen spoke regarding an incident that happened on May 4<sup>th</sup> on school property. She noted that, per policy 1060, we do not allow our school grounds, facilities, etc. be used to endorse or condone any political candidate running for an elected position.

**8. Adjournment**

Motion to adjourn meeting @ 7:53pm Passed with a motion by Luke Janke and a second by Jim Tomanek.

Kelly Hinrichs: Yea, Luke Janke: Yea, Jamie Jorgensen: Yea, Bill Koile: Yea, Elizabeth Mayer: Yea, Jim Tomanek: Yea  
Yea: 6, Nay: 0

  
\_\_\_\_\_  
Kristi Trost, Board Secretary

  
\_\_\_\_\_  
Dr. Melissa Poloncic, Superintendent

# DC West Teacher Appraisal & Continuous Growth





# DC WEST

## Community Schools

Engage, Prepare, and Empower

### Strategic Plan

DC West Community Schools engages, prepares, and empowers all of our students for the future.

### Guiding Principle:

#### Personnel Effectiveness

To ensure the district provides educational leadership and highly effective staff to support our students academically, personally, and in their individual social growth, as well as building and sustaining cohesion and unity among the staff.

### Strategy 3.1

Utilize a **teacher evaluation system aligned to the instructional framework** and lesson plans to provide timely and authentic feedback to reinforce growth and identify opportunities to refine professional skills and knowledge.

# Years in the Making

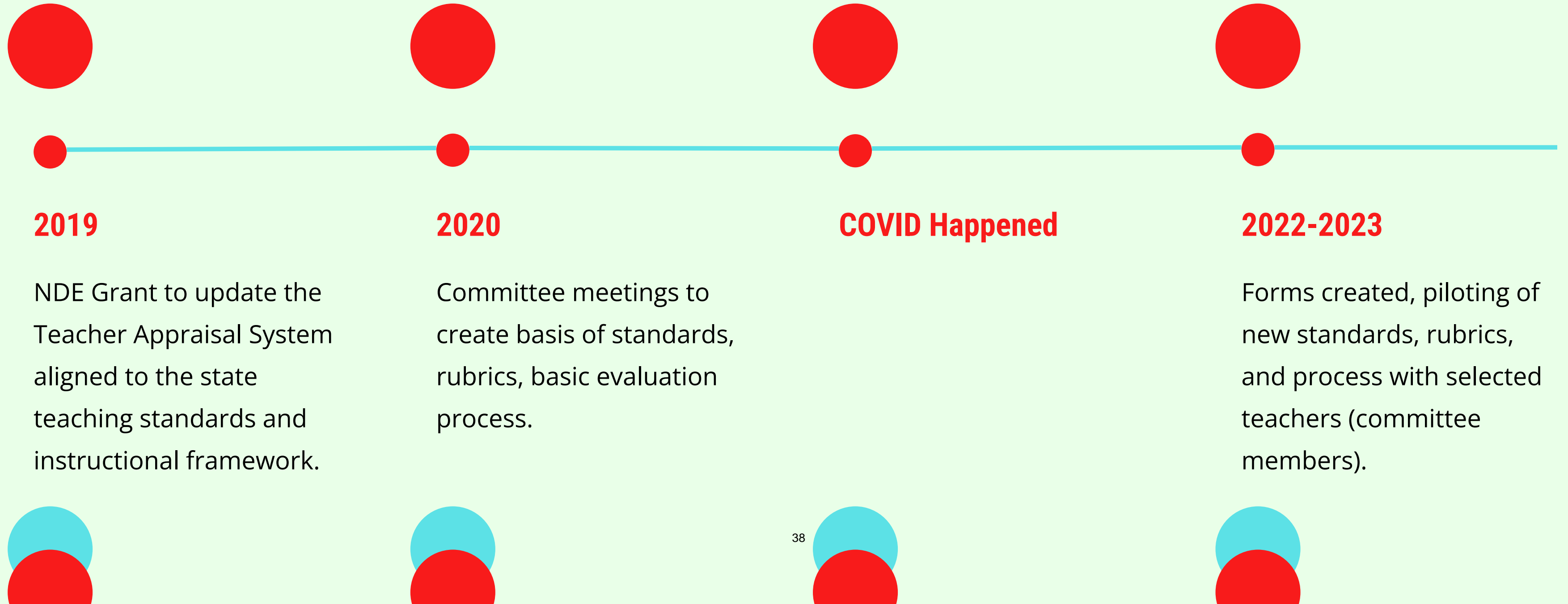

# DC West Instructional Model

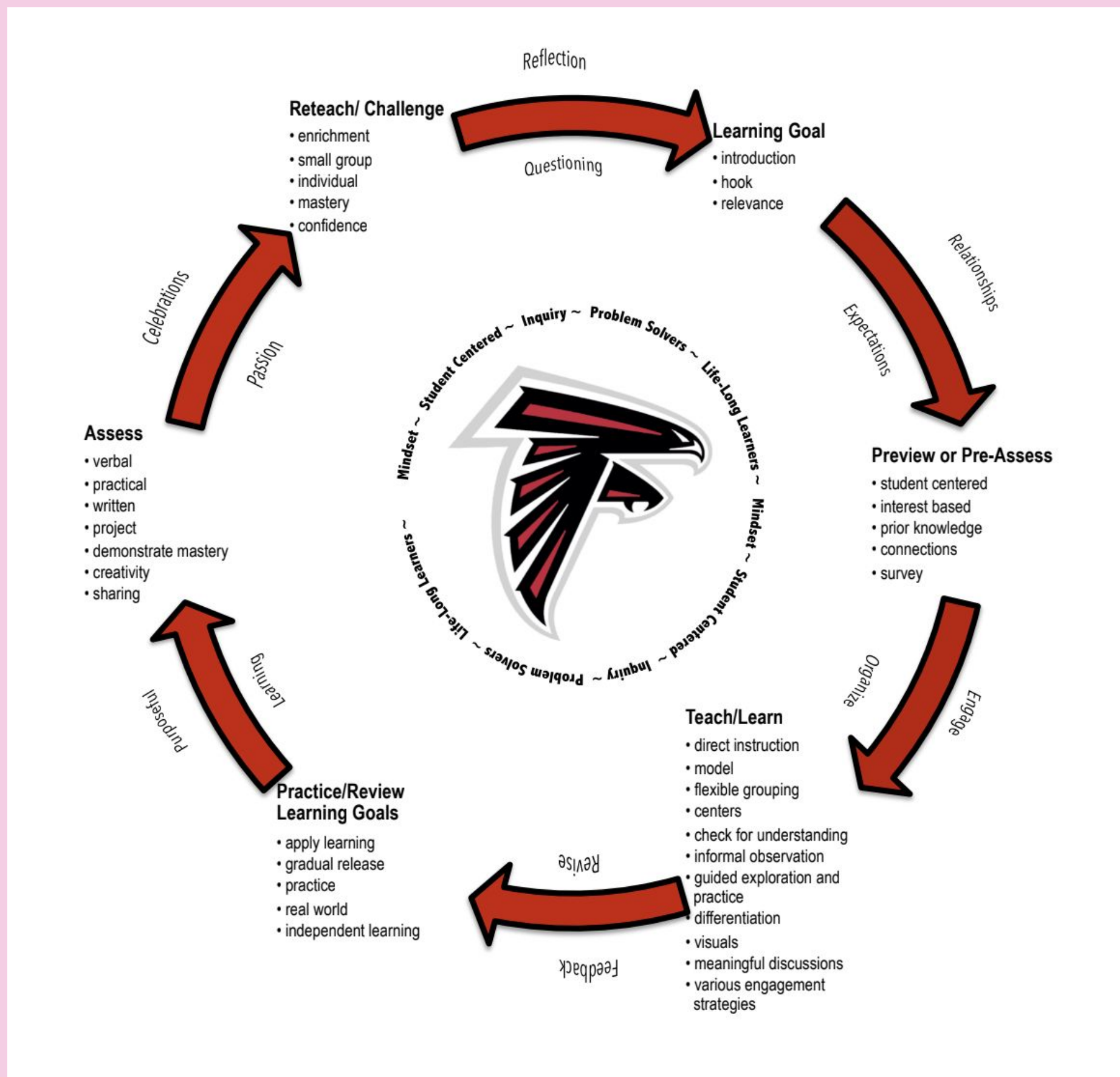

# NDE Teaching Standards

[Nebraska Teacher and Principal Performance Standards](#)

## Nebraska Teacher and Principal Performance Standards



# DCW Teacher Performance Standards & Rubrics

PLANNING & PREPARATION

THE LEARNING ENVIRONMENT

INSTRUCTIONAL STRATEGIES

ASSESSMENT

PROFESSIONALISM

VISION & COLLABORATION



**Teacher Performance Standards and Rubrics**

Standard 1: Planning and Preparation	The teacher integrates pedagogy, content standards, content knowledge, instructional materials, student interest to develop rigorous instruction which aligns with the district curriculum to address the needs of each student.			
Indicators	Ineffective	Developing	Effective	Exemplary
a. Develop coherent units, lessons, activities and assessments that reflect high expectations and enable each student to achieve standards, learning goals, and instructional objectives.	Little or no implementation or execution of indicator	Inconsistent implementation or executions of indicators	Consistent implementation and execution of indicators	Consistent implementation and execution of indicators to the highest degree
b. Use a variety of appropriate, research-based instructional strategies supported by student data.	Plans lesson by lesson and has little familiarity with content standards.	Considers content standards and curriculum in development of lessons.	Plans with content standards and curriculum in development of lessons.	Leads and collaborates with colleagues to align content standards and curriculum to strengthen the development of lessons.
	Plans with little or no high quality instructional strategies and randomly implements content standards and learning goals.	Utilizes limited instructional strategies and some are aligned with the content.	Utilize high quality instructional strategies to implement lessons that meet content standards, learning goals, and instructional objectives.	Leads efforts to develop, test, model, or promote high quality instructional strategies to create challenging and creative lessons that meet content standards, learning goals, and instructional objectives.

# APPRAISAL & CONTINUOUS GROWTH CYCLE



## Appraisal Cycle & Continuous Growth Cycle

**Appraisal Cycle (Probationary):** For teachers in their first three years with DC West. Each component occurs annually for each of the three years.

- 2 Instructional Walkthroughs
- 2 Observations: Full Instructional Period
- Summative Evaluation
- Personalized Goal: Fall and Spring Conference

**Continuous Growth Cycle:** For teachers in their fourth or more years with DC West. This cycle rotates each year.

- Continuous Growth Year 1: 4 Instructional Walkthroughs, Personalized Goal: Fall and Spring Conference
- Continuous Growth Year 2: 4 Instructional Walkthroughs, Personalized Goal: Fall and Spring Conference
- Continuous Growth Year 3: 3 Instructional Walkthroughs, 1 Observation: Full Instructional Period, Summative Evaluation, Personalized Goal: Fall and Spring Conference

Cycle	Year	Components	Due
<b>Appraisal Cycle (Probationary)</b>	<b>1-3</b>	2 Instructional Walkthroughs	By May 15th
		2 Observations: Full Instructional Period	By April 15th
		Summative Evaluation	By April 15th
		Personalized Goal with Fall and Spring Conference	By May 15th
<b>Continuous Growth Cycle</b>	<b>1</b>	4 Instructional Walkthroughs	By May 15th
		Personalized Goal with Fall and Spring Conference	By May 15th
	<b>2</b>	4 Instructional Walkthroughs	By May 15th
		Personalized Goal with Fall and Spring Conference	By May 15th
	<b>3</b>	3 Instructional Walkthroughs	By May 15th
		1 Observation: Full Instructional Period	By April 15th
		Summative Evaluation	By April 15th
		Personalized Goal with Fall and Spring Conference	By May 15th

## Teacher Feedback:

- Simple, easy to understand layout and format
- Focuses on growth and continuous improvement
- Ability to choose specific standards to focus on annually
- Clear expectations and rubrics with good differentiation between categories
- Frequent walkthroughs provide more realistic feedback than formal observations
- Only one formal observation every 3 years, reducing stress
- Online and easily accessible digitally
- Specific and relevant to the district's needs
- Provides more detailed feedback from administrators
- Promotes growth by outlining ways to improve
- Well-organized and focuses on support



# What's Next?

- **Board approval by July 2024**
- **File with the Nebraska Department of Education**
- **Refine forms on the electronic management system with Vector Solutions**
- **Finalize the intensive assistance plan**
- **Begin the new system Fall 2024**



Creative Sites, LLC

11506 Pierce St | Omaha, NE 68144 | 402-614-4606

May 28, 2024

Melissa Polonic  
DC West Community Schools  
401 S Pine St  
Valley, NE 68064  
Phone: 4023592583

Dear Melissa Polonic:

Creative Sites, LLC is delighted to provide DC West Community Schools with this playground equipment proposal.

This design was developed with your specific needs in mind, and we look forward to discussing this project further with you to ensure your complete satisfaction. Creative Sites, LLC is confident that this proposal will satisfy DC West Community Schools's functional, environmental, and safety requirements -- and most importantly -- bring joy and excitement to the children and families directly benefiting from your new playground.

You have our personal commitment to support this project and your organization in every manner possible, and we look forward to developing a long-standing relationship with DC West Community Schools. We appreciate your consideration and value this opportunity to earn your business.

Sincerely,

**Chloe Kutilek**  
*Sales Representative*

Creative Sites, LLC  
11506 Pierce St  
Omaha, NE 68144  
[www.creativesitesllc.com](http://www.creativesitesllc.com)  
[www.bciburke.com](http://www.bciburke.com)

Phone: 402-614-4606  
Fax: 402-558-1998  
[chloe@creativesitesllc.com](mailto:chloe@creativesitesllc.com)



# COOPERATIVE PURCHASING OPTIONS

## PLAYGROUNDS WITHOUT ALL THE PAPERWORK

Purchasing with contracts may sound intimidating, but getting your community playspace doesn't need to be a painful process of writing specifications, issuing RFP's and jumping through hoops – it can be simplified – we promise! As you continue planning for your new playground, review the Purchasing Contracts offered through our partners.

### EQUALIS GROUP

Equalis is an innovative cooperative purchasing organization that believes in the power of partnership and that when you work together you achieve more. The basic premise of the Equalis cooperative purchasing organization is to leverage the combined buying power of all members for better pricing and favorable contract terms. Equalis Group uses the lead agency model for competitively bid contracts, provides our participants the savings they expect and offers efficiencies and peace of mind within the procurement process. It is our mission to continuously improve the measurable and meaningful impact of cooperative services for everyone throughout the supply chain.

### GOVMVMT

GOVMVMT is a non-profit group purchasing organization that meets the highest industry standards while putting the public's interest at the forefront of everything they do. Each one of GOVMVMT's first-class suppliers has consciously joined their mission to create the most credible, ethical, and public agency-focused non-profit cooperative purchasing program in the country.

### GSA

Federal parks, child development programs, military bases and other agencies are a major priority for BCI Burke, and agencies can purchase Burke playgrounds through Burke's GSA contract for installation virtually anywhere in the world.

### OMNIA PARTNERS

OMNIA Partners, Public Sector (Subsidiary National IPA) is the largest and most experienced organization in purchasing and supply chain management. Comprised of participants and suppliers in the public sector, we bring together industry-leading buying power and world-class suppliers to offer an extensive portfolio of competitively solicited and publicly awarded contracts and partnerships. OMNIA Partners is proud to offer more value and resources to state and local government, higher education, K-12 education and non-profits.

### SOURCEWELL

As a leader in cooperative purchasing, Sourcewell is passionate about helping members fulfill their public service missions. Sourcewell builds strong relationships with members and vendors to develop practical solutions together.

The easiest way to Join Our Movement is to call your local Representative at 800.266.1250 or visit [bciburke.com/rep](http://bciburke.com/rep). Our passion is bringing play to communities like yours and we can't wait to help you get started!



## DESIGN SUMMARY

Creative Sites, LLC is very pleased to present this Proposal for consideration for the DC West Elementary located in Valley. BCI Burke Company, LLC has been providing recreational playground equipment for over 100 years and has developed the right mix of world-class capabilities to meet the initial and continuing needs of DC West Community Schools. We believe our proposal will meet or exceed your project's requirements and will deliver the greatest value to you.

The following is a summary of some of the key elements of our Proposal:

- Project Name: DC West Elementary
- Project Number: 905-186017-1
- User Capacity: 201
- Age Groups: 5 to 12
- Dimensions: 80' 1"x45' 2"
- Designer Name: Brandy Janke

Creative Sites, LLC has developed a custom playground configuration based on the requirements as they have been presented for the DC West Elementary playground project. Our custom design will provide a safe and affordable playground environment that is aesthetically pleasing, full of fun for all users and uniquely satisfies your specific requirements. In addition, proposal # 905-186017-1 has been designed with a focus on safety, and is fully compliant with ASTM F1487 and CPSC playground safety standards.

We invite you to review this proposal for the DC West Elementary playground project and to contact us with any questions that you may have.

Thank you in advance for giving us the opportunity to make this project a success.

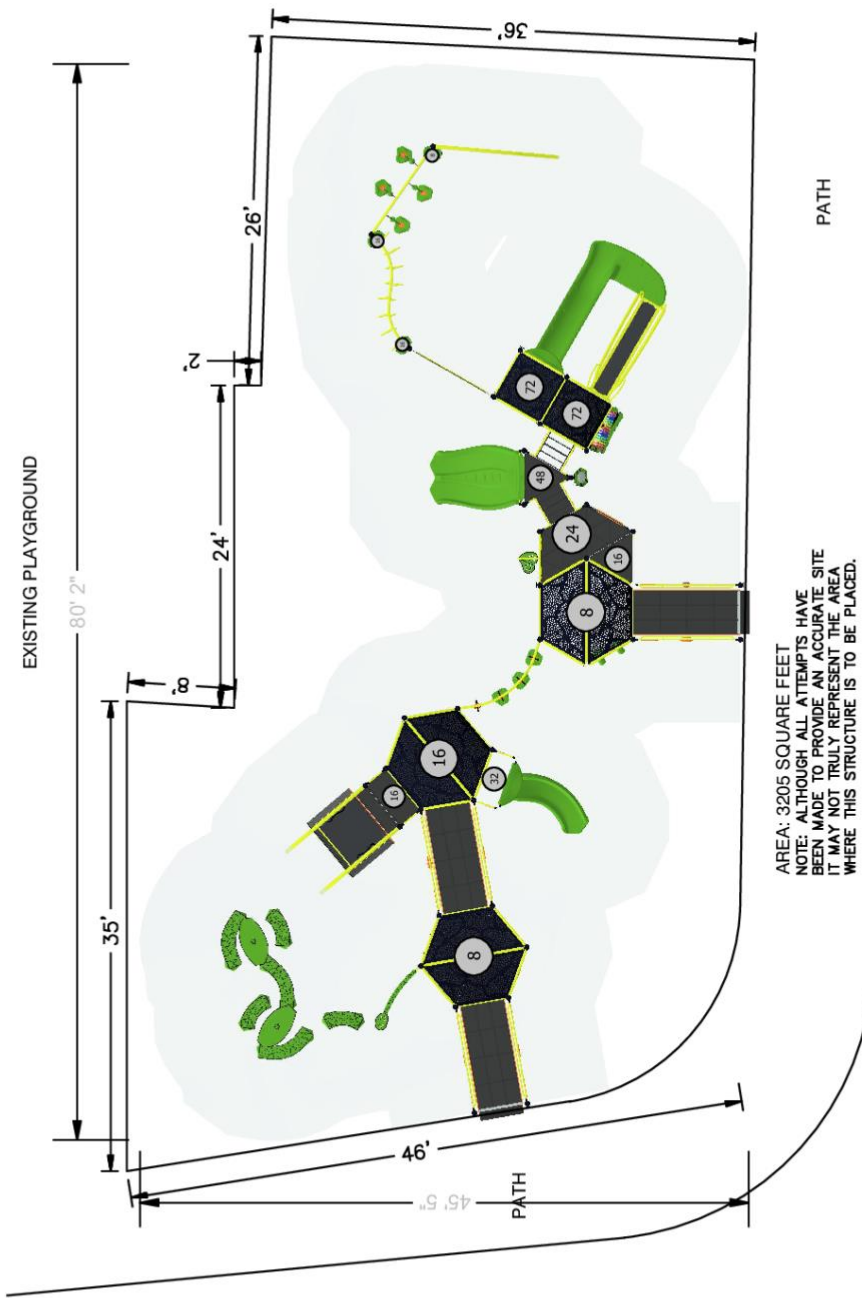

The use and layout of play components identified in this plan conform to the CPSC guidelines. U.S. CPSC recommends the separation of age groups in playground layouts.

PLAYGROUND ACCESSIBILITY (Provided/Required)			
TOTAL ELEVATED EVENTS	TRANSFER ACCESSIBLE ELEMENTS	RAMP ACCESSIBLE ELEMENTS	TYPES OF GROUND EVENTS
71	24 / 12	11 / 6	44 / 8
	8 / 6	11 / 6	6 / 4

**OVERALL BOUNDING OF USE ZONES** \*\*The space requirements shown here are to ASTM standards. Requirements for other standards may be different.

Area: 3632.6 sq.ft.  
 Perimeter: 250.9 ft.  
**STRUCTURE SIZE:** 5" x 80' 2"  
**POST SIZE(S):**

Warning: Accessible safety surfacing material is required beneath and around this equipment that is compliant with ASTM, CPSC, and ADAAG requirements.

<b>SERIES</b> Nucleus   Intensity   Burke Basics	<b>SITE PLAN VIEW</b>
<b>GROUP:</b> Structure	05/28/2024
<b>DESIGNED FOR AGES:</b> 5 to 12	<b>Creative Sites, LLC</b> 905-186017-1 Designer: Brandy Janke
<b>DC West Elementary</b> Valley, NE 68064	
<b>Burke</b> PLAY THAT MOVES YOU.	
BCI BURKE COMPANY, LLC   PO BOX 549 FOND DU LAC, WI 54936-0549   920.921.9220   BCIURKE.COM	

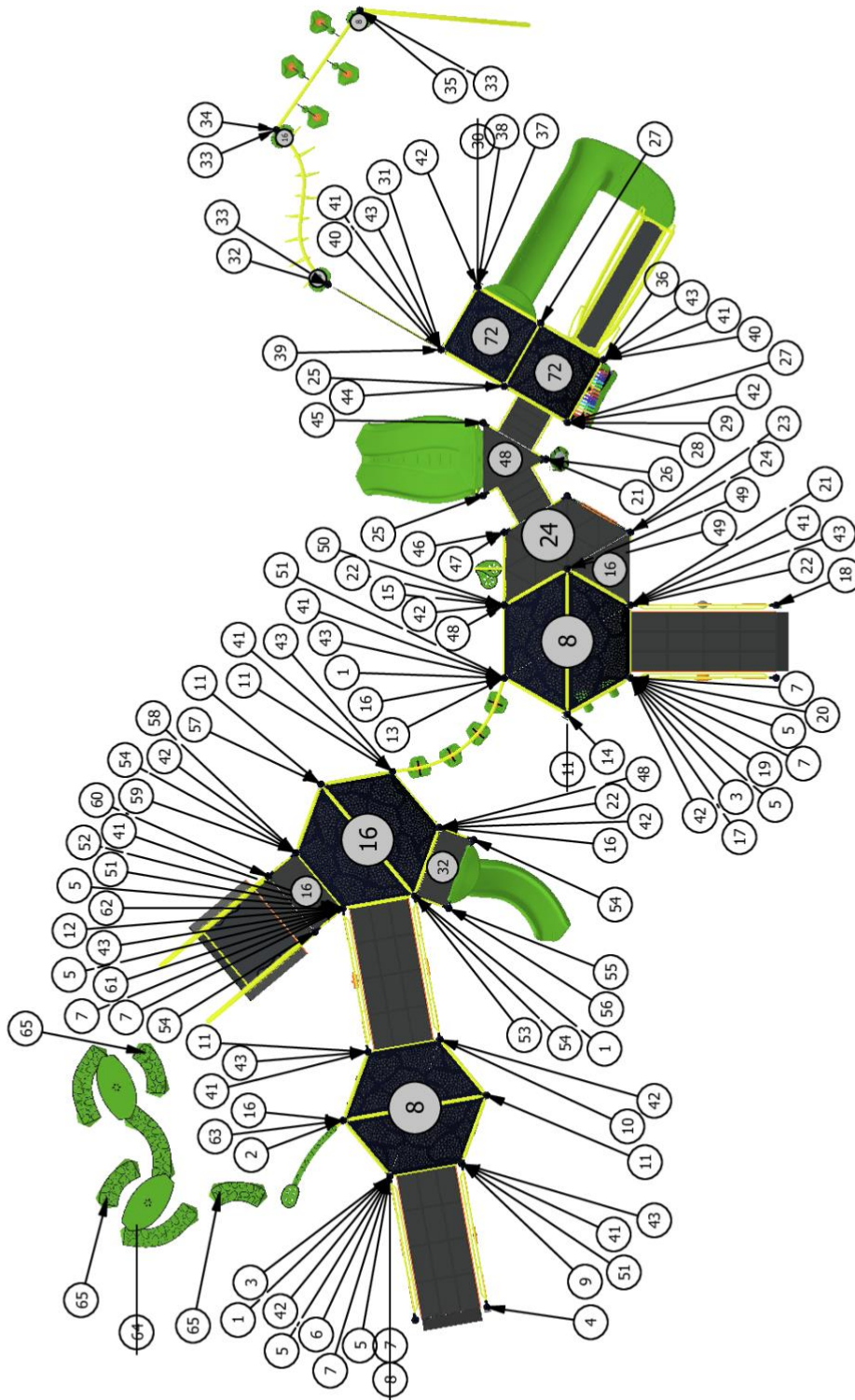

**SERIES** Nucleus | Intensity | Burke Basics

**COMPONENT VIEW**

**GROUP:**  
Structure

**DC West Elementary**  
Valley, NE 68064

05/28/2024

**DESIGNED FOR AGES:**  
5 to 12

**Creative Sites, LLC**  
905-186017-1

Designer: Brandy Janke



ITEM	COMP.	DESCRIPTION	ITEM	COMP.	DESCRIPTION
1	270-0131	HEXAGONAL PLATFORM SSP	54	570-0072	EVOLUTION HALF BARRIER
2	370-1720	LIL NOVO BALANCE BEAM LINK	55	470-0802	MOMACO SLIDE, 32"-40"
3	270-0125	SENSORY RAIL 8" RISE ENTRANCE RAMP	56	470-0967	SLIDE HOOD, LOW SIDE WALL
4	570-2721	DOTS POST MOUNTED SPINNER	57	570-2668	CAR ACCESSIBLE REACH PANEL
5	570-0104	SENSORY RAIL TOP PANEL	58	570-2621	ADA RACE ACCESSIBLE REACH PANEL
6	570-0108	CHROMA SENSORY EVENT, MIDDLE	59	270-0290	HALF PLATFORM
7	570-0106	SENSORY RAIL LOWER PANEL	60	570-0103	INNOVA ROCKER
8	570-0115	HYPNO SENSORY EVENT, MIDDLE	61	570-0124	GROOVY SENSORY EVENT, MIDDLE
9	570-2719	SEEK'N'FIND 2-SIDED PLAY PANEL	62	570-0127	GRASS SENSORY EVENT, MIDDLE
10	570-2669	MAZE ACCESSIBLE REACH PANEL	63	570-2667	BEE ACCESSIBLE REACH PANEL
11	570-0622	PLATFORM ROLL GUARD	64	560-2744	EKO SERPENTINE
12	270-0124	SENSORY RAIL 8" RISE RAMP	65	560-2736	EKO CIRCA
13	370-0223	PURSUIT CLIMBER 16" -40"			
14	570-2725	SPOKES POST MOUNTED SPINNER			
15	570-2724	RADIATE POST MOUNTED SPINNER			
16	270-0122	EVOLUTION OFFSET ENCLOSURE			
17	570-2670	DRUM ACCESSIBLE REACH PANEL			
18	570-2722	PETALS POST MOUNTED SPINNER			
19	570-0118	MELODY SENSORY EVENT, MIDDLE			
20	570-0112	MIRROR SENSORY EVENT, MIDDLE			
21	270-0129	TRIANGLE PLATFORM			
22	370-0016	GRAB BAR ASSEMBLY			
23	270-0132	HALF HEXAGON PLATFORM			
24	570-1851	CHIMES PANEL			
25	370-0039	EVOLUTION 24" TRANSITION STAIR W/ BARRIERS			
26	570-2732	PLAYENSEMBLE BABEL DRUM			
27	270-0130	SQUARE PLATFORM			
28	570-0411	PLAYENSEMBLE SUPINE CHIMES HUE			
29	570-0130	EVOLUTION BARRIER W/ KALEIDOSCOPE			
30	570-2723	PINWHEEL POST MOUNTED SPINNER			
31	370-1651	TRANGO CLIMBER, POST TO POST			
32	370-1679	S OVERHEAD, NUCLEUS			
33	370-1608	OV/STEP LAUNCH PAD			
34	370-1730	DYNAMIC DISCS			
35	370-1612	APEX ELLIPSE CLIMBER			
36	470-0966	360 LOOP			
37	370-0865	TREE BRANCH CLIMBER 72"			
38	270-0120	EVOLUTION UNITARY ENCLOSURE			
39	570-0100	EVOLUTION BARRIER			
40	470-0015	EVOLUTION SQUARE ROOF			
41	470-0006	EVOLUTION BOTTOM ROOF SUPPORT, SINGLE			
42	470-0008	EVOLUTION SIDE ROOF SUPPORT, LEFT			
43	470-0009	EVOLUTION SIDE ROOF SUPPORT, RIGHT			
44	470-0004	EVOLUTION TOP ROOF SUPPORT, DOUBLE			
45	470-0755	LUGE SLIDE, 48"-56"			
46	370-1670	PETAL STEP CLIMBER 16"-24"			
47	270-0121	EVOLUTION STANCHION			
48	270-0300	ABSTRACT PLATFORM LADDER 16"			
49	270-0009	8" CLOSURE PLATE, ELLIPSE			
50	570-1858	3-IN-A-ROW PANEL, ABOVE PLATFORM			
51	470-0014	EVOLUTION HEX ROOF			
52	570-2726	WAVES POST MOUNTED SPINNER			
53	270-0291	HALF PLATFORM W/SUPPORT			

**SERIES** Nucleus | Intensity | Burke Basics

**COMPONENT VIEW**

**GROUP:**  
Structure

**DC West Elementary**  
Valley, NE 68064

05/28/2024

**DESIGNED FOR AGES:**  
5 to 12



**Creative Sites, LLC**  
905-186017-1

Designer: Brandy Janke

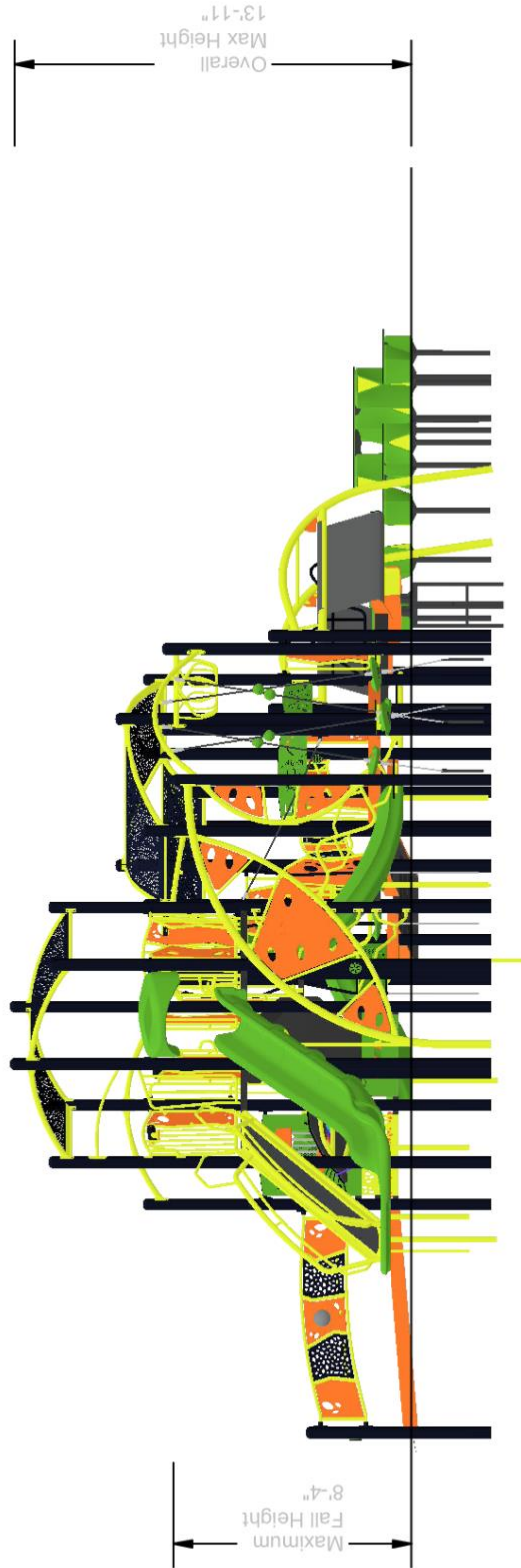

<b>SERIES</b> Nucleus   Intensity   Burke Basics	<b>ELEVATION VIEW</b>	
<b>GROUP:</b> Structure	<b>DC West Elementary</b> Valley, NE 68064	05/28/2024 <b>Creative Sites, LLC</b> 905-186017-1
<b>DESIGNED FOR AGES:</b> 5 to 12		Designer: Brandy Janke
BCI BURKE COMPANY, LLC   PO BOX 549 FOND DU LAC, WI 54936-0549   920.921.9220   BCIBURKE.COM		



**SERIES** Nucleus | Intensity | Burke Basics

**ISOMETRIC VIEW**

**GROUP:**  
Structure

**DC West Elementary**  
Valley, NE 68064

05/28/2024

**DESIGNED FOR AGES:**  
5 to 12

**Creative Sites, LLC**  
905-186017-1

Designer: Brandy Janke

**Burke**  
PLAY THAT MOVES YOU

The play components identified in this proposal are IPEMA certified. The use and layout of these components conform to the requirements of ASTM F1487. To verify product certification, visit [www.ipema.org](http://www.ipema.org).



The space requirements shown in this proposal are to ASTM standards. Requirements for other standards may be different.

Component No.	Description	Qty	User Cap	Ext. User Cap	Weight	Ext. Weight
<b>Nucleus</b>						
072-0500-100C	5" OD X 100" CAPPED POST	1	0	0	53	53
072-0500-116C	5" OD X 116" CAPPED POST	1	0	0	61	61
072-0500-120C	5" OD X 120" CAPPED POST	1	0	0	63	63
072-0500-124C	5" OD X 124" CAPPED POST	1	0	0	65	65
072-0500-128C	5" OD X 128" CAPPED POST	4	0	0	67	268
072-0500-132C	5" OD X 132" CAPPED POST	1	0	0	69	69
072-0500-136C	5" OD X 136" CAPPED POST	2	0	0	71	142
072-0500-140C	5" OD X 140" CAPPED POST	4	0	0	74	296
072-0500-144C	5" OD X 144" CAPPED POST	8	0	0	76	608
072-0500-156C	5" OD X 156" CAPPED POST	4	0	0	82	328
072-0500-184C	5" OD X 184" CAPPED POST	4	0	0	96	384
072-0500-200C	5" OD X 200" CAPPED POST	2	0	0	105	210
072-0500-76C	5" OD X 76" CAPPED POST	4	0	0	40	160
072-0500-92C	5" OD X 92" CAPPED POST	2	0	0	48	96
270-0009	8" CLOSURE PLATE, ELLIPSE	2	0	0	8	16
270-0120	EVOLUTION UNITARY ENCLOSURE	1	0	0	34	34
270-0121	EVOLUTION STANCHION	1	0	0	43	43
270-0122	EVOLUTION OFFSET ENCLOSURE	3	0	0	34	102
270-0124	SENSORY RAIL 8" RISE RAMP	1	21	21	406	406
270-0125	SENSORY RAIL 8" RISE ENTRANCE...	2	0	0	440	880
270-0129	TRIANGLE PLATFORM	2	2	4	48	96
270-0130	SQUARE PLATFORM	2	6	12	106	212
270-0131	HEXAGONAL PLATFORM S5P	3	12	36	287	861
270-0132	HALF HEXAGON PLATFORM	1	6	6	144	144
270-0290	HALF PLATFORM	1	3	3	57	57
270-0291	HALF PLATFORM W/SUPPORT	1	3	3	69	69
270-0300	ABSTRACT PLATFORM LADDER 16"	2	1	2	17	34
370-0016	GRAB BAR ASSEMBLY	3	0	0	6	18
370-0039	EVOLUTION 24" TRANSITION STAI...	2	4	8	181	362
370-0223	PURSUIT CLIMBER 16"-40"	1	4	4	127	127
370-0865	TREE BRANCH CLIMBER 72"	1	4	4	33	33
370-1651	TRANGO CLIMBER, POST TO POST	1	5	5	32	32
370-1670	PETAL STEP CLIMBER 16"-24"	1	1	1	30	30
370-1720	LIL NOVO BALANCE BEAM LINK	1	3	3	58	58
470-0004	EVOLUTION TOP ROOF SUPPORT, D...	1	0	0	14	14
470-0006	EVOLUTION BOTTOM ROOF SUPPORT...	8	0	0	13	104
470-0008	EVOLUTION SIDE ROOF SUPPORT, ...	8	0	0	18	144
470-0009	EVOLUTION SIDE ROOF SUPPORT, ...	8	0	0	18	144
470-0014	EVOLUTION HEX ROOF	3	0	0	106	318
470-0015	EVOLUTION SQUARE ROOF	2	0	0	42	84
470-0755	LUGE SLIDE, 48"-56"	1	4	4	198	198
470-0802	MONACO SLIDE, 32"-40"	1	2	2	70.6	70.6
470-0966	360 LOOP	54	6	6	557	557
470-0967	SLIDE HOOD, LOW SIDE WALL	1	0	0	37	37
570-0072	EVOLUTION HALF BARRIER	4	0	0	26.6	106.4

570-0100	EVOLUTION BARRIER	1	0	0	52	52
570-0103	INNOVA ROCKER	1	14	14	703	703
570-0104	SENSORY RAIL TOP PANEL	6	0	0	7	42
570-0106	SENSORY RAIL LOWER PANEL	6	0	0	8	48
570-0108	CHROMA SENSORY EVENT, MIDDLE	1	0	0	12	12
570-0112	MIRROR SENSORY EVENT, MIDDLE	1	0	0	13	13
570-0115	HYPNO SENSORY EVENT, MIDDLE	1	0	0	20	20
570-0118	MELODY SENSORY EVENT, MIDDLE	1	0	0	20	20
570-0124	GROOVY SENSORY EVENT, MIDDLE	1	0	0	26	26
570-0127	GRASS SENSORY EVENT, MIDDLE	1	0	0	16	16
570-0130	EVOLUTION BARRIER W/ KALEIDOS...	1	1	1	64	64
570-0411	PLAYENSEMBLE SUPINE CHIMES HUE	1	2	2	93	93
570-0622	PLATFORM ROLL GUARD	5	0	0	8	40
570-1851	CHIMES PANEL	1	4	4	56	56
570-1858	3-IN-A-ROW PANEL, ABOVE PLATFORM	1	2	2	45	45
570-2621	ADA RACE ACCESSIBLE REACH PANEL	1	4	4	17	17
570-2667	BEE ACCESSIBLE REACH PANEL	1	2	2	16	16
570-2668	CAR ACCESSIBLE REACH PANEL	1	2	2	23	23
570-2669	MAZE ACCESSIBLE REACH PANEL	1	2	2	16	16
570-2670	DRUM ACCESSIBLE REACH PANEL	1	2	2	23	23
570-2719	SEEK'N'FIND 2-SIDED PLAY PANEL	1	2	2	53	53
570-2721	DOTS POST MOUNTED SPINNER	1	1	1	0.7	0.7
570-2722	PETALS POST MOUNTED SPINNER	1	1	1	0.7	0.7
570-2723	PINWHEEL POST MOUNTED SPINNER	1	1	1	0.7	0.7
570-2724	RADIATE POST MOUNTED SPINNER	1	1	1	0.7	0.7
570-2725	SPOKES POST MOUNTED SPINNER	1	1	1	0.7	0.7
570-2726	WAVES POST MOUNTED SPINNER	1	1	1	0.7	0.7
570-2732	PLAYENSEMBLE BABEL DRUM	1	1	1	14	14
600-0104	NPPS SUPERVISION SAFETY KIT	1	0	0	3	3
660-0103	MAINTENANCE KIT, STRUCTURE	1	0	0	7	7
660-0104	INSTALLATION KIT, STRUCTURE	1	0	0	5	5
670-0422	HALF DECK UPPER POST 5" OD	2	0	0	26	52

**Intensity**

370-1608	OVISTEP LAUNCH PAD	3	1	3	10	30
370-1612	APEX ELLIPSE CLIMBER	1	8	8	184	184
370-1679	S OVERHEAD, NUCLEUS	1	7	7	59	59
370-1730	DYNAMIC DISCS	1	4	4	112	112

**Burke Basics**

560-2736	EKO CIRCA	3	1	3	60	180
560-2744	EKO SERPENTINE	1	8	8	308	308

Total User Capacity: 201  
Total Weight: 10554 lbs.  
Total Price: \$167,043

**Special Notes:**

Prices do not include freight, unloading, material storage, site excavation/preparation, removal of existing equipment, removal of excess soil from footing holes, site security, safety surfacing, installation, or sales tax (if applicable). Prices are based on standard colors per CURRENT YEAR BCI Burke Catalog. Custom colors, where available, would be an extra charge. **Pricing is valid for 30 days from the date of this proposal.**

**COLOR SELECTION LIST | Default Color Option**

---

**GROUP 1 (Structure)**

---

Deck: Gray  
Post: Navy  
Acc: Lemon  
Panel: Lime-Black-Lime  
Flat: Orange  
Plastic: Lime

# COLORS THAT MOVE YOU

## POWDER COAT PAINT



## PLATFORMS

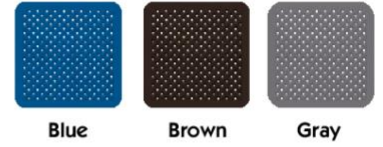

## SOLIS HUE TOPPERS



## TRADITIONAL SERIES SITE AMENITIES

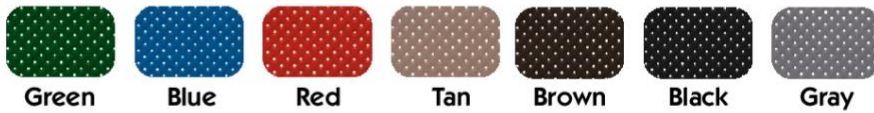

## ROCKIT CLIMBERS

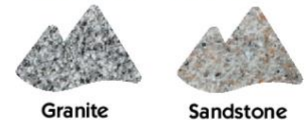

## HDPE PLASTIC PANELS

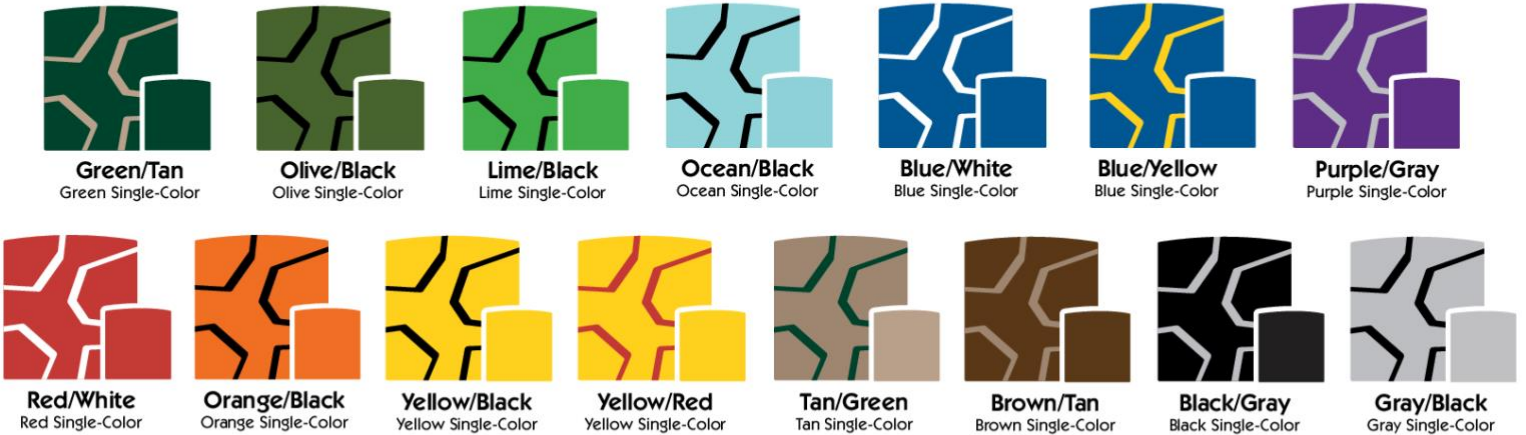

## SHADE CANOPIES

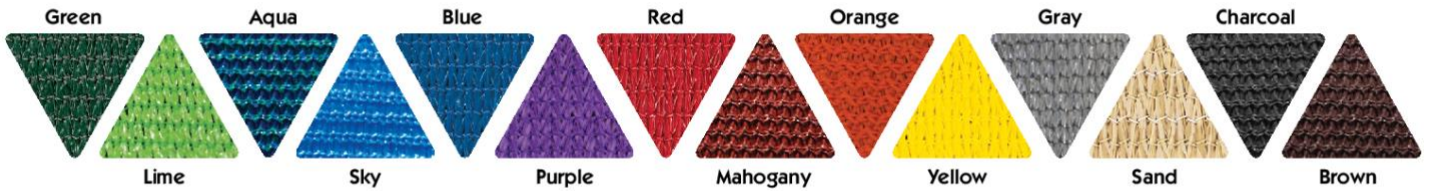

## ROTOMOLD PLASTIC

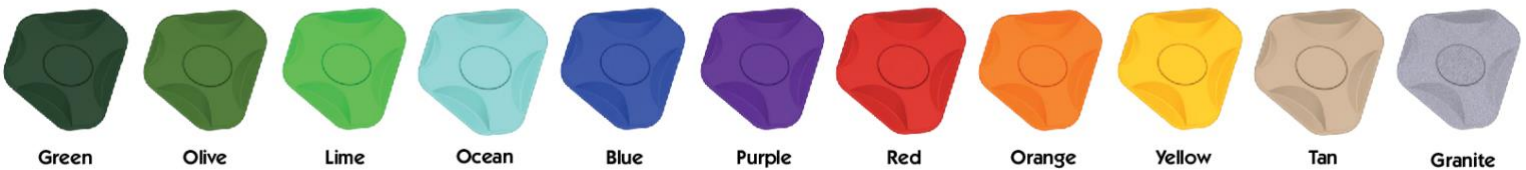

VISIT [BCIBURKE.COM/COLOR](http://BCIBURKE.COM/COLOR) TO CUSTOMIZE YOUR PLAYGROUND COLORS!

# BURKE GENERATIONS WARRANTY®

BCI Burke Company, LLC ("Burke") warrants that all standard products are warranted to be free from defects in materials and workmanship, under normal use and service, for a period of one (1) year from the date of shipment.

## We stand behind our products.

In addition, the following products are warranted, under normal use and service from the date of shipment as follows:

- One Hundred (100) Year Limited Warranty on aluminum and steel upright posts (including Nucleus®, Nucleus Evolution®, Nucleus Aspire™, Intensity®, Level X®, Synergy®, Synergy Imagination® & 4Me® against structural failure due to corrosion, deterioration or workmanship.
- One Hundred (100) Year Limited Warranty on KoreKconnect® clamps against structural failure due to corrosion, deterioration or workmanship.
- One Hundred (100) Year Limited Warranty on Hardware (nuts, bolts, washers)
- One Hundred (100) Year Limited Warranty on bolt-through fastening and clamp systems (Synergy®, Intensity®, Nucleus®).
- Twenty-Five (25) Year Limited Warranty on spring assemblies and aluminum cast animals.
- Fifteen (15) Year Limited Warranty on structure platforms and decks, metal roofs, table tops, bench tops, railings and barriers against structural failure due to materials or workmanship.
- Fifteen (15) Year Limited Warranty on all plastic components including StoneBorders against structural failure due to materials or workmanship.
- Ten (10) Year Limited Warranty on ShadePlay® Canopies fabric, threads, and cables against degradation, cracking or material breakdown resulting from ultra-violet exposure, natural deterioration or manufacturing defects. This warranty is limited to the design loads as stated in the specifications. natural deterioration or manufacturing defects. This warranty is limited to the design loads as stated in the specifications.
- Ten (10) Year Limited Warranty on NaturePlay® Boulders and GFRC products against structural failure due to natural deterioration or workmanship. Natural wear, which may occur with any concrete product with age, is excluded from this warranty.
- Ten (10) Year Limited Warranty on Full Color Custom Signage against manufacturing defects that cause delamination or degradation of the sign. Full Color Custom Signs also carry a two (2) year warranty against premature fading of the print and graphics on the signs.
- Five (5) Year Limited Warranty on Nucleus®, Intensity®, and RopeVenture® cables against premature wear due to natural deterioration or manufacturing defects. Determination of premature wear will be at the manufacturer's discretion.
- Five (5) Year Limited Warranty on rubber belt material against premature wear due to natural deterioration or manufacturing defects. Determination of premature wear will be at the manufacturer's discretion.
- Five (5) Year Limited Warranty on moving parts, including swing components, against structural failure due to materials or workmanship.
- Five (5) Year Limited Warranty on PlayEnsemble® cables and mallets against defects in materials and workmanship.
- Three (3) Year Limited Warranty on electronic panel speakers, sound chips and circuit boards against electronic failure caused by manufacturing defects.

The warranty stated above is valid only if the equipment is erected in conformity with the layout plan and/or installation instructions furnished by BCI Burke Company, LLC using approved parts; have been maintained and inspected in accordance with BCI Burke Company, LLC instructions. Burke's liability and your exclusive remedy hereunder will be limited to repair or replacement of those parts found in Burke's reasonable judgment to be defective. Any claim made within the above stated warranty periods must be made promptly after discovery of the defect. A part is covered only for the original warranty period of the applicable part. Replacement parts carry the applicable warranty from the date of shipment of the replacement from Burke. After the expiration of the warranty period, you must pay for all parts, transportation and service charges.

Burke reserves the right to accept or reject any claim in whole or in part. Burke will not accept the return of any product without its prior written approval. Burke will assume transportation charges for shipment of the returned product if it is returned in strict compliance with Burke's written instructions.

**THE FOREGOING WARRANTIES ARE EXCLUSIVE AND IN LIEU OF ANY OTHER WARRANTY, EXPRESS OR IMPLIED, INCLUDING BUT NOT LIMITED TO ANY IMPLIED WARRANTY OR MERCHANTABILITY OR FITNESS FOR A PARTICULAR PURPOSE. IF THE FOREGOING DISCLAIMER OF ADDITIONAL WARRANTIES IS NOT GIVEN FULL FORCE AND EFFECT, ANY RESULTING ADDITIONAL WARRANTY SHALL BE LIMITED IN DURATION TO THE EXPRESS WARRANTIES AND BE OTHERWISE SUBJECT TO AND LIMITED BY THE TERMS OF BURKE'S PRODUCT WARRANTY. SOME STATES DO NOT ALLOW THE EXCLUSION OF CERTAIN IMPLIED WARRANTIES, SO THE ABOVE LIMITATION MAY NOT APPLY TO YOU.**

**Warranty Exclusions:** The above stated warranties do not cover: "cosmetic" defects, such as scratches, dents, marring, or fading; damage due to incorrect installation, vandalism, misuse, accident, wear and tear from normal use, exposure to extreme weather; immersion in salt or chlorine water, unauthorized repair or modification, abnormal use, lack of maintenance, or other cause not within Burke's control; and

**Limitation of Remedies:** Burke is not liable for consequential or incidental damages, including but not limited to labor costs or lost profits resulting from the use of or inability to use the products or from the products being incorporated in or becoming a component of any other product. If, after a reasonable number of repeated efforts, Burke is unable to repair or replace a defective or nonconforming product, Burke shall have the option to accept return of the product, or part thereof, if such does not substantially impair its value, and return the purchase price as the buyer's entire and exclusive remedy. Without limiting the generality of the foregoing, Burke will not be responsible for labor costs involved in the removal of products or the installation of replacement products. Some states do not allow the exclusion of incidental damages, so the above exclusion may not apply to you.

The environment near a saltwater coast can be extremely corrosive. Some corrosion and/or deterioration is considered "normal wear" in this environment. Product installed within 500 yards of a saltwater shoreline will only be covered for half the period of the standard product warranty, up to a maximum of five years, for defects caused by corrosion. Products installed in direct contact with saltwater or that are subjected to salt spray are not covered by the standard warranty for any defects caused by corrosion.

Contact your local Burke Representative for warranty information regarding Burke Turf® and Burke Tile products.

## Terms of Sale

**Pricing:** Prices published in this catalog are in USD, are approximate and do not include shipping & handling, surfacing, installation nor applicable taxes. All prices are subject to change without notice. Contact your Burke representative for current pricing. Payments are to be made in USD.

**Weights:** Weights are approximate and may vary with actual orders.

**Installation:** All equipment is shipped unassembled. For a list of factory-certified installers in your area, please contact your Burke representative.

**Specifications:** Product specifications in this catalog were correct at the time of publication. However, product improvements are ongoing at Burke, and we reserve the right to change or discontinue specifications without notice.

**Loss or Damage in Transit:** A signed bill of lading is our receipt from a carrier that our shipment to you was complete and in good condition upon arrival. Before you sign, please check the Bill of Lading carefully when the shipment arrives to make sure nothing is missing and there are no damages. Once the shipment leaves our plant, we are no longer responsible for any damage, loss or shortage.

For more information regarding the warranty, call Customer Service at 920-921-9220 or 1-800-356-2070.

01/2024

# QUOTATION



## Creative Sites, LLC

11506 Pierce Street  
Omaha, NE 68144  
402-614-4606

Date: June 3rd, 2024

Customer: DC West Elementary  
Attn: Melissa Poloncic  
400 S Center St.  
Valley, NE 68064

Project: Playground Improvements

**BCI Burke Company**

NUIN Play Structure	\$127,738
Freight	\$7,250
Ecoturf Poured Rubber Surface 3350 sf	\$60,300
Installation	<u>\$66,225</u>
Total	\$261,513

- \*\*Delivery is 10 weeks ARO.
- \*\*This quotation is good for 90 days.
- \*\*Terms are net 30.
- \*\*Sales tax is not included.

---

Julie Kutilek  
Creative Sites, LLC

---

Accepted by

COLOR KEY	
●	NAVY
●	LEMON
●	AQUA
●	LIME
●	ORANGE
■	LIME/BLACK
■	ORANGE/BLACK

