

**PARKING CALCULATIONS**

PARKING REQUIREMENTS FOR SITE:  
NOTE: ALTERNATIVE PARKING PLAN RATIO APPROVED BY PLANNING DIRECTOR.  
ONE (1) PARKING SPACE PER SIX (6) SEATS.

REQUIRED PARKING COUNT FOR PROPOSED STADIUM: 6013 SEATS/6 = 1003 SPACES  
PARKING COUNT FOR NAVARRO HIGH SCHOOL: 579 SPACES (576 EXISTING, 4 REMOVED, 7 ADDED)  
TOTAL PARKING COUNT FOR ATHLETICS COMPLEX: 424 SPACES (INCLUDING 11 ADA)  
TOTAL PARKING COUNT: 579 + 424 = 1003 SPACES

**IMPERVIOUS COVERAGE**

LOT ACREAGE: 90.851 AC (3,957,470 SF)  
EXISTING IMPERVIOUS COVER FROM HIGH SCHOOL: 17.562 AC (765,000 SF)  
PROPOSED IMPERVIOUS COVER OF ATHLETICS PROJECT: 16.529 AC (720,000 SF)  
TOTAL IMPERVIOUS COVER ON SITE: 34.091 AC (1,485,000 SF)

NOTE:  
PR #11 IMPERVIOUS COVER INCREASE: 0.108 AC (4,683 SF)

**SURVEY CONTROL**

NAD83 (2011) EPOCH 2010.00  
NAVD83 GEOID 18  
GRID TO SURFACE SCALE FACTOR 1.00016

Point #	Northing	Easting	Elevation	Full Description
1	13,787,198.86	2,293,400.16	589.00	SET I.R. REDCAP (TRAV)
2	13,787,207.67	2,293,703.24	588.64	SET MAG NAIL & WASHER (TRAV)
3	13,787,212.34	2,294,004.38	588.31	SET MAG NAIL & WASHER (TRAV)
4	13,787,217.04	2,294,304.90	588.85	SET MAG NAIL & WASHER (TRAV)
6	13,787,201.65	2,295,274.34	591.03	SET MAG NAIL (TRAV)
7	13,786,316.90	2,295,254.36	591.29	SET MAG NAIL (TRAV)

**LEGEND**

- PROPERTY LINE
- LIGHT DUTY CONCRETE PAVEMENT (PARKING STALLS)
- MEDIUM DUTY CONCRETE PAVEMENT
- HEAVY DUTY CONCRETE PAVEMENT
- HEAVY DUTY CONCRETE PAVEMENT WITH THICKENED EDGE (SEE NOTES, REFER TO CIVIL SHEET C2.10 FOR CONCRETE PAVEMENT SECTION/REINFORCEMENT)
- CONCRETE FLATWORK (SEE NOTES, REFER TO CIVIL SHEET C2.10 FOR CONCRETE PAVEMENT SECTION/REINFORCEMENT)
- CONCRETE FLATWORK PADS (SEE NOTES AND C2.10)
- LIGHT DUTY CONCRETE PAVEMENT (SEE NAVARRO HIGH SCHOOL GEOTECH FOR PAVEMENT SECTION)

**ADDRESS:**  
6450 SH 123  
SEGUIN, TX 78155

**LEGAL DESCRIPTION:**  
NAVARRO HIGH SCHOOL LOT #1  
DOC # 202299014677

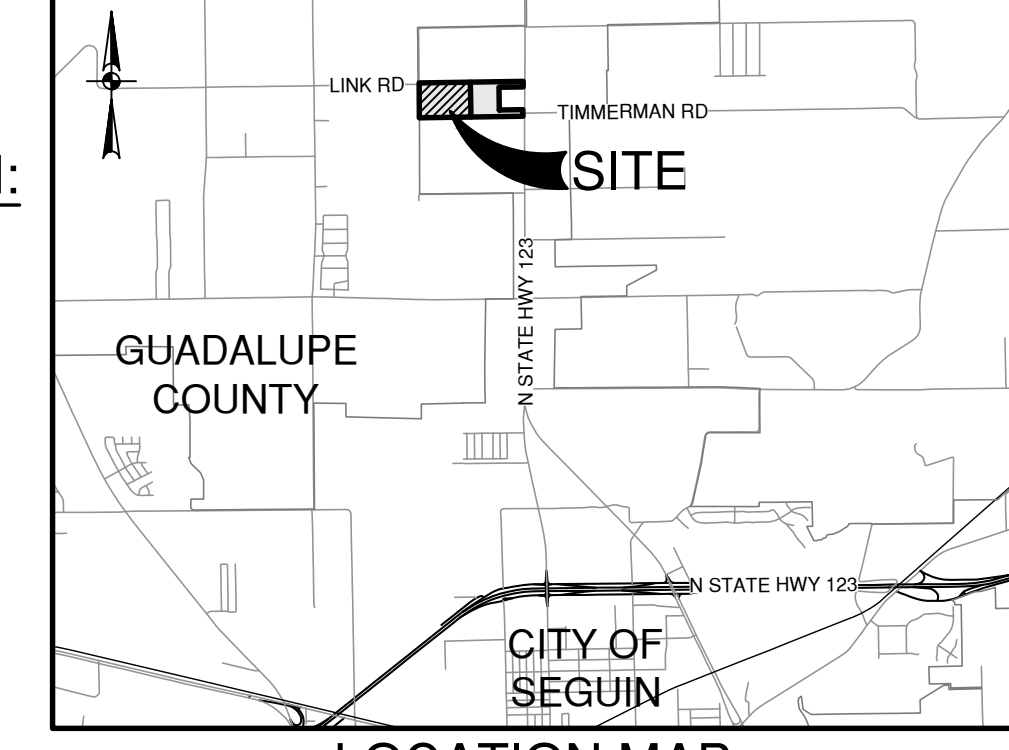

**LPA**

ARCHITECTURE ENGINEERING INTERIOR DESIGN  
LANDSCAPE ARCHITECTURE PLANNING

210-829-1737 Office

LPA Design Studios.com

1811 South Alamo Street, Suite 100  
San Antonio, Texas 78204

4/21/26

STACEY L. WEICHERT  
84036

**NOTES**

'CONCRETE PAVEMENT' DENOTED ON LANDSCAPE PLANS IS REFERRED TO AS 'CONCRETE FLATWORK' ON CIVIL PLANS AND REFERS TO PAVING IN PEDESTRIAN AREAS, FLATWORK PADS REFERS TO BLEACHER AND BATTING CAGE PADS.  
'CONCRETE PAVEMENT ON CIVIL PLANS REFERS TO PAVING IN VEHICULAR AREAS. REFER TO CIVIL SHEET C2.10 FOR FLATWORK AND PAVEMENT SECTIONS AND REINFORCING.

ALL JOINTING WITHIN FLATWORK AREAS TO BE COORDINATED WITH LANDSCAPE PLANS AND DETAILS. JOINTING WITHIN PAVING AREAS SHALL BE PER GEOTECHNICAL REPORT AND C2.10.

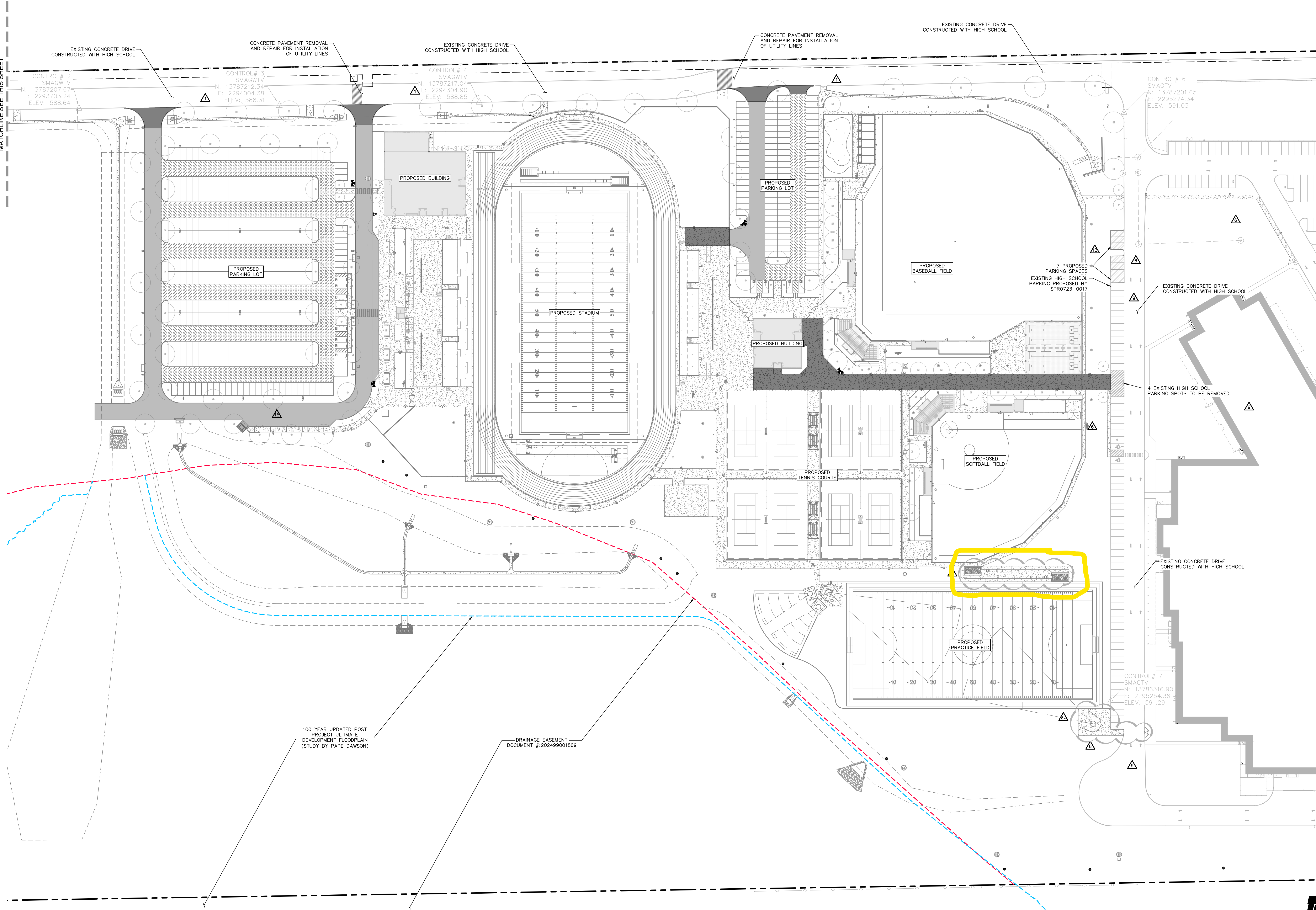

NAVARRO HS ATHLETICS COMPLEX  
SEGUIN, TEXAS  
Developed for  
NAVARRO INDEPENDENT SCHOOL DISTRICT

Revision	Date	Description
1	03/27/2025	PKG. 3 ADDENDUM 1
6	06/18/2025	PR-01 PERMIT COMMENTS
8	08/15/2025	PR-02
13	09/04/2025	PR-05
15	09/04/2025	PR-11
27	04/21/2026	

Submission	Date
PACKAGE 3	3/12/2025

Job Number	32209
Checked By	
Scale	

**PAPE-DAWSON ENGINEERS**

2000 NW LOOP 410 | SAN ANTONIO, TX 78213 | 210.375.9000  
TEXAS ENGINEERING FIRM #470 | TEXAS SURVEYING FIRM #10028800

Date: Apr 23, 2026, 10:51am User: D:\JG\ER004  
File: P:\15159\100\Design\Civil\SPD\13559000.dwg

THIS DOCUMENT HAS BEEN PRODUCED FROM MATERIAL THAT WAS STORED AND/OR TRANSMITTED ELECTRONICALLY AND MAY HAVE BEEN INADVERTENTLY ALTERED. RELY ONLY ON FINAL HARD COPY MATERIALS BEARING THE CONSULTANT'S ORIGINAL SIGNATURE AND SEAL.